

LINIA 300

GREFET



THE SCIENCE
OF SYSTEM
WINDOWS

LINIA300

includes the option of a fly
MESH SHUTTER

for enhanced functionality
and insect protection.

Available in a versatile range
of typologies, including
2, 2.5, 3, AND 3.5
SYSTEMS

to suit diverse design and
functional requirements.

Featuring a distinctive design,
LINIA300 incorporates
45-DEGREE
frame joints paired with
90-DEGREE SASH
intersections, delivering a refined
and modern aesthetic.

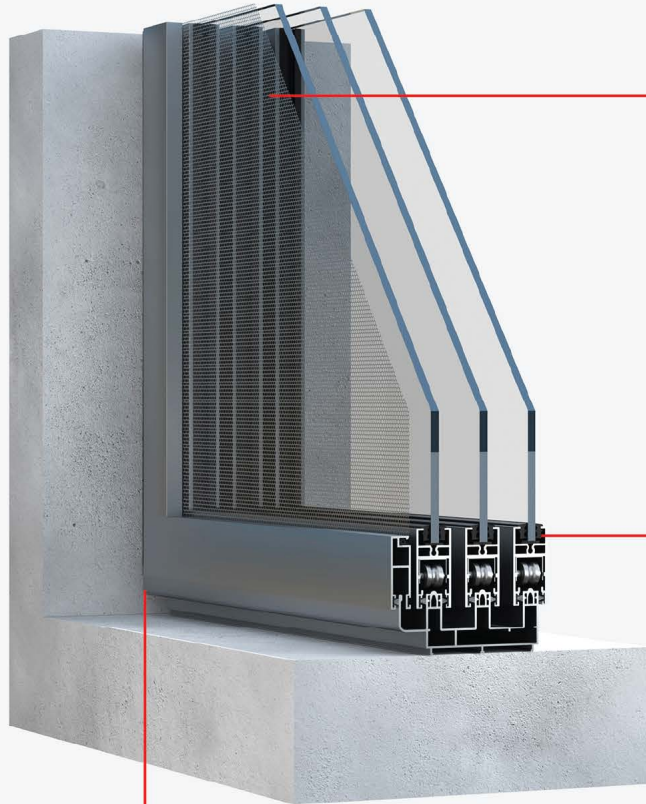

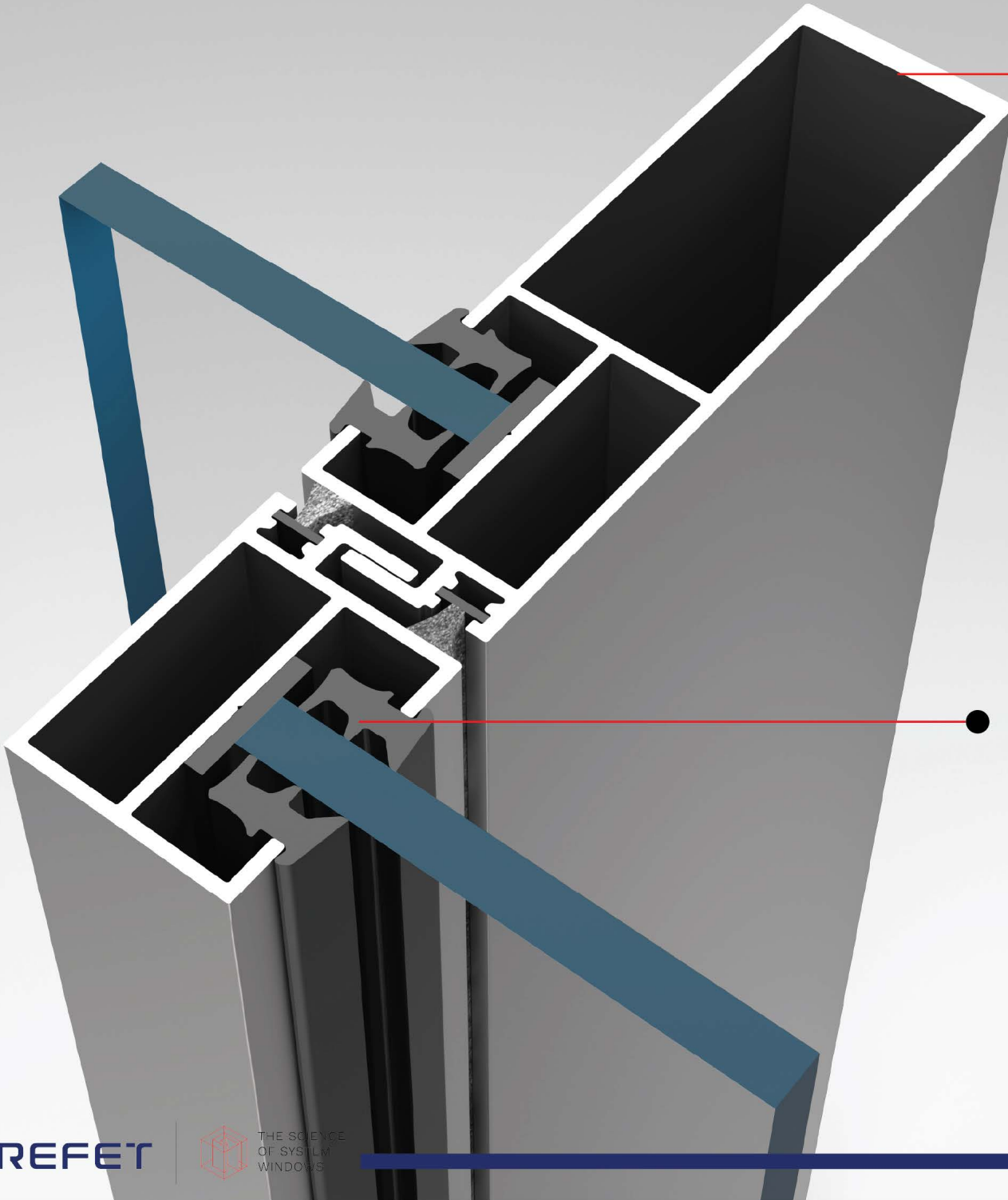

● Designed with
25MM
INTERLOCK,
ensuring a streamlined
appearance and optimal
performance.

● Crafted with
PREMIUM-
QUALITY **EPDM**
LINIA300 ensures superior sealing
and waterproofing performance
across all applications.



LINIA300 accommodates glazing thicknesses of up to

21MM,

offering flexibility for various

GLASS SPECIFICATIONS.

Offers a perfect balance of versatility and sophisticated design, making it an ideal solution for

LARGE-SCALE

PROJECTS

and developments.



FEATURES	TECHNICAL	FEATURES	TECHNICAL
Alloy grade	6063 - T6	Sash	54 mm
Glazing	21 mm glass	Maximum weight	120 Kg per leaf
Possible Typology Possibilities	2, 3, 4 & 6 sashes (+ mesh) 2 track, 2.5 track, 3 track & 3.5 track	Central interlocking	25 mm
Sections Frame	2 track 50 70 mm 3 track 87 108 mm	Permittable dimensions	1200 mm X 2500 mm per leaf (W X H)
Frame depth	40 50 mm		

PROVEN INTERNATIONAL SUCCESS

Our system has demonstrated consistent effectiveness through global testing protocols.

Transmittance	Uw from 3.0 (W/m ² k)
Maximum acoustic insulation Rw	20 dB
Air permeability	Test BS EN 1026: 2016 (Class 2)
Water tightness	Test BS EN 1027: 2016 (PA 300, Classification 4A)
Wind resistance	As per BS EN 12210 (2.4 KPA)

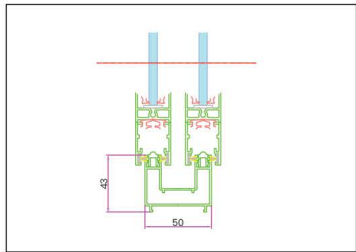

2T-Bottom Section

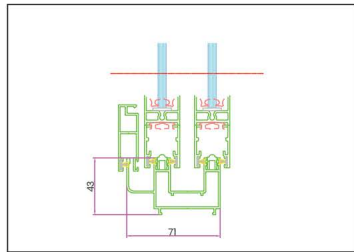

2.5T-Bottom Section

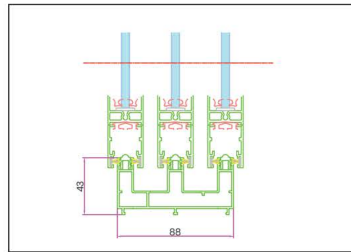

3T-Bottom Section

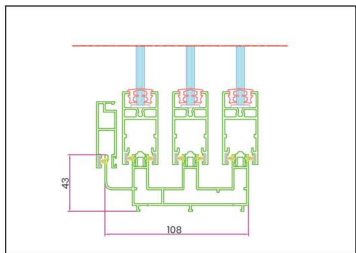

3.5T-Bottom Section

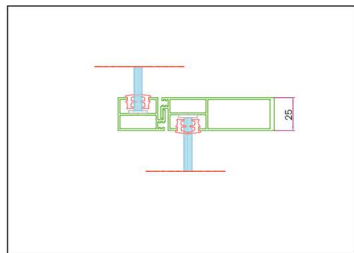

Interlock Section

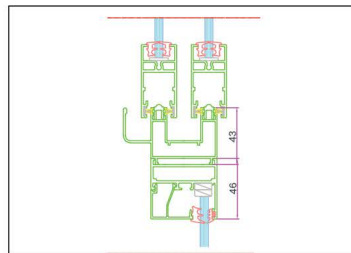

2.5T +CS50



TYOLOGY

2 TRACK



2.5, 3, 3.5 TRACK

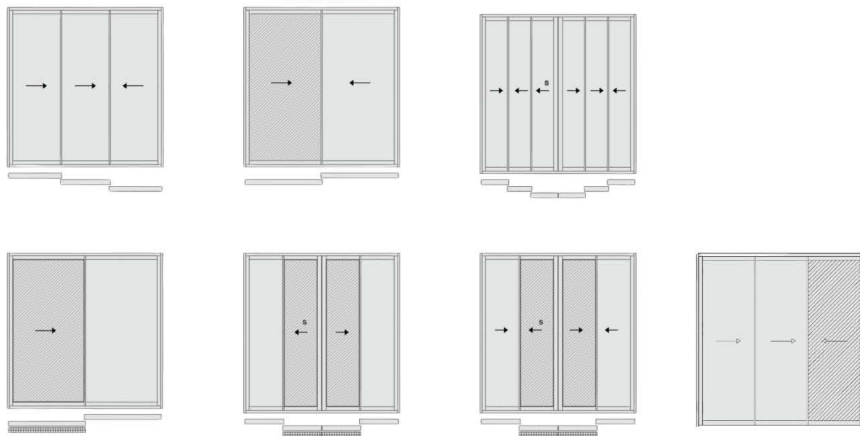

ENGINEERED
FOR
EFFICIENCY.
LARGE SCALE
IMPACT.

GRAFET SYSTEMS INDIA PVT LTD

Mumbai Office

912/46, Poisar Venus, Kandivali
East, Mumbai, Maharashtra
400101

Gurugram Office

90B, Delhi - Jaipur Expy, Udyog
Vihar, Sector 18, Gurugram, Sarhol,
Haryana 122008

 www.grefet.com

 info@grefet.com

 +91 1800 202 3778

Disclaimer : Grefet Systems India Private Limited (GSIPL) reserves the right to change without notice the specifications, design, shape, size, and any other criteria related to the systems mentioned in the brochure, and also to discontinue systems and/or replace any part or accessory of any system. GSIPL also reserves the right to source and indent profiles, hardware, and accessories from any company if deemed fit.

 @grefetsystems

 @grefetinternational

 @GrefetSystems

 @GrefetInternational