

GREFET

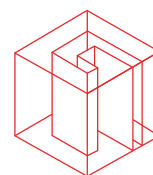

THE SCIENCE
OF SYSTEM
WINDOWS

Where science becomes a



A system window is not just aluminium and glass. It is science at work.

Every profile is engineered to control heat.

Every seal is designed to block noise.

Every joint is tested against wind, water, and time.

Thermal insulation is

calculated.

Acoustic comfort is

measured.

Structural strength is

proven.

This is not decoration.

This is performance-

designed, tested, perfected.

Because when science

leads the design, comfort

follows naturally.

That's what a true system

window is.

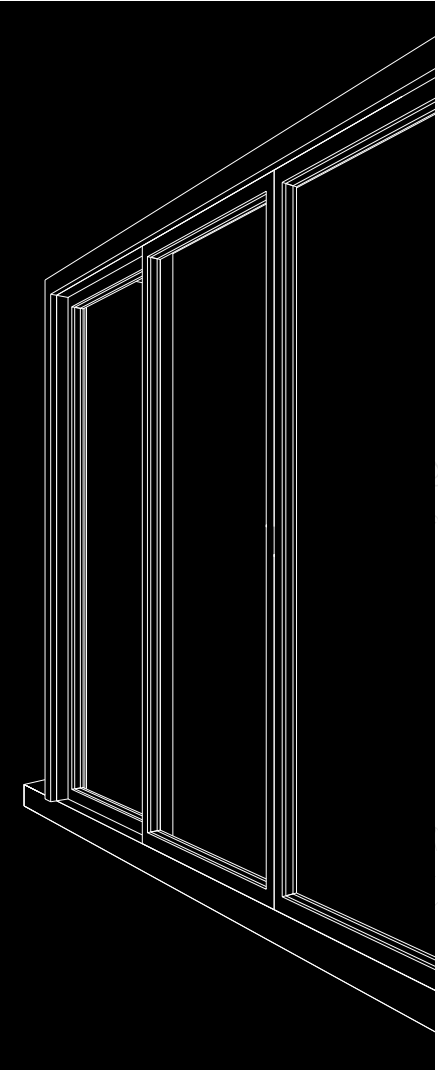

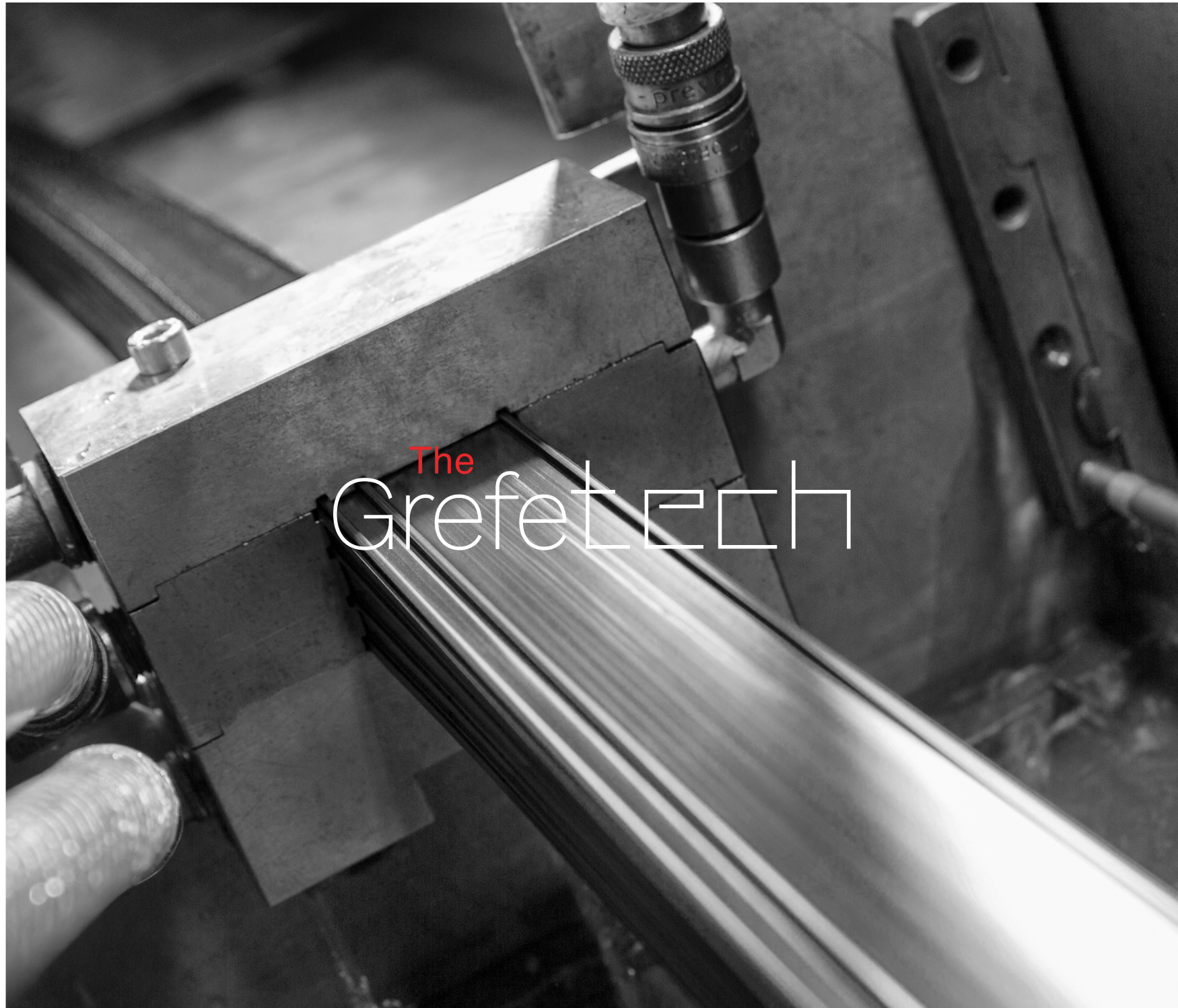

The Grefetech

Technology rarely announces itself.

It works quietly - inside the things we rely on every day.

In architecture, the most powerful technology is the kind you don't see. But you feel it in the way spaces open, close, protect, and connect.

At GREFET, system doors and windows are built on that idea.

**Every profile.
Every movement.
Every seal.**

Designed with Belgian technology that refines how a space performs.

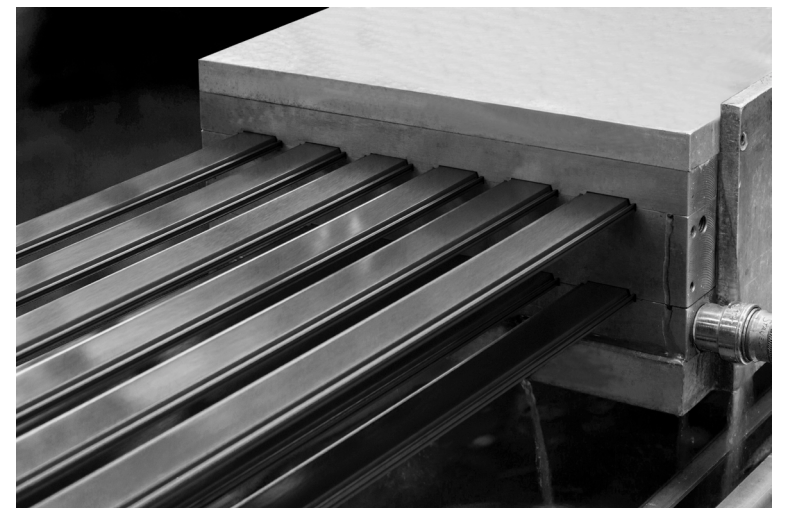

Movement that feels balanced. Structures that remain stable. Protection that works against wind, rain, heat, and noise.

Because the true role of technology is simple - to make performance effortless. Doors that glide with precision. Windows that seal with accuracy. Systems that maintain strength without unnecessary weight.

The result is not just a door or a window.

It is a system engineered to work in

harmony

with architecture.

Reliable. Efficient. Consistent.

This is the Belgian technology behind
GREFET system doors and windows.



Endurance Tech



Engineered systems designed for long-term performance, capable of sustaining over 40K opening and closing cycles, with durability engineered to extend up to one million cycles.

Acoustic Shield Tech



System configurations designed to reduce external sound, achieving noise reduction levels from 37 dB to 52 dB for improved interior comfort.

Weather Control Tech



Advanced sealing systems designed to resist water penetration, air leakage, and wind pressure, ensuring reliable performance across both individual units and full façade installations.

Extreme Environment Tech



Frames engineered to withstand demanding climate conditions, maintaining performance across temperature ranges from -20°C to $+80^{\circ}\text{C}$ over extended durations.

Structural Performance Tech

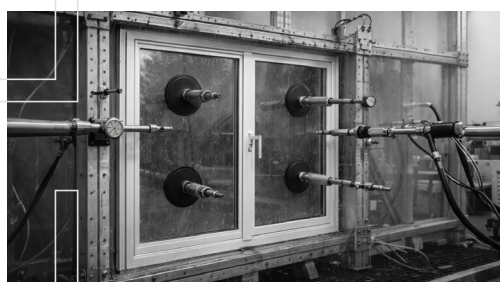

Profiles engineered for load stability, torsional resistance, and long-term alignment, ensuring smooth and consistent operation over time.

Impact Protection Tech

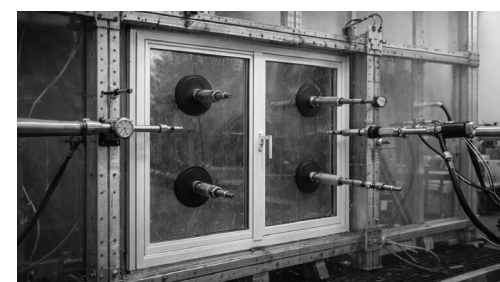

Reinforced engineering designed to enhance safety, with structures capable of withstanding impact forces from objects dropped at varying heights.

GRAFET
product
RANGE

Signature Sliders 08

. MERIDIAN47	10
. MERIDIAN32	19
. LINIA300	25

Premium Sliders 32

. SG4500	34
. EPIC19	43
. LS400	51

Signature Casements 58

CS50	59
. SINGLE DOOR	63
. FRENCH DOOR	64
. PARALLEL	65
CS40	66
CORSET37	68

Premium Casements 69

CSP100	70
. SINGLE DOOR	71
. TURN N TILT	72
. PIVOT	73
. FAN LIGHT	74

Curtain Wall 75

sliders

signature sliders

meridian47



meridian32



Linia300

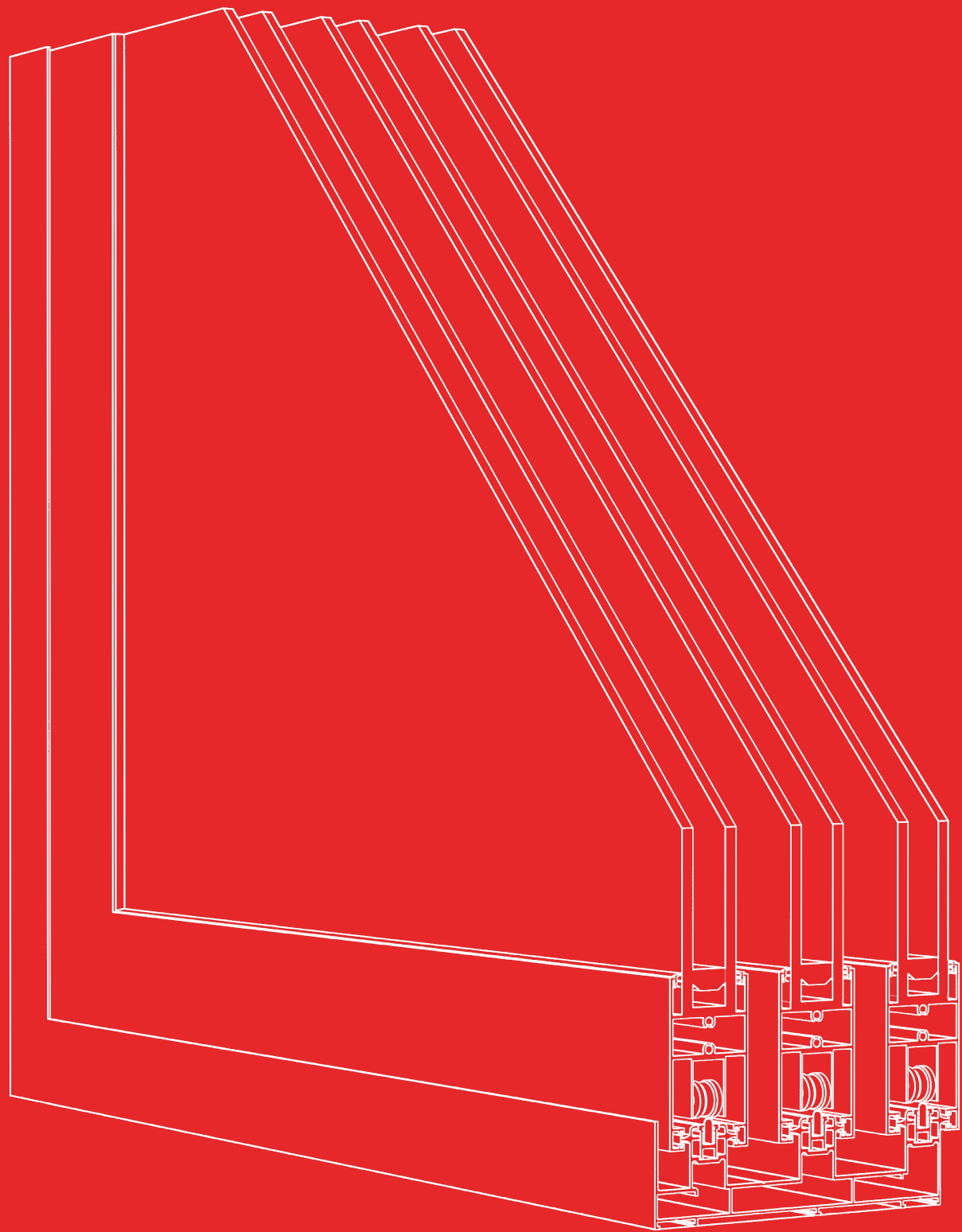

signature sliders

meridian47

Minimal sightline.

maximum

VIEW.

—



Meridian 47 by Grefet is a modern aluminium sliding system crafted for clean, uninterrupted design. Its partially concealed frame delivers a seamless look without compromising strength or ease of operation.

Engineered for expansive openings, it supports panels up to 250 kg per leaf and impressive heights - opening spaces to wider, clearer outdoor views. A slim yet strong interlock maximizes glass area, bringing in more natural light while enhancing visual clarity. Built with high-grade alloy, multi-point locking, and flexible track configurations, Meridian 47 combines performance with refined architectural appeal.





Where walls
disappear,
and views begin



MERIDIAN47

PARTIAL CONCEALED SYSTEM



Meridian 47 supports versatile configurations-including monorail, 2-track, and 3-track layouts - offering flexible design possibilities for every space. Engineered for large glass panels, it ensures smooth, effortless sliding with a clean, minimal aesthetic.

technicals

OPENING POSSIBILITIES

- Monorail
- 2 Track
- 3 Track

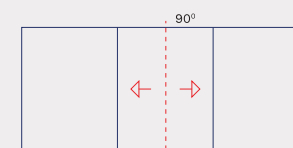
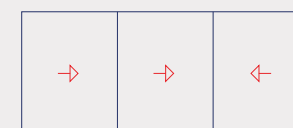
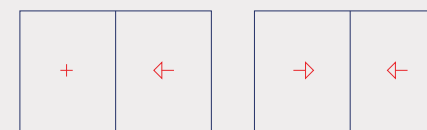

TESTING DETAILS

WIND RESISTANCE

As per BS EN 12211 (Class C5)

AIR PERMEABILITY TEST

BS EN 1026:2016 (Class4)

WATER TIGHTNESS TEST

BS EN 1027:2016 (PA 300, Classification 5A)

MAXIMUM DIMENSIONS PER LEAF | SASH

Width 1525
Height 3350

Consult maximum weight and dimensions according to typologies

MAXIMUM WEIGHT PER LEAF | SASH

250 Kg

SECTION DETAILS

SIGHTLINES

Frame 48
Sash 70 | 78
Interlock 30
Monorail 97
2 Track 101
3 Track 162

*Consult interlock options as per design calculations

MAXIMUM ACOUSTIC INSULATION RW

40 dB

GLAZING

Minimum 6
Maximum 32

TRANSMITTANCE

Uw from 3.2 (W/m²k)

Consult typologies, dimensions, and glass

EXTRUSION ALLOY

6036-T6

FINISHES | COATINGS

RAL powder coating

Anodized

Wooden finish

Consult fabrication partners for ideal options

PROFILE THICKNESS

Minimum 1.5
Maximum 10

*All dimensions are in mm



Slim interlock.
Less frame.
Limitless view.



REINFORCED INTERLOCK

Meridian 47 features a slim interlock that maximizes glass and minimizes visual barriers - delivering wide, uninterrupted views with a clean, refined aesthetic.

Available in a 3-track (3T) configuration, it is engineered for flexibility in large, multifunctional openings. The system supports up to six panels, ensuring smooth movement, structural stability, and seamless design across wide spans.

The 3T frame also accommodates a glass + mesh combination-typically two glass panels with an integrated mesh-allowing natural ventilation while keeping insects out, without disrupting visual continuity.

From expansive openings to everyday functionality, Meridian 47 gives architects and designers the freedom to create spaces that balance luxury, comfort, and performance.

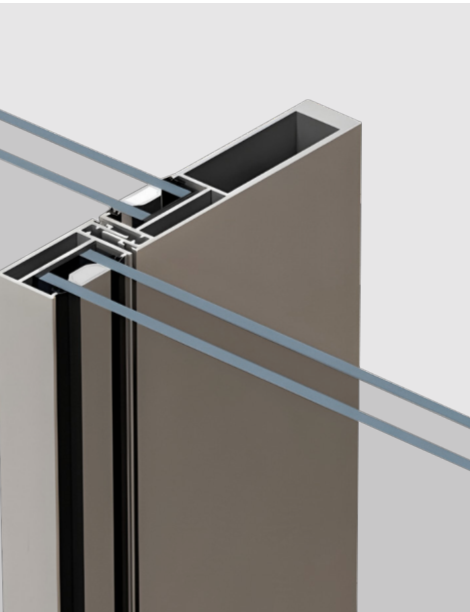

MONARAIL · 2 TRACK · 3 TRACK.

2 TRACK 2 PANEL

Meridian 47 features a 30 mm sleek central interlock, delivering a minimal visible profile without compromising strength or weather performance. The reinforced interlock is engineered to withstand wind loads up to ~3.2 kPa, ensuring stability and rigidity across large openings.

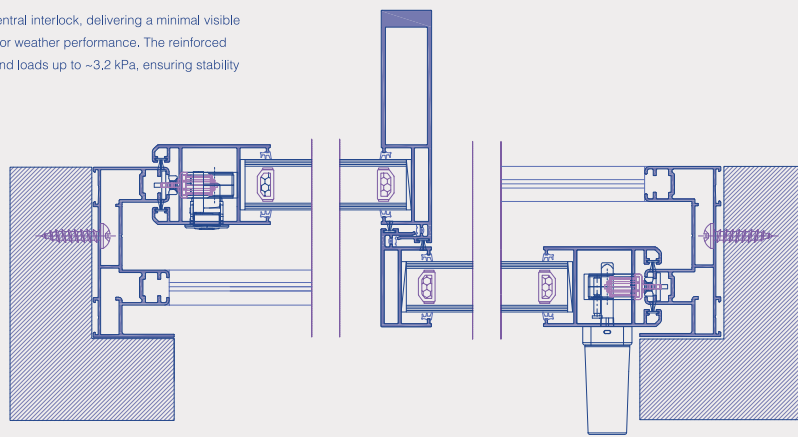

CORNER OPENING

Meridian 47 enables true post-free 90° corner openings, allowing panels to slide away seamlessly without visual obstruction. This creates open-plan spaces, panoramic views, and fluid indoor-outdoor transitions.

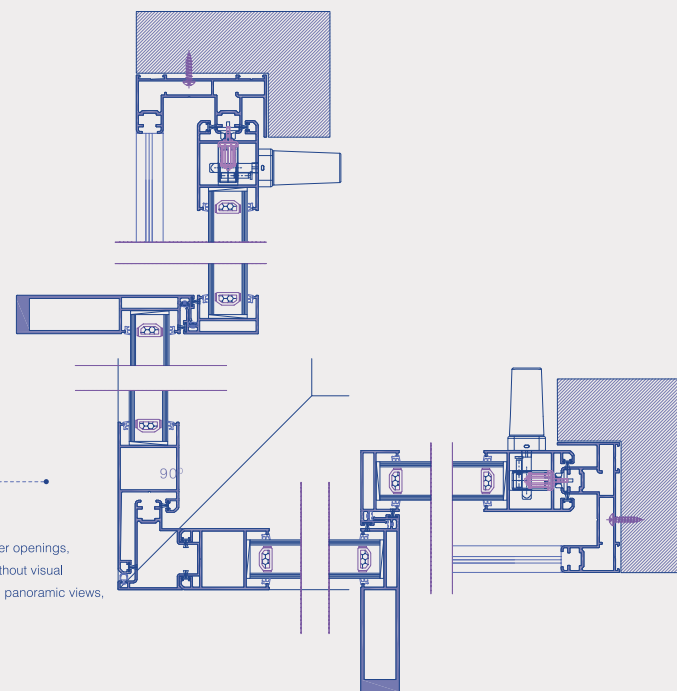

1 MIND · EXCELLENCE.

3 TRACK 3 PANNEL

The 3-track (3T) configuration is designed for maximum flexibility in wide openings, accommodating multiple panel combinations with smooth, effortless sliding. It enables larger spans while maintaining structural stability, clean sightlines, and design continuity.

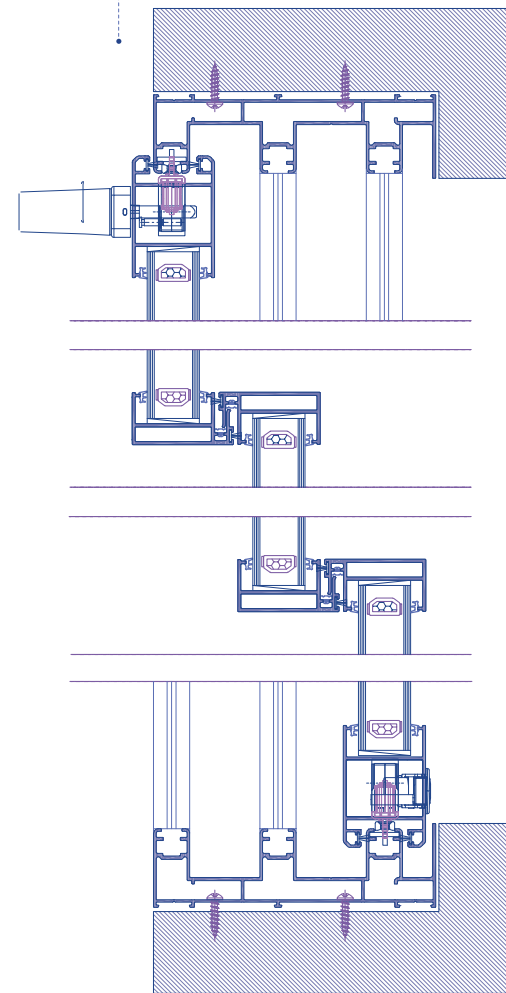

CENTRE OPENING

The centre opening system accommodates up to 4 panels on a 2-track (2T) frame and up to 6 panels on a 3-track (3T) frame—ideal for extra-wide residential and commercial openings.

Perfect for living areas, balconies, and transition spaces, it enhances openness, airflow, and uninterrupted views. Even with larger panel configurations, Meridian 47 maintains smooth operation, structural integrity, and sleek sightlines.

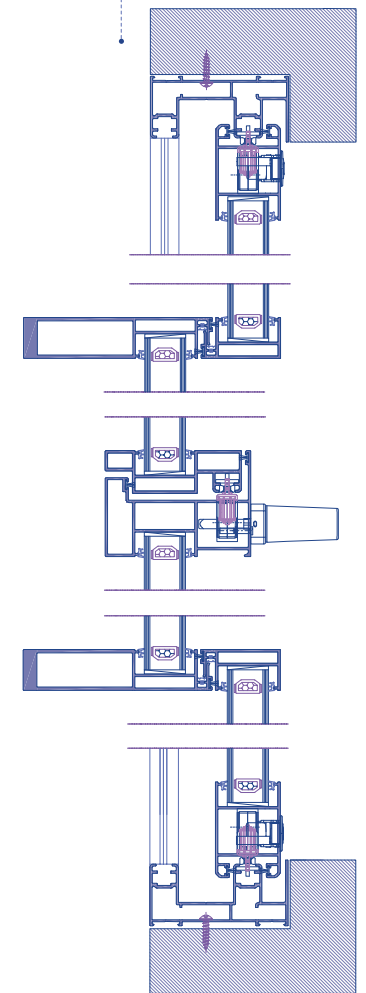

MONORAIL SYSTEM

The monorail system is a single-track configuration with one sliding and one fixed panel-ideal for large-scale, repetitive applications.

Its simplified design reduces material usage, hardware, and fabrication complexity, making it a cost-efficient solution. At the same time, it enhances manufacturing and installation efficiency while maintaining structural stability and smooth performance, perfect for high-volume residential and commercial developments.

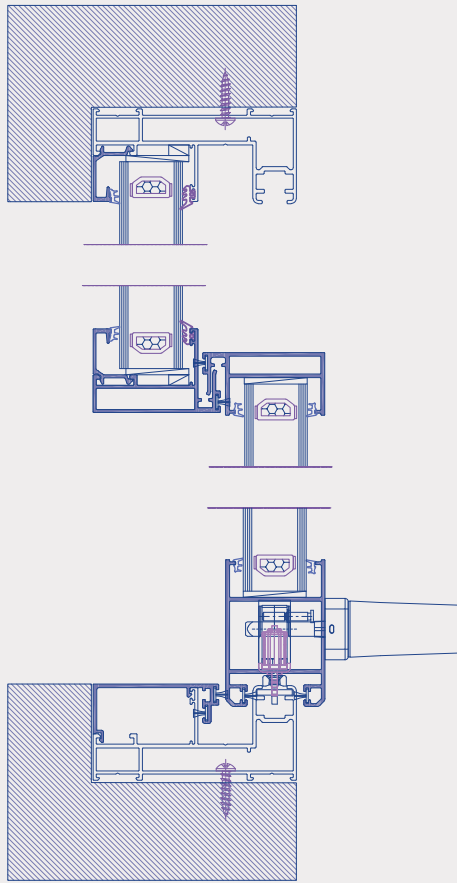

2 TRACK 2 PANEL VERTICAL

Meridian 47 combines a partially concealed internal profile for clean, minimalist interiors with robust engineering for modern spaces.

It features high-quality stainless steel (SS) rails and premium rollers built to EN 13126 standards, ensuring smooth, durable operation under daily use. The system supports large panels up to ~250 kg per sash, delivering effortless glide, stability, and maximum daylight.

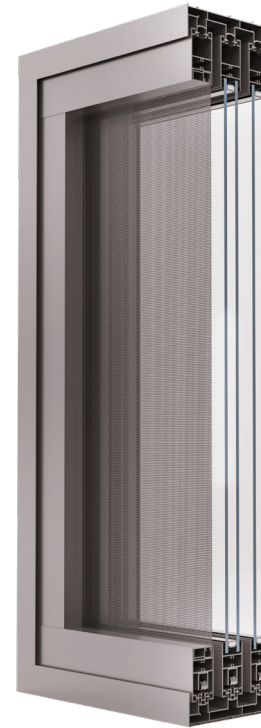
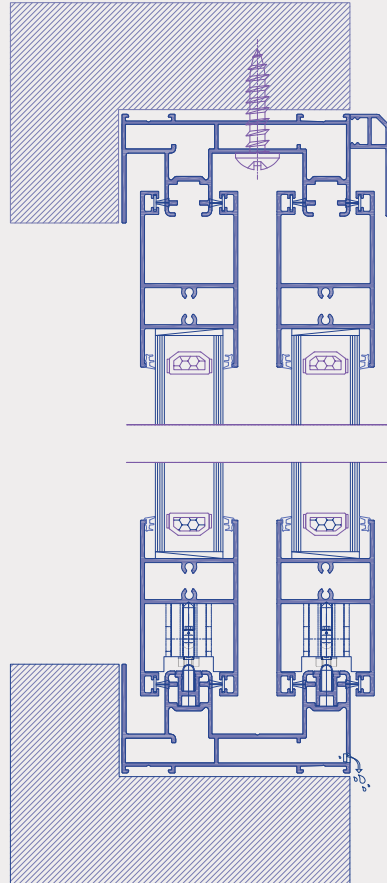

EFFICIENCY, PERFECTED.

Supports glazing up to 32 mm, compatible with double-glazed units (DGU) and laminated/security glass-deal for large-format applications requiring enhanced thermal, acoustic, and safety performance.

Engineered for heavy panels, it features stainless steel (SS) rail tracks for corrosion resistance, dimensional stability, and consistently smooth operation. Heavy-duty SS rollers provide high load-bearing capacity, ensuring effortless movement and long-term reliability.

Integrated high-efficiency drainage channels enable effective water management and controlled discharge across varying climatic conditions. Designed for wide-span residential and commercial openings that demand high-performance glazing and durable sliding systems.



Let the
VIEW.
live with you.

A home that opens without boundaries.
Where glass stretches wide, frames fade away,
and spaces flow effortlessly into one another.

Meridian 47 is designed for this experience -
expansive openings, smooth, silent movement,
and strength that stays unseen. Every detail
works quietly in the background, so the
architecture, the light, and the view take center
stage. This isn't just a sliding system. It's how a
home breathes, connects, and comes alive.

CENTRAL INTERLOCKING OPTIONS

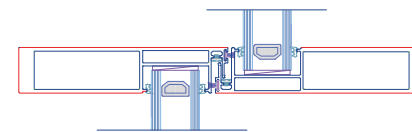
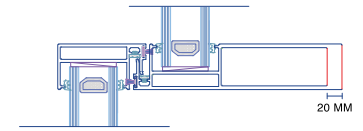
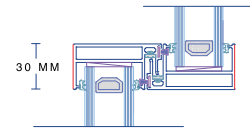

Double reinforced interlock for higher structural load

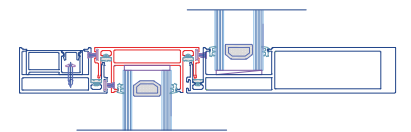

Double-sided interlocking for maximum insulation



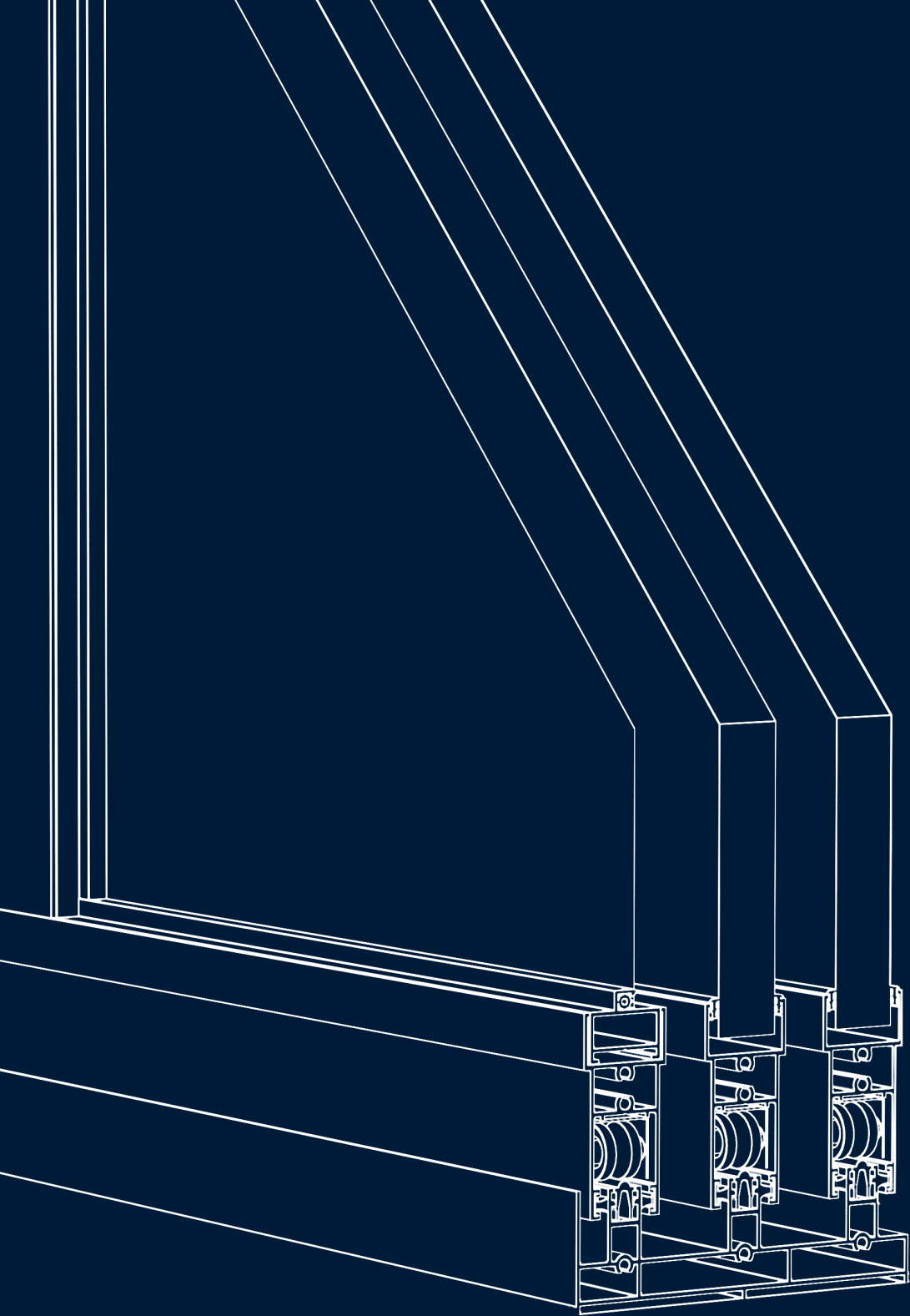

signature sliders

meridian32

Built slim.

Built

STRONG.

-



HERE SPACE IS SOUL

Meridian 32 is a premium aluminium window and door system designed to deliver sleek aesthetics with dependable structural performance. Engineered for contemporary architecture - from modern residences to multi-storey developments - it features slim sightlines, optimized profiles, and robust construction. Every element enhances visual openness while ensuring strength, stability, and long-term durability.

Meridian 32 brings together clean design and engineering precision- creating spaces that are as refined as they are resilient.



Light enters
differently here.
Spaces feel calmer,
more open, more
connected.



MERIDIAN32



WHERE SLIM MEETS STRENGTH.

The system features a 32 mm sash depth, delivering a minimal visual profile that maximizes glass while maintaining slim, refined frames. Crafted from proprietary aluminium alloy grade 6063-T6, it offers exceptional rigidity while remaining lightweight - ensuring strength, durability, and ease of operation.



technicals

OPENING POSSIBILITIES

- 2 Track
- 3 Track

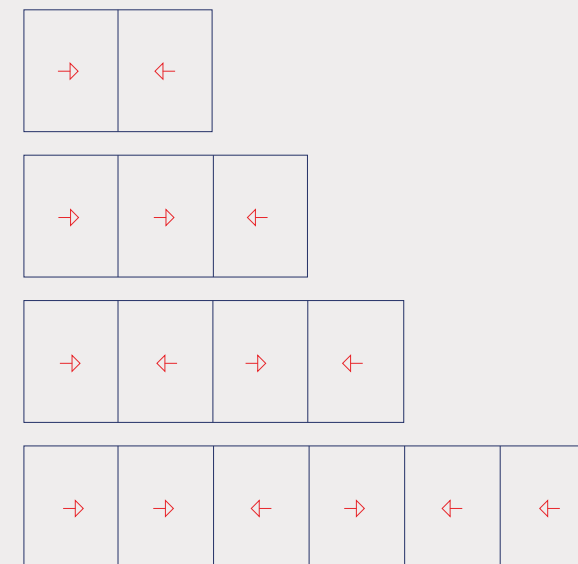

TESTING DETAILS

WIND RESISTANCE

Test BS EN 12211:2016 (2,5 kPa, Class BE₂₅₀₀)

AIR PERMEABILITY TEST

Test BS EN 1026:2016 (PA 600, Class 4)

WATER TIGHTNESS TEST

Test BS EN 1027:2016 (PA 600, Class 5A)

Test verified by Eminent International Testing Center

MAXIMUM DIMENSIONS PER LEAF | SASH

Width 1220 mm

Height 2700 mm

Consult maximum weight and dimensions according to typologies

MAXIMUM WEIGHT PER LEAF | SASH

160 Kg

SECTION DETAILS

SIGHTLINES

Frame 30 | 40

2 Track 85

Sash 65 | 67

3 Track 132

Interlock 20

*Consult interlock options as per design calculations

MAXIMUM ACOUSTIC INSULATION RW

30 dB

GLAZING

Minimum 6

Maximum 24

TRANSMITTANCE

Uw from 3.0 (W/m²k)

Consult typologies, dimensions, and glass

EXTRUSION ALLOY

6036-T6

FINISHES | COATINGS

RAL powder coating

Anodized

Wooden finish

Consult fabrication partners for ideal options

PROFILE THICKNESS

Minimum 1,5

Maximum 5

*All dimensions are in mm

2 TRACK VERTICAL

The Grefet Meridian 32 Series is a refined sliding window system engineered for contemporary architecture - where minimal sightlines, smooth performance, and functional flexibility are essential.

Designed as a 2-track, 2-panel configuration, it combines sleek aluminium profiles with intelligent engineering to deliver a system that is visually light yet structurally dependable. It is ideal for modern residences, apartments, and mid-rise buildings seeking clean geometry and uninterrupted views.

A key design feature is its precise 90° profile architecture, creating crisp, sharp lines and maintaining slim sightlines. This enhances glass area, improves natural light penetration, and supports a minimalist façade without compromising structural integrity.

The 2-track configuration enables smooth, efficient panel movement - ideal for bedrooms, living rooms, balconies, and façade openings. It ensures quiet operation, optimized space usage, and long-term reliability.

A partially concealed-from-inside option further refines the aesthetic, reducing visible aluminium sections and creating a cleaner architectural finish - aligned with modern design preferences.

An integrated weather profile enhances protection against air, dust, and water ingress - improving indoor comfort while maintaining smooth sliding performance and a tight seal.

The system also features a dedicated cavity for larger ergonomic handles, allowing robust, premium hardware integration without disrupting the clean visual lines.

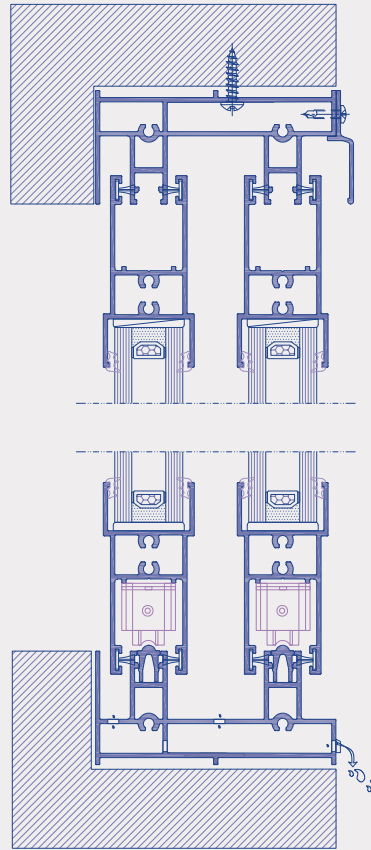

3 TRACK HORIZONTAL

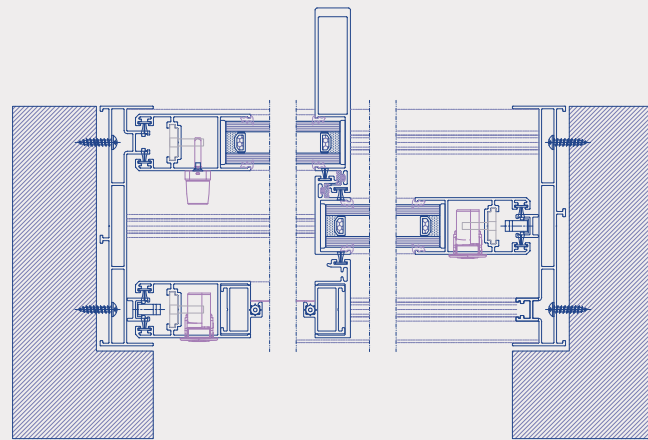

The Grefet Meridian 32 Series is also available in a 3-track configuration, designed for wider openings while maintaining the same refined design language. Ideal for larger spans in living areas, balconies, and façades, the system supports up to 6 sliding panels, enabling greater flexibility in opening size and panel movement. Each panel operates independently within its track, ensuring smooth, controlled performance while maintaining structural stability and visual consistency.

The system's slim interlock design minimizes visible aluminium at panel junctions, enhancing glass area and delivering a cleaner, more seamless façade. Meridian 32 supports multiple glazing options - from standard single glass to laminated or toughened security glass - offering flexibility across residential and performance-driven applications.

TO THE PEACE *of* THE MIND.



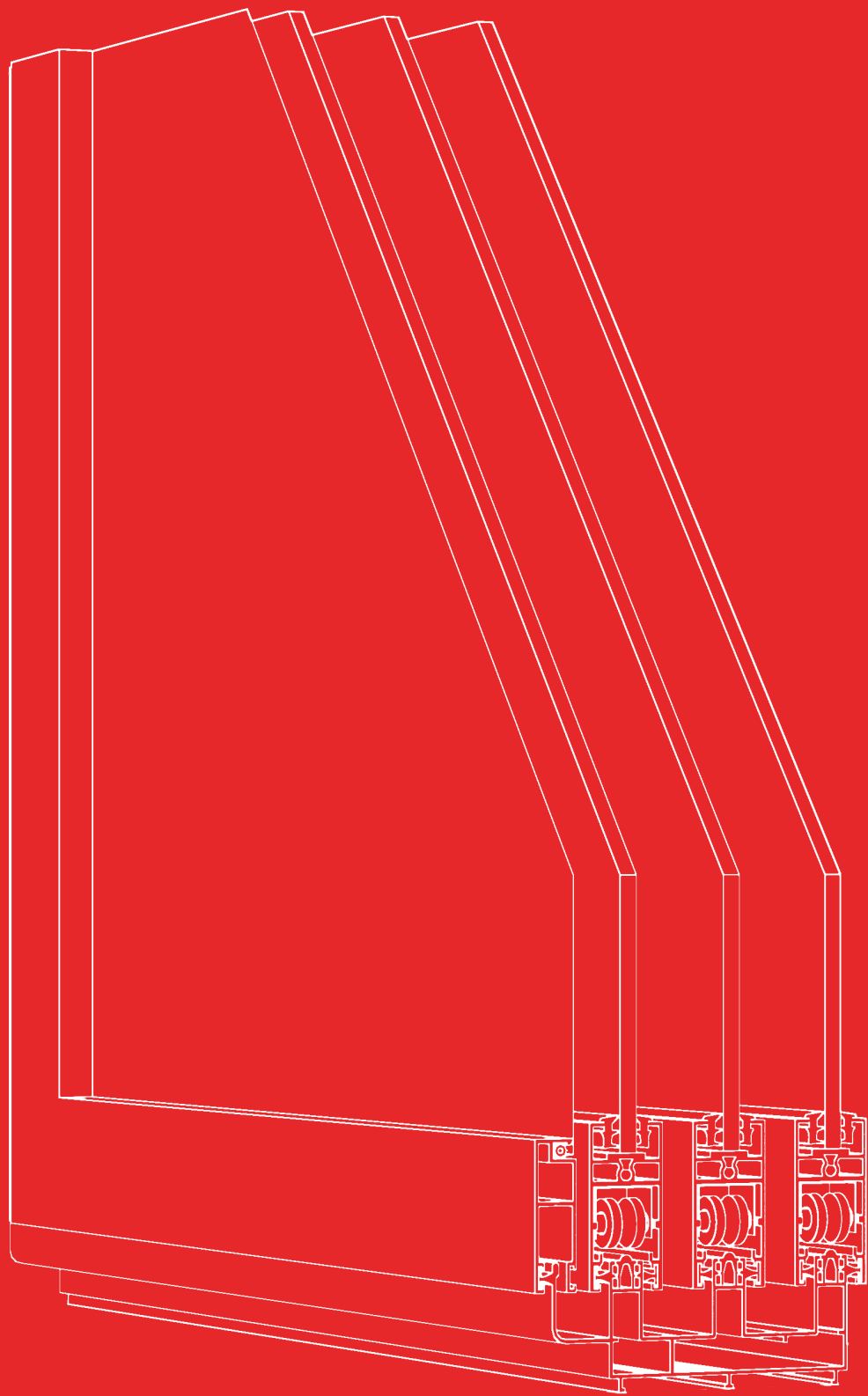

signature sliders

להחב300

Built for the
BOLDEST
openings.

—

MASS. YET CLASS.

Linia 300 by Grefet is a premium aluminium sliding system designed for modern architecture and high-performance applications.

It features sleek, robust profiles with precise 45° frame joints and reinforced interlocks - ensuring smooth operation and long-term durability. Supporting multiple track configurations and large glass panels, it is ideal for expansive façades and high-rise developments.

Crafted from high-grade 6063-T6 alloy, Linia 300 delivers structural reliability, strong wind resistance, and refined aesthetics- perfect for both residential and large-scale architectural projects.





**Designed for Scale.
Built for Everyday Ease.**

Linia300 is created to handle large openings without complexity. Its clean geometry, smooth sliding, and durable construction make it equally suited for high-rise façades and daily residential use.

It balances performance with usability - delivering effortless movement, consistent reliability, and a refined visual language that integrates seamlessly into modern architecture.



CONFIGURED *for* EVERY SPACE.

Available in a versatile range of typologies, including 2, 2.5, 3, and 3.5 systems to suit diverse design and functional requirements.

Linia300 includes the option of a fly mesh shutter for enhanced functionality and insect protection.



Featuring a distinctive design, Linia300 incorporates 45° frame joints paired with 90° SASH intersections, delivering a refined and modern aesthetic.

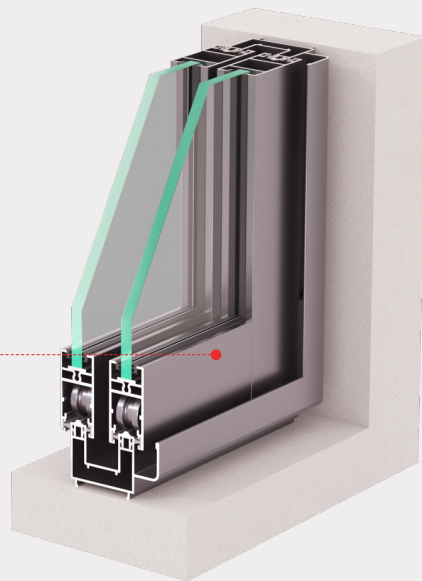

technicals

OPENING POSSIBILITIES

2 Track | 2.5 Track

3 Track | 3.5 Track



TESTING DETAILS

WIND RESISTANCE

As per BS 1026 (Class4)

AIR PERMEABILITY TEST

Test BS EN 1026:2016 (PA 600, Class 4)

WATER TIGHTNESS TEST

Test BS EN 1027:2016 (PA 300, Classification 4A)

Test verified by Eminent International Testing Center

MAXIMUM DIMENSIONS PER LEAF | SASH

Width 1200 mm

Height 2440 mm

Consult maximum weight and dimensions according to typologies

MAXIMUM WEIGHT PER LEAF | SASH

120 Kg

SECTION DETAILS

SIGHTLINES

Frame	42	2.0 Track 50
Sash	21 54	2.5 Track 70
Interlock	25	3.0 Track 87
		3.5 Track 108

*Consult interlock options as per design calculations

MAXIMUM ACOUSTIC INSULATION RW

30 dB

GLAZING

Minimum 6

Maximum 21

TRANSMITTANCE

Uw from 3.0 (W/m²k)

*Consult typologies, dimensions, and glass

EXTRUSION ALLOY

6036-T6

FINISHES | COATINGS

RAL powder coating

Anodized

Wooden finish

*Consult fabrication partners for ideal options

PROFILE THICKNESS

Minimum 1.4

Maximum 3.0

*All dimensions are in mm

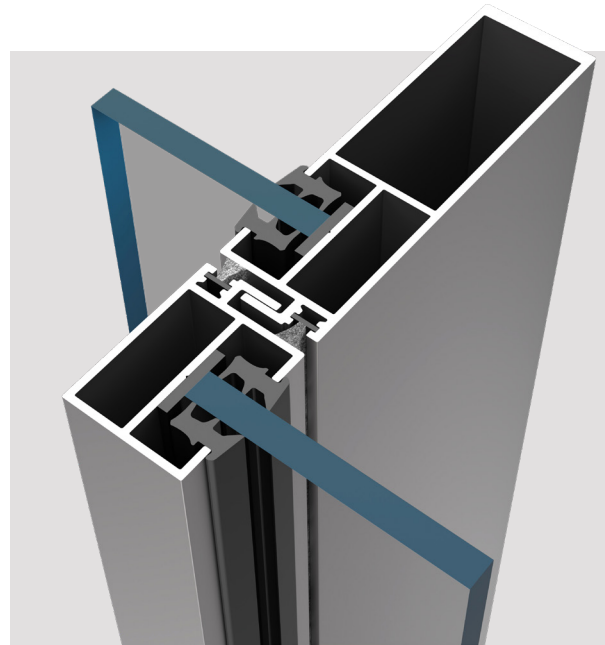

25 MM INTERLOCK

The 25 mm reinforced interlock delivers a sleek sightline without compromising structural performance. Engineered to withstand wind loads up to 2.24 kPa, it features internal reinforcement chambers that enhance stiffness and reduce deflection. The slim profile maximizes glass area - bringing in more light and wider views.

High-strength aluminium ensures optimal load distribution while maintaining smooth sliding, making it ideal for mid to high-rise applications.



Linia300-3.0 TRACK-H

Designed for large openings, the 3-track configuration enables wide spans while maintaining clean, minimal sightlines. Panels move independently, ensuring smooth operation and flexible usage. A centre-opening option supports up to 6 panels, maximizing clear opening width. Integrated mesh compatibility allows ventilation without disrupting aesthetics.

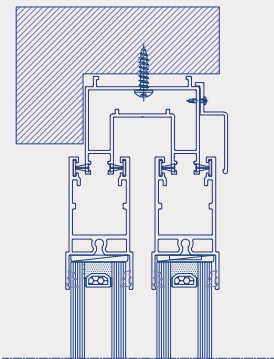
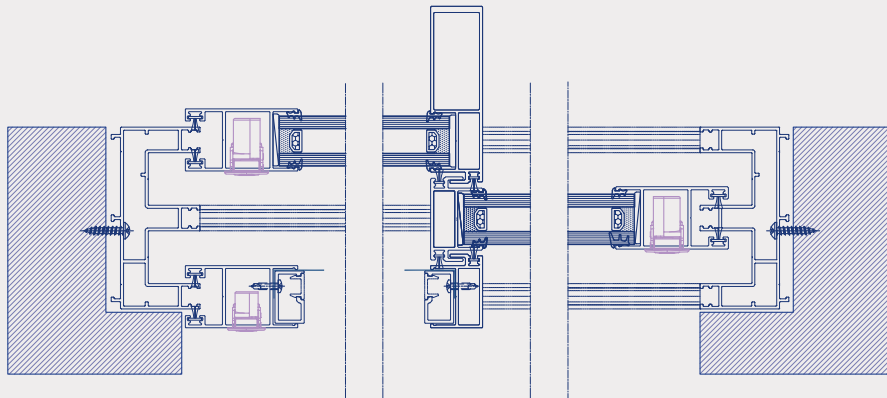

Linia300-2T-V

Engineered for high-rise developments, the 2-track system delivers efficient, reliable sliding performance with a clean architectural profile.

It supports large panels for daylight and views while ensuring durability and consistency across volume projects - making it ideal for residential towers and large-scale developments.

PLAN

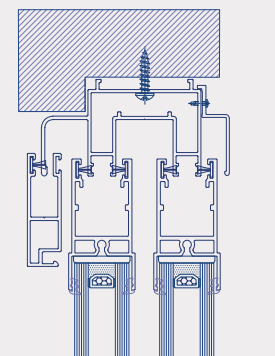

Linia300-2.5T-V

A balanced solution combining sliding panels with integrated mesh functionality.

The dedicated mesh track ensures smooth operation while maintaining a minimal profile - ideal for homes requiring ventilation, comfort, and clean design integration.

SECTION

Linia300-3.5 TRACK

Built for maximum flexibility, the 3,5-track system integrates sliding glass panels with a dedicated mesh track. It enables natural airflow while maintaining protection from insects—without external additions. Ideal for large balconies and wide openings, it combines performance, usability, and refined design.

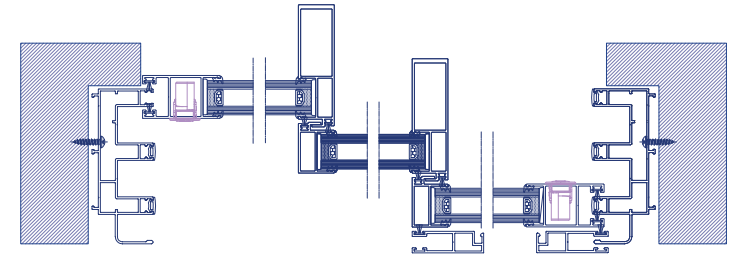

ENGINEERED FOR VERSATILITY. DESIGNED FOR LIVING.

From compact openings to expansive façades, Linia300 adapts effortlessly - delivering performance, flexibility, and refined aesthetics across every application.

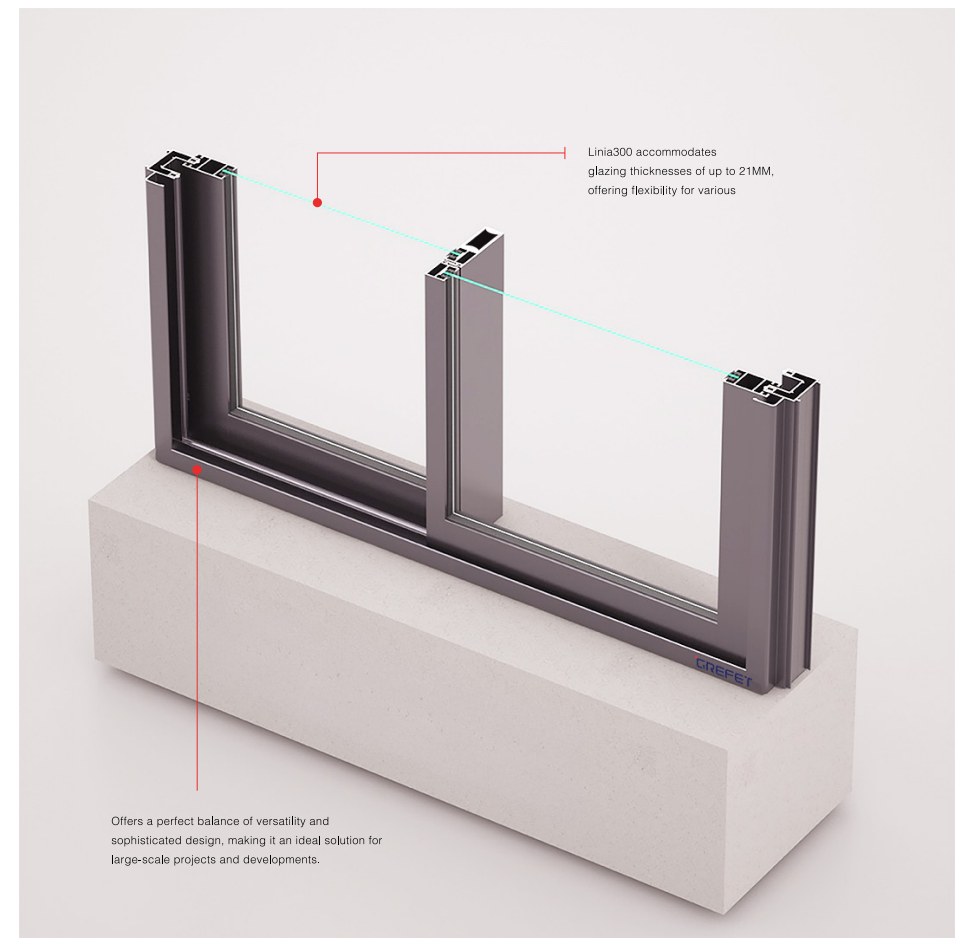

sliders

premium sliders

Engineered to open spaces beautifully.

sg4500



epic19



LS400

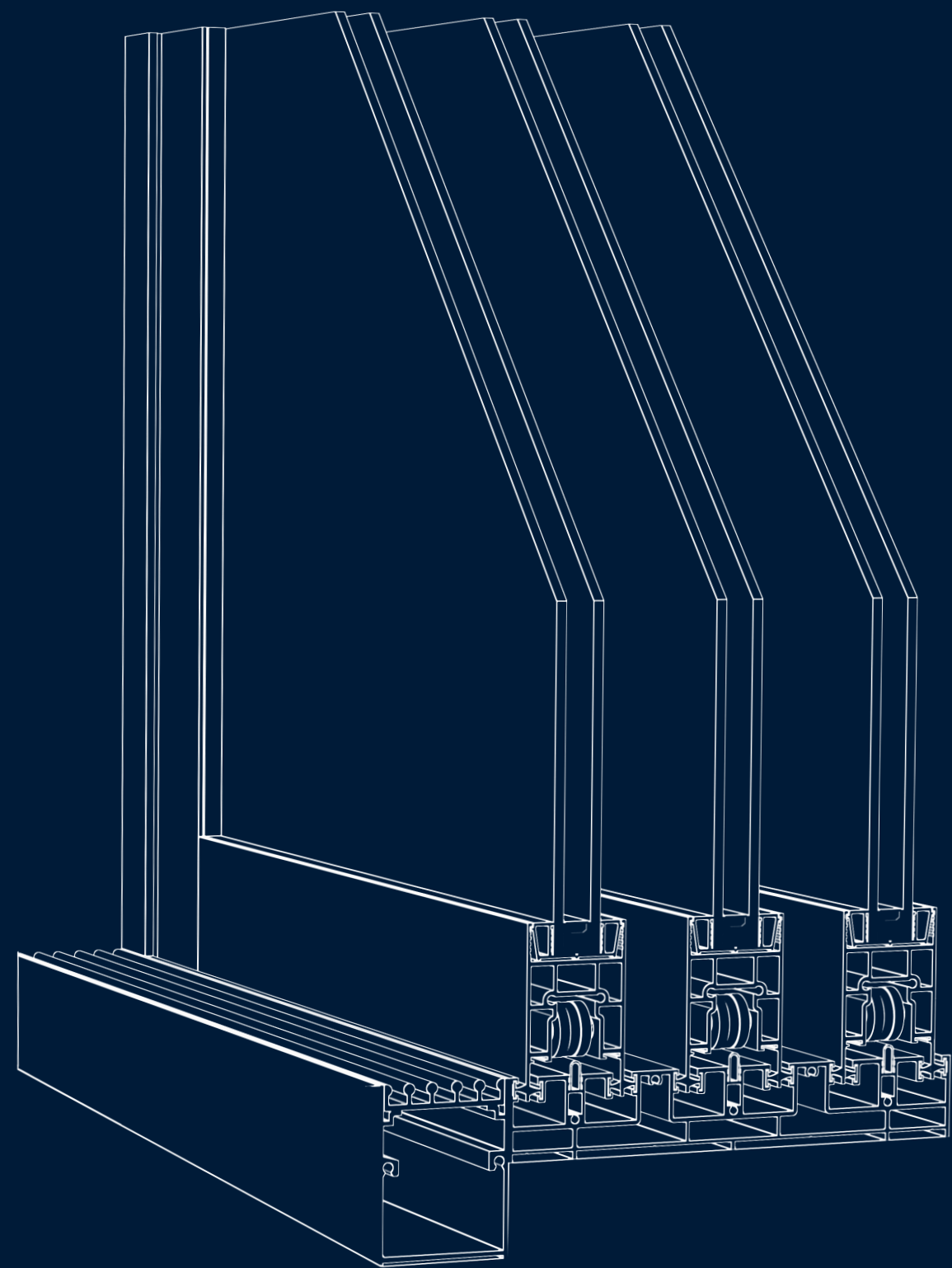

premium slider

594500

SCALE

without compromise.



THE HEIGHT OF ABSOLUTE LUXURY.

The SG4500 sliding system delivers expansive glass views with a slim 22 mm interlock and concealed unitized glazing on all four sides.

Available in 2 and 3 track configurations, it supports up to 400 kg per leaf and accommodates glazing from 12–38 mm. With a robust 65 mm sash and capability for heights up to 16 feet, it enables uninterrupted floor-to-ceiling designs with structural confidence.



Where architecture opens up.

Expansive glass. Seamless movement.

A system built to frame scale, light, and uninterrupted views.



SG1800



ENGINEERED *for* GRANDIOSE

Massive openings, refined detailing, and effortless performance - SG4500 redefines large-format sliding.

Rollers meticulously crafted from high-quality stainless steel, offer exceptional durability and performance. The stainless steel construction not only enhances their robustness but also ensures they meet the rigorous EN13126-15 standards.

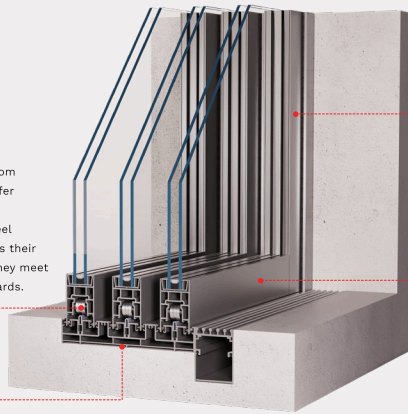

Engineered from premium-grade virgin alloy 6036-T6, renowned for its exceptional quality and performance, making it the material of choice.

A seamlessly concealed system with sleek integration, ensuring a modern aesthetic while maintaining functionality and enhancing architectural elegance.

Prismatic three-fin brushes are highly acclaimed for their exceptional precision and durability, efficiently preventing dirt, insects, and debris infiltration.

Double Glazed Unit (DGU) glass is utilized to enhance thermal insulation and energy efficiency. Its multi-layered design, featuring an insulating air or gas gap between panes, minimizes heat transfer, reducing energy consumption.

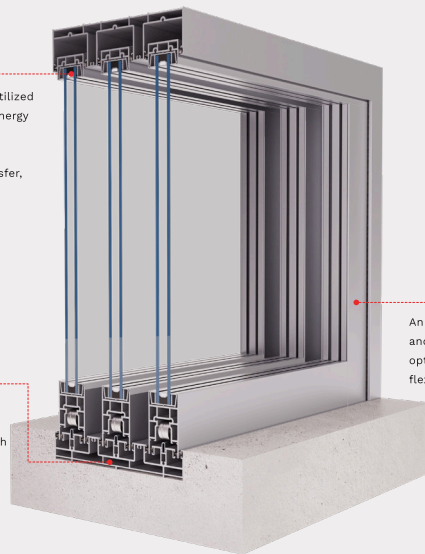

With an ultra-slim 204mm track width, this robust system maximizes space without compromising strength or performance.

An extensive range of RAL colors and customizable orientation options for tailored design flexibility.



PRECISION

meets



PANACHE.

technicals

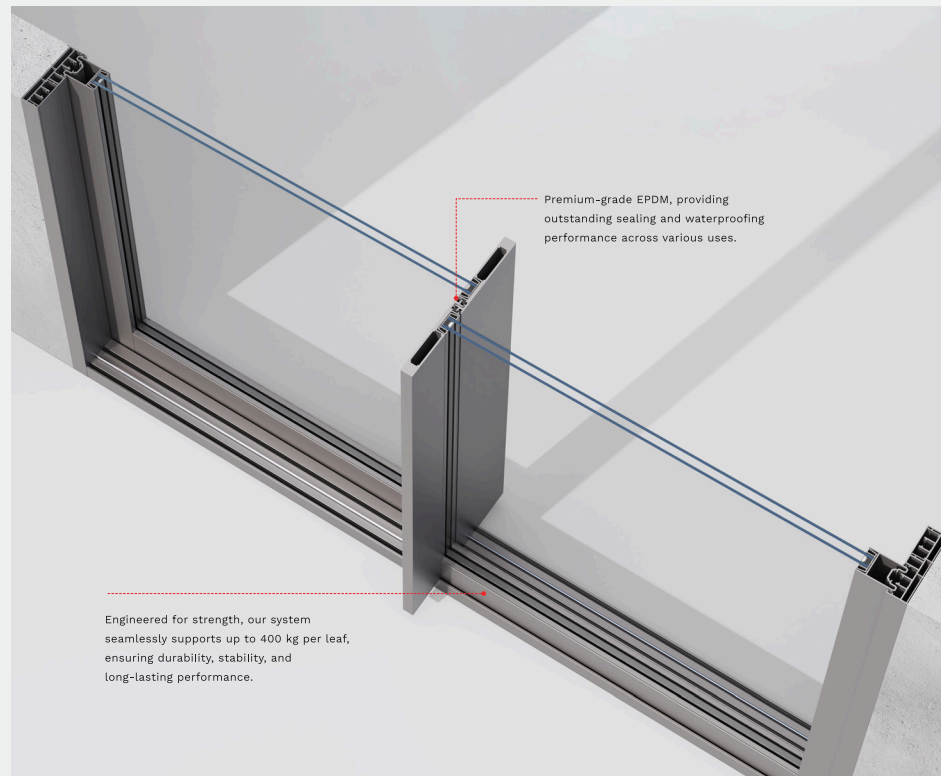
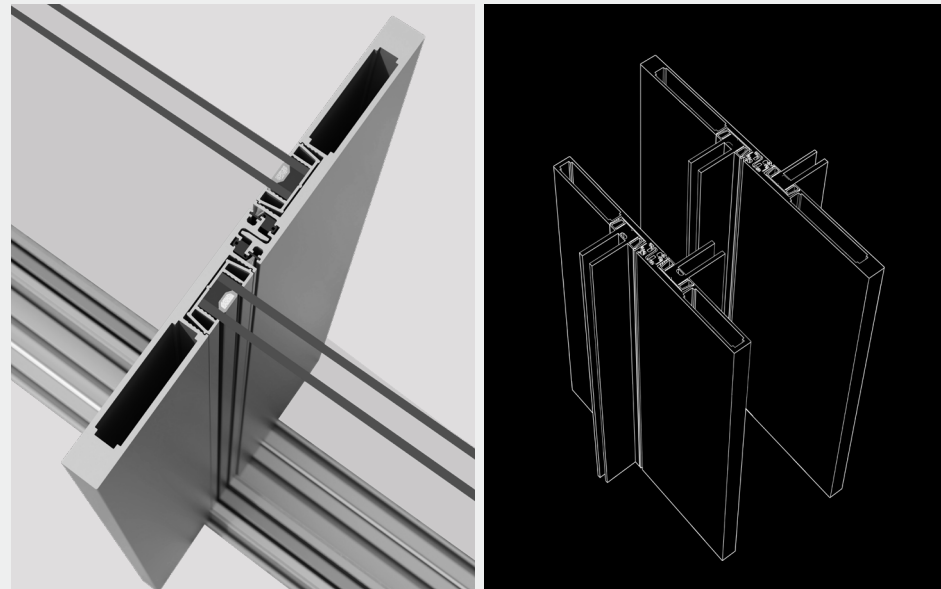

OPENING POSSIBILITIES

- 2 Track
- 3 Track

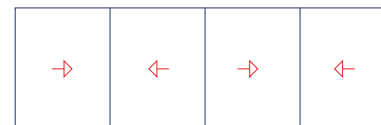
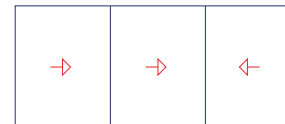
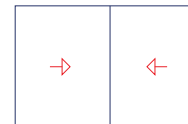

TESTING DETAILS

WIND RESISTANCE

As per BS EN 12211 (Class C5)

AIR PERMEABILITY TEST

Test BS EN 1026:2016 (Class4)

WATER TIGHTNESS TEST

Test BS EN 1027:2016 (PA 300, Classification 5A)

MAXIMUM DIMENSIONS PER LEAF | SASH

Width 1828 mm

Height 4877 mm

*Consult maximum weight and dimensions according to typologies

MAXIMUM WEIGHT PER LEAF | SASH

400 Kg

SECTION DETAILS

SIGHTLINES

Frame	35 52	2 Track	132
Sash	65 74	3 Track	204
Interlock	22		

*Consult interlock options as per design calculations

MAXIMUM ACOUSTIC INSULATION RW

40 dB

GLAZING

Minimum 12

Maximum 38

TRANSMITTANCE

Uw from 2.9 (W/m²k)

*Consult typologies, dimensions, and glass

EXTRUSION ALLOY

6036-T6

FINISHES | COATINGS

RAL powder coating

Anodized

Wooden finish

*Consult fabrication partners for ideal options

PROFILE THICKNESS

Minimum 2

Maximum 20

*All dimensions are in mm

2 TRACK 2 PANEL H

The Grefet SG4500 Series is a premium sliding door system designed to create expansive glass openings with refined minimal aesthetics. Developed for luxury residential architecture, the 2 Track – 2 Panel configuration offers smooth sliding performance while maintaining strong structural stability for large glass panels. The SG4500 system is an ideal luxury solution for villas and high-end residences, where panoramic outdoor views and maximum daylight are key design elements. The system supports double glazed units (DGU) up to 38 mm thickness, allowing enhanced thermal insulation, acoustic performance, and structural strength for large glass installations.

To complement the large panel design, the SG4500 series features a dedicated cavity for large ergonomic handles, providing comfortable operation while enhancing the premium look of the system. The combination of robust aluminium profiles, large glass capability, and elegant hardware integration makes the system well suited for sophisticated architectural spaces. With its 2 track sliding configuration, large DGU glass compatibility up to 38 mm, and premium hardware options, the Grefet SG4500 series delivers a luxurious sliding door solution ideal for modern villas and upscale residential projects.

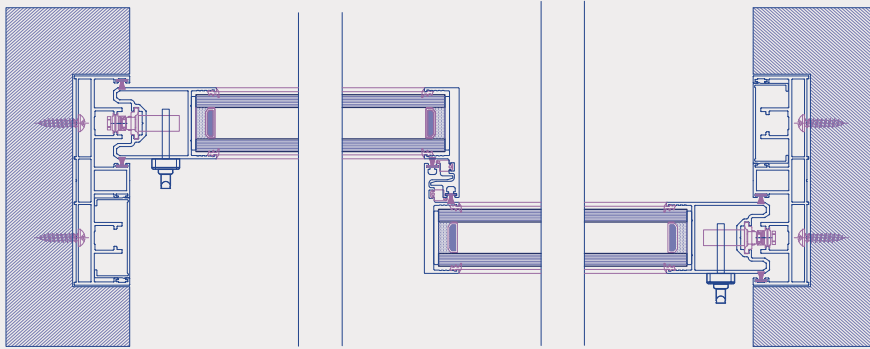

2 TRACK 2 PANEL V

The Grefet SG4500 2 Track system features a robust 132 mm wide frame, engineered to support large sliding panels while maintaining smooth and stable operation. The substantial frame depth provides enhanced structural strength, making the system ideal for installations where larger glass sizes and higher performance are required.

The 132 mm 2-track configuration is designed to accommodate 2 panel as well as 4 panel arrangements, offering flexibility for both standard and wider openings. This configuration allows efficient panel movement while maintaining a balanced and durable sliding mechanism.

The strong frame structure enables the system to handle large glass panels, making it particularly suitable for luxury residential spaces, villa openings, and large balcony doors where expansive views and natural light are essential.

With its 132 mm heavy-duty frame and flexible 2 or 4 panel configuration, the Grefet SG4500 2 Track system delivers a reliable and premium sliding door solution designed for modern architectural applications that demand strength, scale.

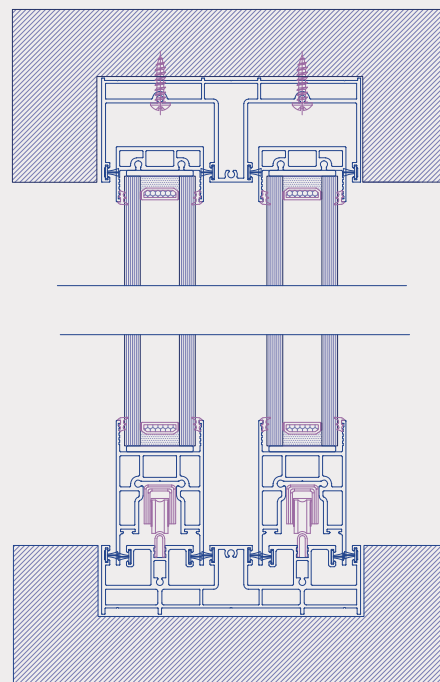

3 TRACK 3 PANEL H

The Grefet SG4500 3-Track Sliding System is engineered for expansive architectural openings where strength, scale, and luxury aesthetics are essential. Designed with a massive 204 mm wide frame, the system provides exceptional structural stability, making it ideal for large glass installations in premium residential projects. The strong frame construction supports large and heavy glass panels while maintaining smooth sliding performance. The SG4500 system combines robust engineering with refined aluminium detailing, delivering both durability and premium aesthetics.

With its 204 mm heavy-duty frame, 6 panel capability, and ability to create massive glass openings, the Grefet SG4500 3-Track system is a perfect solution for luxury villas and high-end architectural spaces where scale, elegance, and performance are equally important.

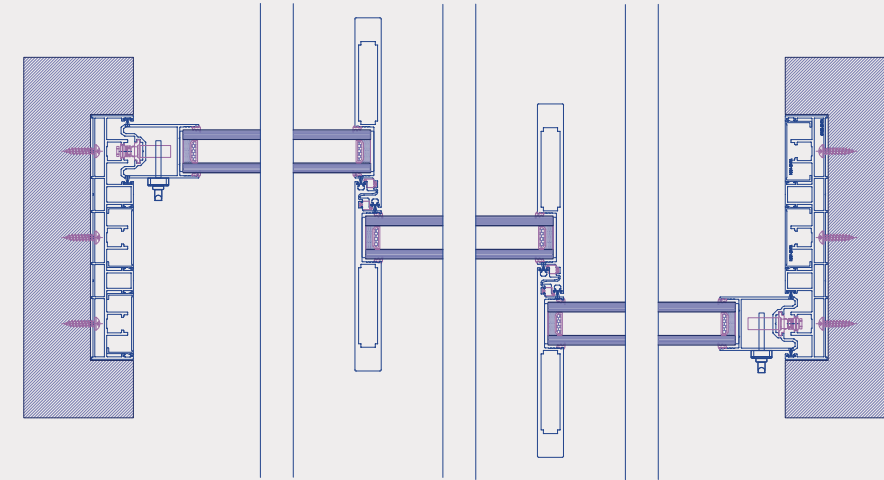

3 TRACK 4 PANEL

The Grefet SG4500 3 Track system is built around a massive 204 mm wide frame, specifically engineered to support large multi-panel sliding configurations. The robust frame structure provides exceptional strength and stability, making it ideal for installations where wide openings and large glass panels are required. The 204 mm 3-track configuration is designed to accommodate up to 6 sliding panels, allowing architects and designers to create very large uninterrupted openings. This configuration enables smooth panel stacking while maintaining balanced load distribution across the tracks, ensuring reliable and effortless operation.

The wide frame depth not only enhances structural performance but also allows the system to handle large and heavy glass panels, making it suitable for expansive living spaces, large patio openings, and modern villa architecture where seamless indoor-outdoor connectivity is desired. With its 204 mm heavy-duty frame and 6 panel sliding capability, the Grefet SG4500 3 Track system is perfectly suited for projects that demand massive openings, strong structural performance, and premium architectural presence.

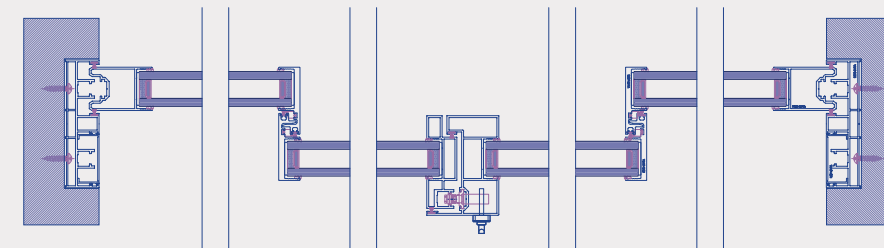

Behind every grand view
lies precise
SCIENCE.

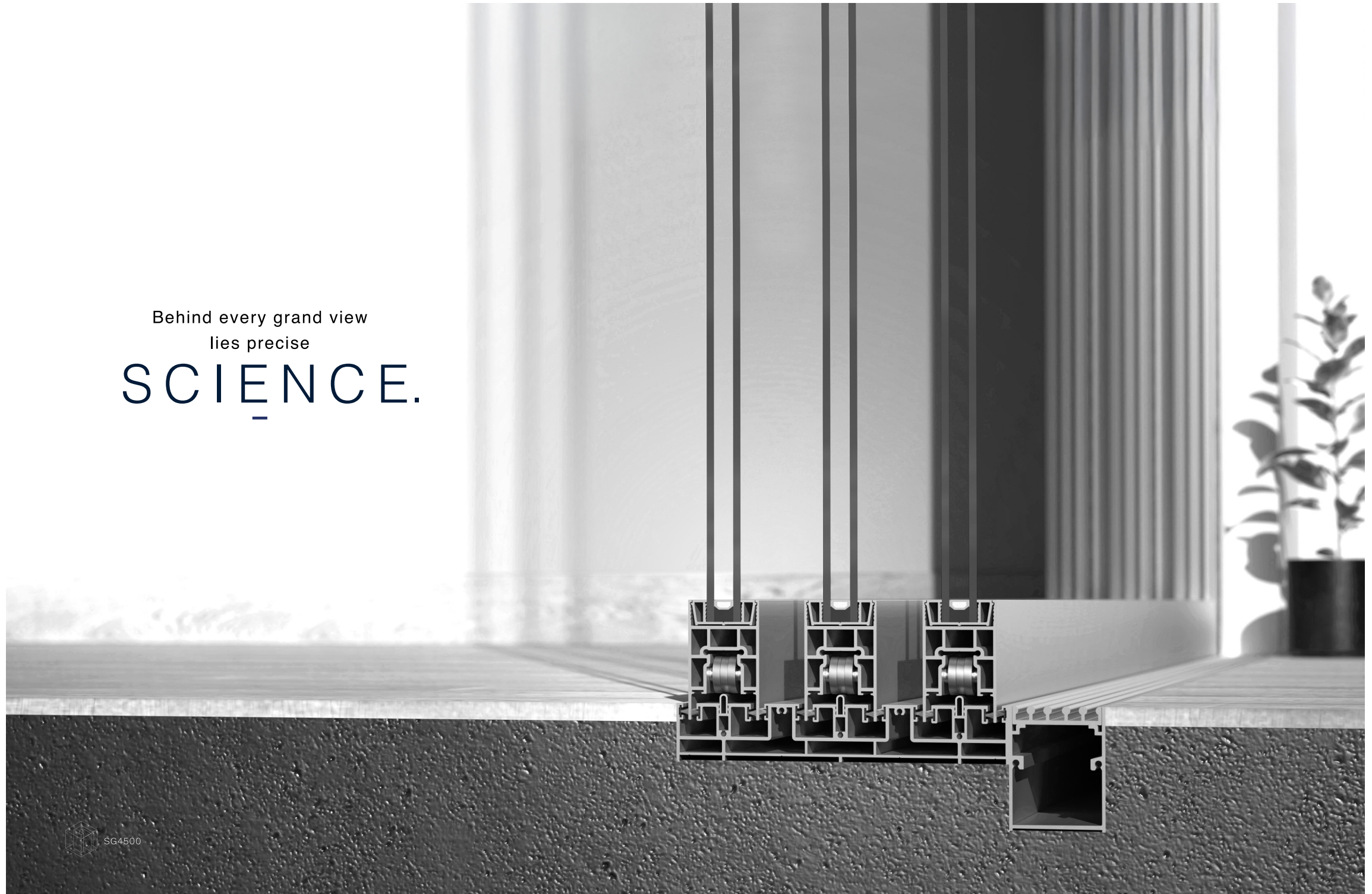

 SG4500

Luxury in every slide.
Where performance meets panoramic

LIVING.

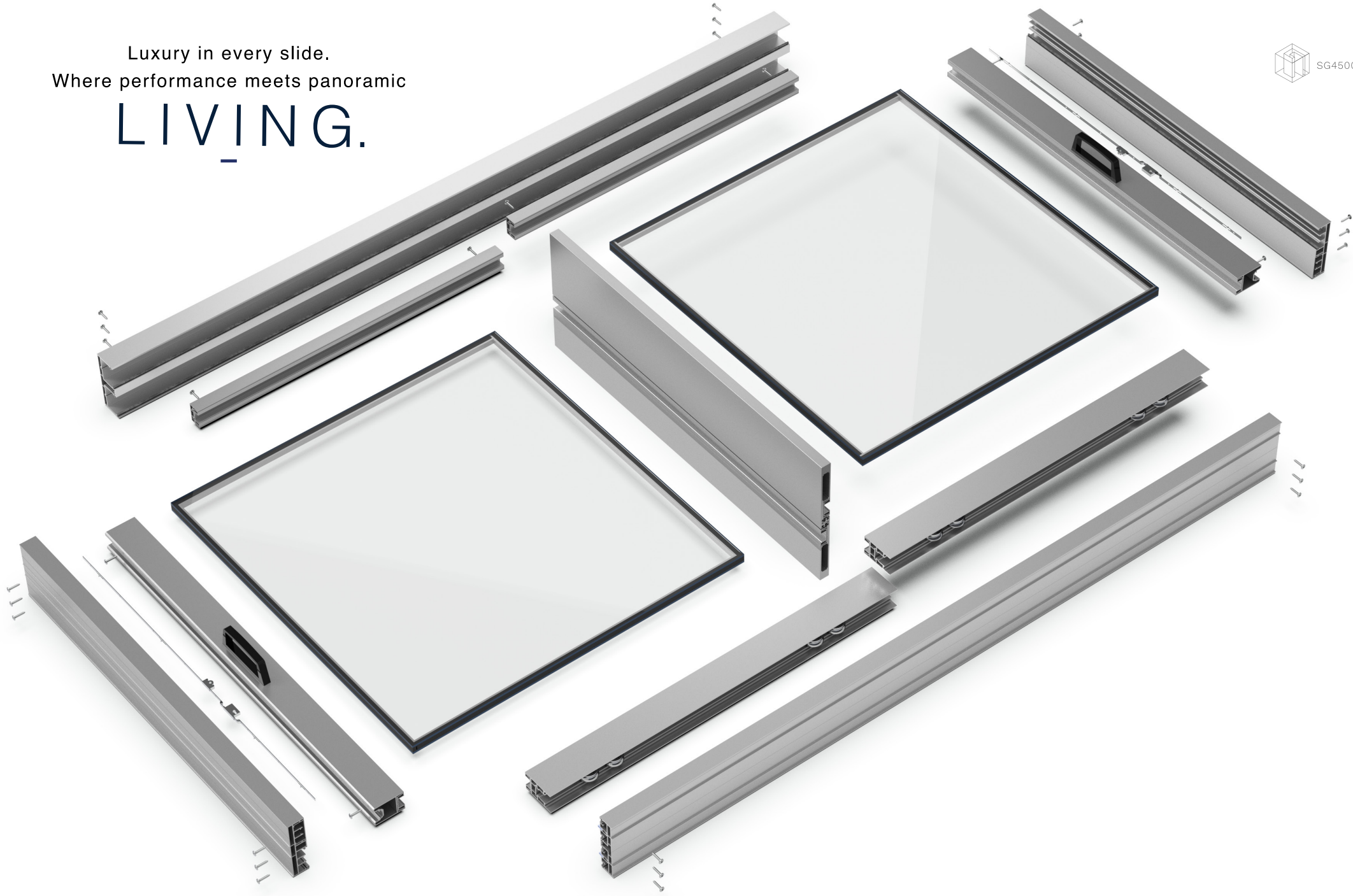

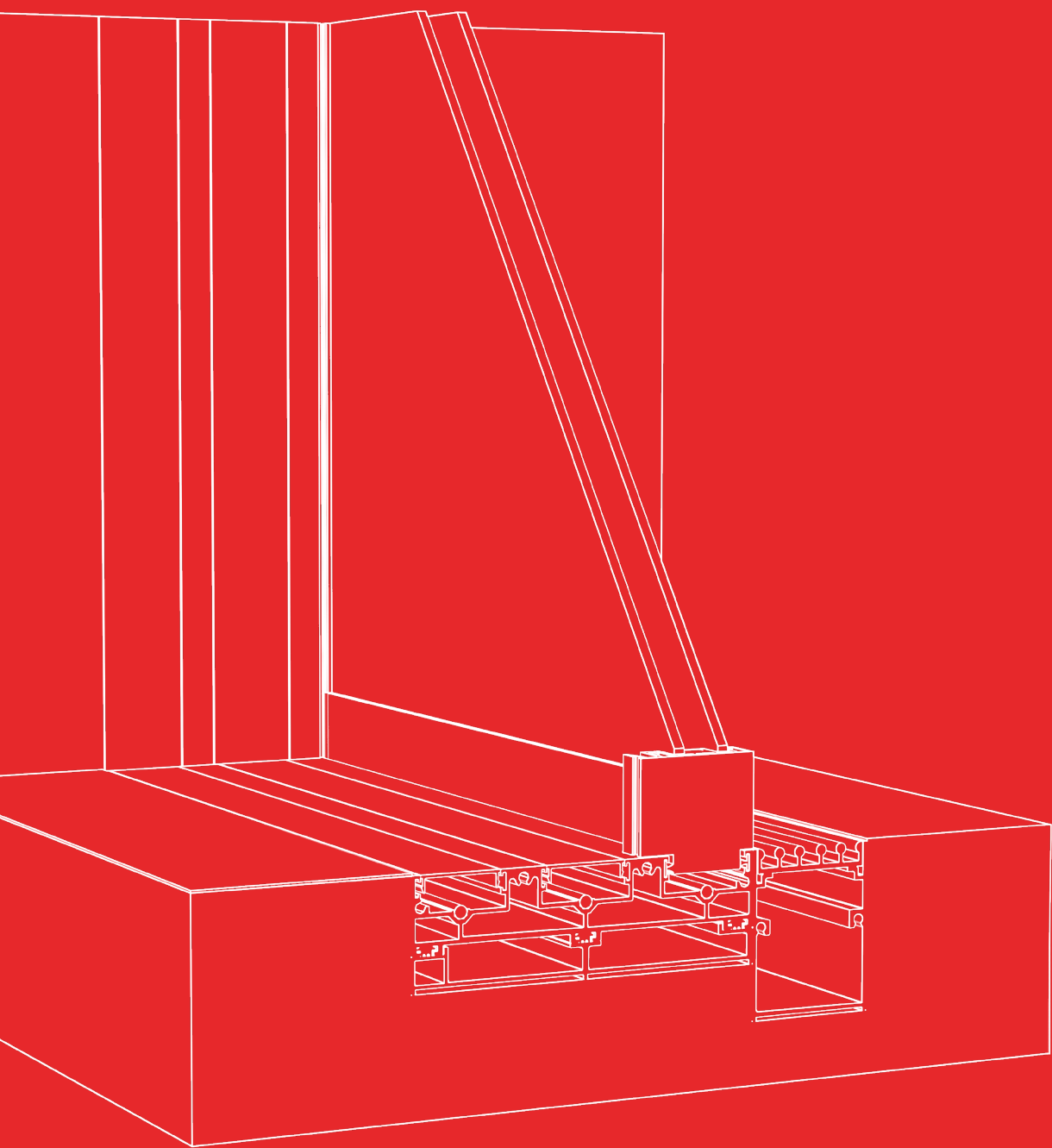

premium sliders

epic 19

Minimalism,
PERFECTED.





A frameless sliding system with a 19 mm interlock, delivering ultra-slim sightlines and maximum transparency.

Unitized pasting ensures precision, speed, and consistency - ideal for high-end architecture.

**Less Frame.
More Experience.**

Designed to dissolve
boundaries and elevate space.



WHAT YOU DON'T SEE FROM THE OUTSIDE TAKES YEARS TO MASTER.



DESIGNED FOR CONVENIENCE the system includes cover plates over the drainage gutter, allowing for effortless cleaning and maintenance while ensuring efficient water management.

Equipped with HIGH-GRADE 304 STAINLESS STEEL SOLID GUIDE RAILS, this system ensures smooth, durable, and effortless operation for long-lasting performance.

WITH INNOVATIVE GUTTER OPTIONS ENGINEERED for optimal drainage, this system ensures seamless water management, protecting your space and boosting performance with every detail.

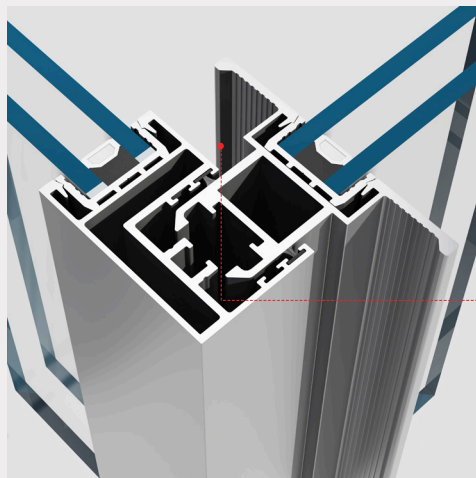

CORNER OPENING

This system offers the possibility of floating 90° corners, creating a seamless, open space with unobstructed panoramic views.

Highly praised for their durability and precision, prismatic THREE-FIN BRUSHES effectively block dirt, insects, and debris, ensuring superior protection.

A WIDE SELECTION OF RAL COLORS and adaptable orientation choices allow for flexible, tailored design.

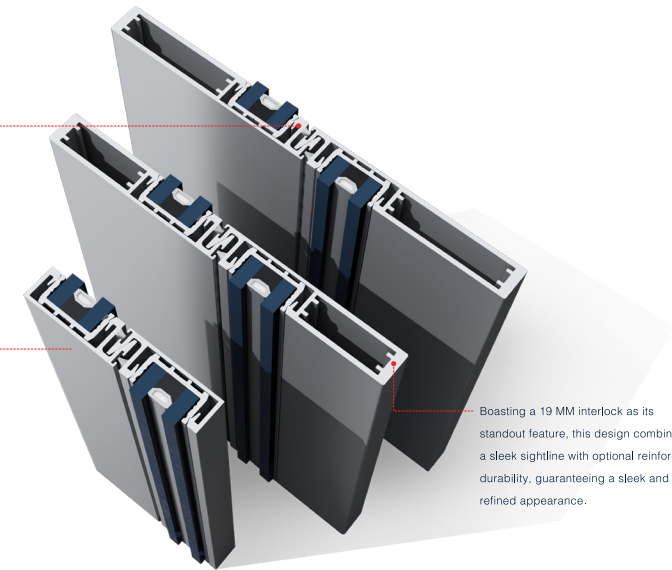

Boasting a 19 MM interlock as its standout feature, this design combines a sleek sightline with optional reinforced durability, guaranteeing a sleek and refined appearance.



Designed to disappear into the frame, the minimal invisible handle preserves clean lines and visual purity. Engineered for precision, it delivers effortless function without ever drawing attention to itself.



technicals

OPENING POSSIBILITIES

- 2 Track
- 3 Track

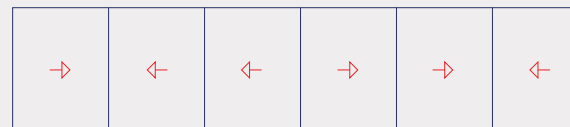
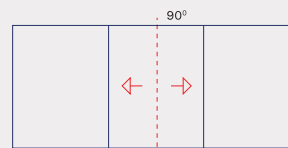
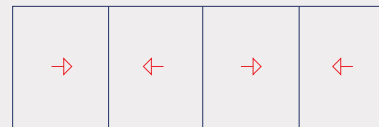

TESTING DETAILS

WIND RESISTANCE

As per BS EN 12211 (Class 5)

AIR PERMEABILITY TEST

Test BS EN 1026:2016 (Class4)

WATER TIGHTNESS TEST

Test BS EN 1027:2016 (PA 200, Classification 6A)

*Test verified by Eminent International Testing Center

MAXIMUM DIMENSIONS PER LEAF | SASH

Width	1800 mm
Height	4250 mm

Consult maximum weight and dimensions according to typologies

MAXIMUM WEIGHT PER LEAF | SASH

400 Kg

SECTION DETAILS

SIGHTLINES

Frame	34 45 45	2 Track	104
Sash	41 58	3 Track	163
Interlock	19		

*Consult interlock options as per design calculations

MAXIMUM ACOUSTIC INSULATION RW

42 dB

GLAZING

Minimum	12
Maximum	26

TRANSMITTANCE

Uw from 2.9 (W/m²k)

*Consult typologies, dimensions, and glass

EXTRUSION ALLOY

6036-T6

FINISHES | COATINGS

RAL powder coating

Anodized

Wooden finish

*Consult fabrication partners for ideal options

PROFILE THICKNESS

Minimum	2
Maximum	5

*All dimensions are in mm



MINIMAL
IS



MORE.



THE REASON WHY IT'S EPIC.

System offers the option to be **COMPLETELY FLUSHED ON ALL FOUR SIDES**, creating a clean, uninterrupted surface. This feature enhances the overall aesthetic, providing a sleek, modern look while ensuring a smooth, integrated design.

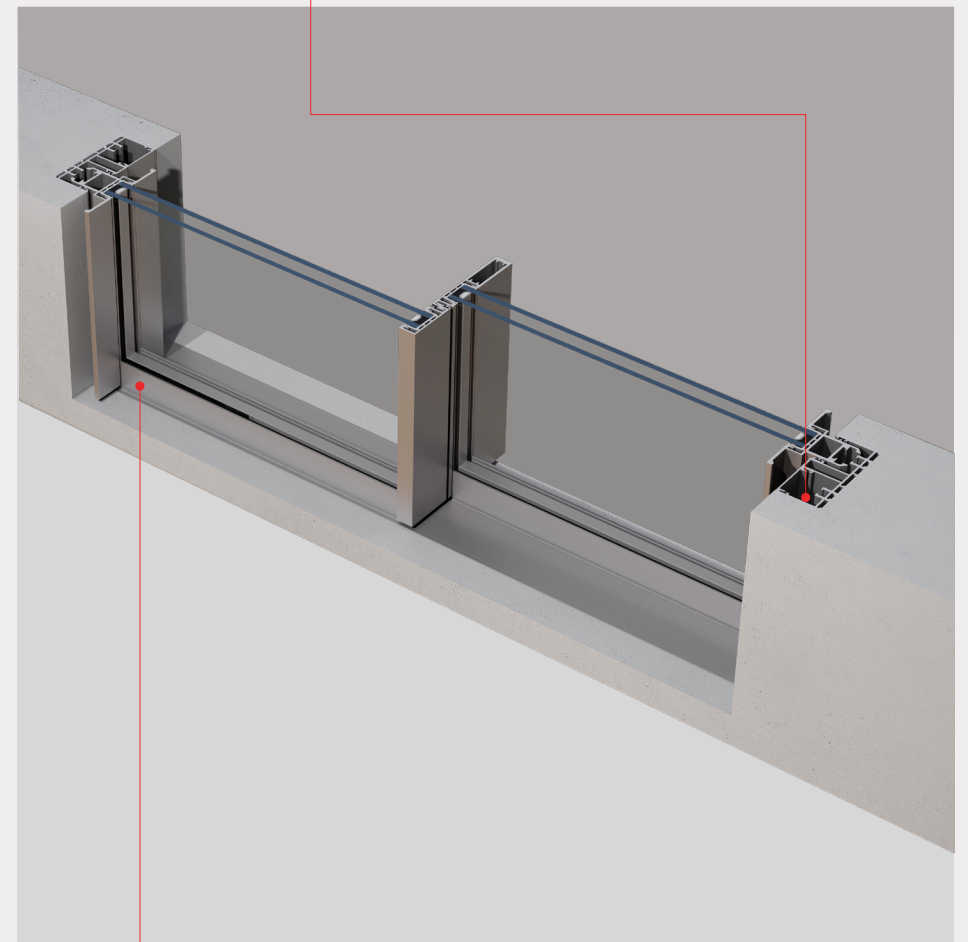

A FLAWLESSLY INTEGRATED SYSTEM, blending seamlessly into its surroundings to preserve functionality while elevating modern aesthetics and architectural sophistication.

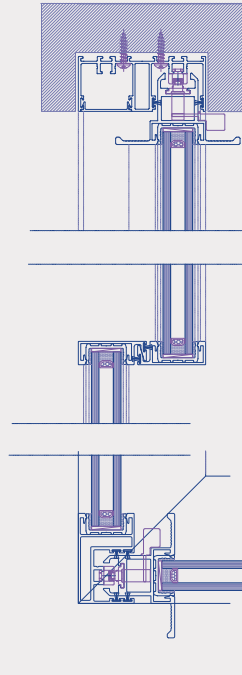

CORNER POST-FREE 90° OPENING — SEAMLESS CONTINUITY

The Grefet Epic19 corner post-free 90° opening is designed to eliminate visual barriers at building corners, creating a seamless transition between interior and exterior spaces. By removing the conventional vertical corner mullion, the system allows two sliding panels to meet cleanly at a right angle, delivering uninterrupted views and a strong architectural statement.

This solution is engineered to maintain alignment, stability, and smooth operation even at large panel sizes. Precision-designed interlocks and concealed structural interfaces ensure that when the panels are closed, the corner joint remains visually minimal, and when open, the space fully dissolves into its surroundings.

The 90° post-free configuration is ideal for luxury residences, villas, and hospitality projects where openness, daylight, and panoramic views are key design drivers. Combined with the minimal sightlines of the Epic19 system, the corner opening enhances spatial flow and enables architects to realise bold, modern layouts without compromising on functionality or detailing.

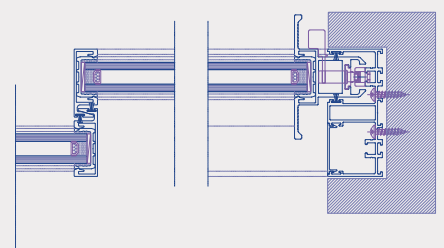

19 MM MINIMAL INTERLOCK ENGINEERED STRENGTH BEHIND THE VIEW

The Grefet Epic19 features an ultra-slim 19 mm centre interlock designed to achieve true minimal sightlines without compromising structural performance. This refined interlock profile ensures maximum transparency, creating a near-frameless appearance even across large sliding panels, while maintaining precise alignment and smooth panel engagement.

To address varying façade conditions and wind-load requirements, the 19 mm interlock is available with three different reinforcement configurations. These reinforcement options allow the system to be engineered for wind pressures up to 3.8 kPa, making it suitable for a wide range of low to high-rise applications where both aesthetics and performance are critical. The modular reinforcement approach enables designers and fabricators to optimise strength based on panel size, building height, and exposure conditions without increasing visible aluminium width. This balance of minimal visual impact and engineered robustness makes the Grefet Epic19 interlock ideal for expansive openings where uninterrupted views, clean vertical lines, and reliable performance are essential.

Disclaimer: Wind-load performance up to 3.8 kPa is subject to detailed window design, panel dimensions, reinforcement selection, glass specification, and project-specific structural analysis. Final performance must be validated based on approved calculations and glass type.

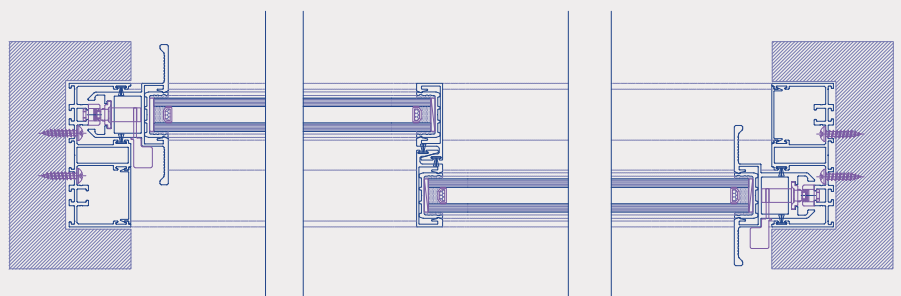

3-TRACK CONFIGURATION FLEXIBLE SOLUTION FOR EXTRA-LARGE OPENINGS

The Grefet Epic19 3-track option is engineered to address the demands of extra-large openings, offering enhanced flexibility in panel configuration without compromising the system's minimal aesthetic. Designed to accommodate up to 6 sliding panels, this configuration enables architects to achieve wide, uninterrupted spans while maintaining smooth and controlled operation. The multi-track layout allows panels to stack efficiently, maximising clear opening width and supporting diverse design requirements such as centre-opening, side-stacking, or a symmetrical panel arrangements. Despite the increased number of panels, the system retains clean sightlines and consistent alignment, ensuring visual continuity across the façade.

Structurally optimised tracks and precision-engineered rollers support large and heavy glass panels, making the 3-track option suitable for high-performance residential and commercial applications. This configuration is ideal for living spaces, villas, hospitality projects, and premium developments where large openings, flexibility of movement, and minimalist detailing are essential.

By combining capacity, adaptability, and refined engineering, the Grefet Epic19 3-track system provides a scalable solution for expansive openings while preserving the core philosophy of minimal design and functional performance.

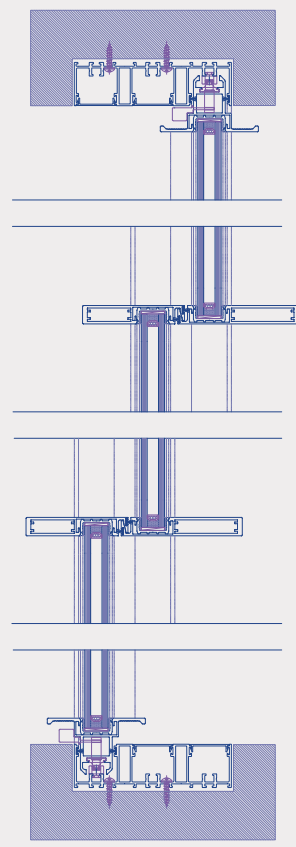

OPTIONAL CONTROLLED DRAINAGE SYSTEM

Designed for Assured Water Management

The Grefet Epic19 optional drainage system is engineered to deliver reliable and controlled water evacuation, even under severe weather conditions. The system is designed and validated in accordance with BS EN 1027:2016 standards for water tightness, ensuring dependable performance against wind-driven rain when correctly specified and installed. At the heart of this solution is a specially designed gutter chamber integrated within the sliding track assembly. This chamber collects incidental and pressure-driven water ingress and channels it in a controlled manner toward dedicated drainage paths, preventing water accumulation at the sill and protecting interior finishes. The geometry of the gutter is optimised to maintain continuous water flow, reducing turbulence and backflow during high rainfall and wind pressure scenarios.

Controlled drainage is further enhanced through a multi-chamber drainage concept, where water is first captured, then decelerated, and finally discharged through calibrated outlet points. This staged approach improves overall system water tightness and supports consistent performance during BS EN 1027:2016 test conditions. For long-term reliability and ease of maintenance, the gutter system is provided with a removable access cover, allowing periodic inspection and cleaning without dismantling the sliding system. This feature ensures that drainage efficiency is maintained over the life of the installation, particularly in environments prone to dust, debris, or heavy rainfall. By combining tested performance with service-friendly detailing, the optional drainage system of the Grefet Epic19 delivers a robust, maintainable, and standards-aligned solution for high-performance minimal sliding applications.

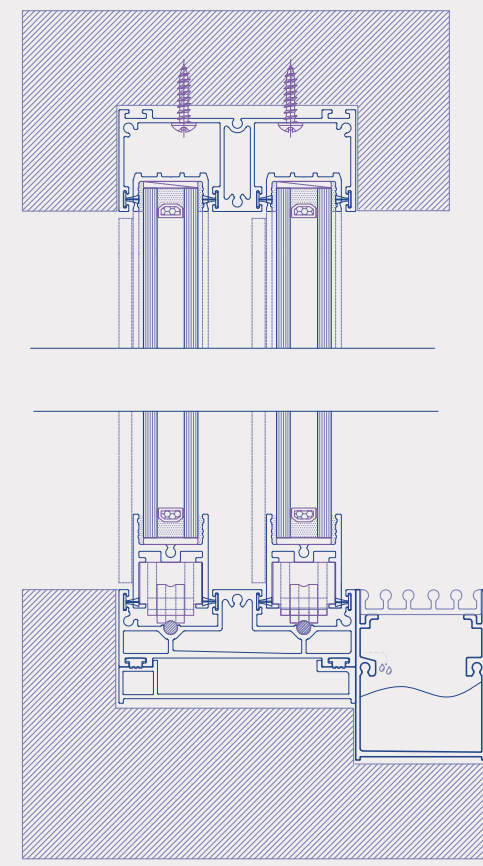

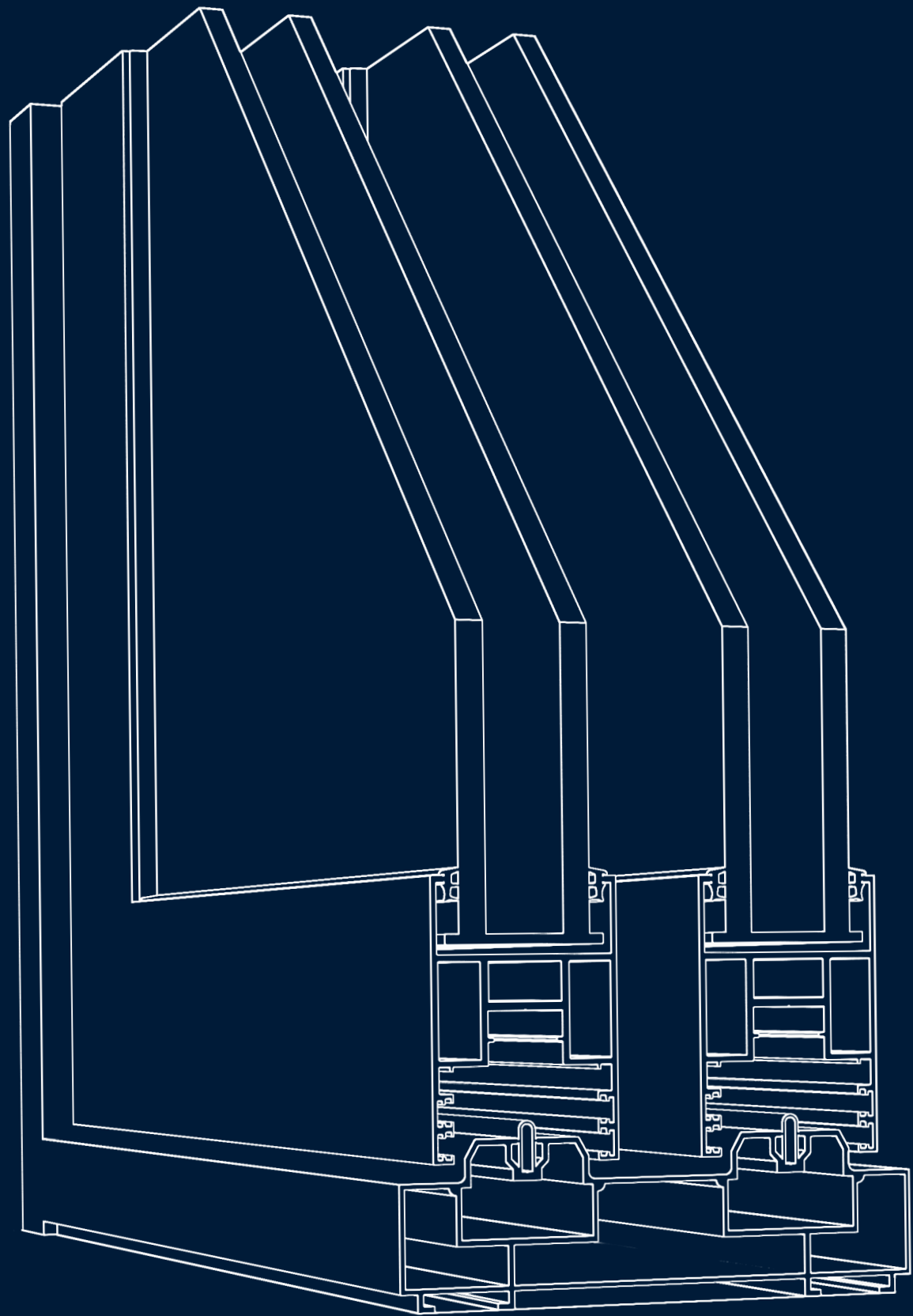

premium sliders

LS400

Lift and Slide

Lift & Slide Door System

EFFORTLESS

at scale.



**IT LIFTS. IT SLIDES.
IT MOVES YOUR HEART.**

The GREFET LS400 door system is engineered for premium architectural applications where large, heavy glass panels, smooth operation, and long-term durability are essential. Designed around a true lift-then-slide principle, the system delivers effortless movement even with very large door vents.



**Blocks everything
but the view.**

maximum insulation - water,
air and sound



LS400

Grefet Slimline Lift & Slide System

The Grefet Slimline LS400 System represents the pinnacle of modern sliding solutions, engineered for luxury architecture and expansive openings. Designed to deliver unmatched performance, aesthetics, and durability, it is the most versatile and suitable system across the entire sliding family, making it an ideal choice for premium villas, high-end residences, and large panoramic spaces. This system operates on an advanced lift-and-slide mechanism, where the sash is slightly lifted off the track before sliding. This ensures ultra-smooth, effortless movement, even for extremely heavy panels, while also providing superior sealing when locked.



Key Features & Advantages

ULTRA-SLIM 25MM INTERLOCK

The system features a sleek 25 mm interlock, significantly reducing visual obstruction and allowing maximum glass area. This results in uninterrupted panoramic views and enhanced natural light penetration.

LARGE PANEL CAPABILITY – UP TO 14 FEET HEIGHT

Engineered for grandeur, the system can accommodate panel heights up to 14 feet, making it perfect for floor-to-ceiling applications and creating a bold architectural statement.

HEAVY DUTY PERFORMANCE – 400 KG PER LEAF

Each panel is capable of handling up to 400 kg weight, supported by high-performance hardware. This ensures smooth operation, stability, and long-term reliability, even with large and heavy glazing units.

technicals

OPENING POSSIBILITIES

2 Track

3 Track

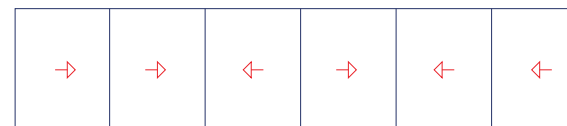
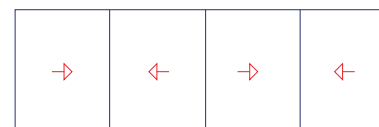
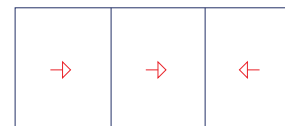
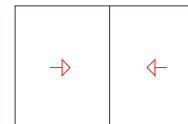

TESTING DETAILS

WIND RESISTANCE

As per BS EN 12211 (PA 3750, Class C)

AIR PERMEABILITY TEST

Test BS EN 1026:2016 (PA 600, Class4)

WATER TIGHTNESS TEST

Test BS EN 1027:2016 (PA 300, Class 7A)

*Test verified by Eminent International Testing Center

MAXIMUM DIMENSIONS PER LEAF | SASH

Width 1800 mm

Height 4260 mm

*Consult maximum weight and dimensions according to typologies

MAXIMUM WEIGHT PER LEAF | SASH

400 Kg

SECTION DETAILS

SIGHTLINES

Frame 35 | 58 | 42 2 Track 155

Sash 55 3 Track 235

Interlock 25

*Consult interlock options as per design calculations

MAXIMUM ACOUSTIC INSULATION RW

42 dB

GLAZING

Minimum 18

Maximum 38

TRANSMITTANCE

Uw from 2.9 (W/m²k)

*Consult typologies, dimensions, and glass

EXTRUSION ALLOY

6036-T6

FINISHES | COATINGS

RAL powder coating

Anodized

Wooden finish

*Consult fabrication partners for ideal options

PROFILE THICKNESS

Minimum 1.5

Maximum 5

*All dimensions are in mm

HOW THE LIFT & SLIDE MECHANISM WORKS

Unlike conventional sliding doors that rely on constant rolling friction, the GREFET LS400 system operates on a lift-first, then slide concept. When the handle is turned, the door sash is gently lifted off the track, disengaging the sealing gaskets and reducing friction to a minimum. Once lifted, the door slides extremely smoothly along the track. When the handle is turned back to the closed position, the sash lowers onto the frame, re-engaging the gaskets to provide excellent air tightness, water tightness, and acoustic insulation.

This intelligent mechanism ensures:

- Exceptionally smooth and silent operation
- Minimal physical effort, even with oversized glass panels
- Long service life due to reduced wear on rollers and tracks
- Designed for large & heavy glass panels

The GREFET LS400 system is intended for large-format glazing, making it ideal for villas, luxury residences, high-end apartments, and premium commercial spaces.

- Load capacity up to 400 kg per leaf, enabling the use of thick laminated or DGU glass
- Perfect for wide patio openings, panoramic views, and floor-to-ceiling glass doors
- Maintains stability and smooth motion even under maximum load conditions

SIMPLE AND USER-FRIENDLY OPERATION

Despite its high load capacity, the system remains very simple and intuitive to use. A single handle action lifts the door, allows smooth sliding, and then lowers it back into a fully sealed position. This makes the system suitable for all users while still meeting demanding architectural and structural requirements. The Grefet LS400 products, manufactured using high-quality SS304 grade components,



SS304 is non-corrosive and rust-resistant, making it ideal for coastal, humid, and polluted environments

- Ensures zero corrosion across the complete lifespan of the door system
- Delivers consistent performance, strength, and aesthetics over many years

KEY ADVANTAGES AT A GLANCE

- Lift-then-slide technology for ultra-smooth movement
- Supports very large and heavy glass panels (up to 400 kg per sash)
- Excellent sealing performance when closed
- Minimal effort operation despite heavy weight
- SS304 stainless steel hardware for corrosion-free longevity
- Ideal for luxury residential and high-end architectural projects



In summary, the GREFET LS400 door system—combined with Grefet's CNC-based manufacturing quality—offers a robust, elegant, and future-ready solution for architects and homeowners seeking large openings, uninterrupted views, and flawless sliding performance without compromise.

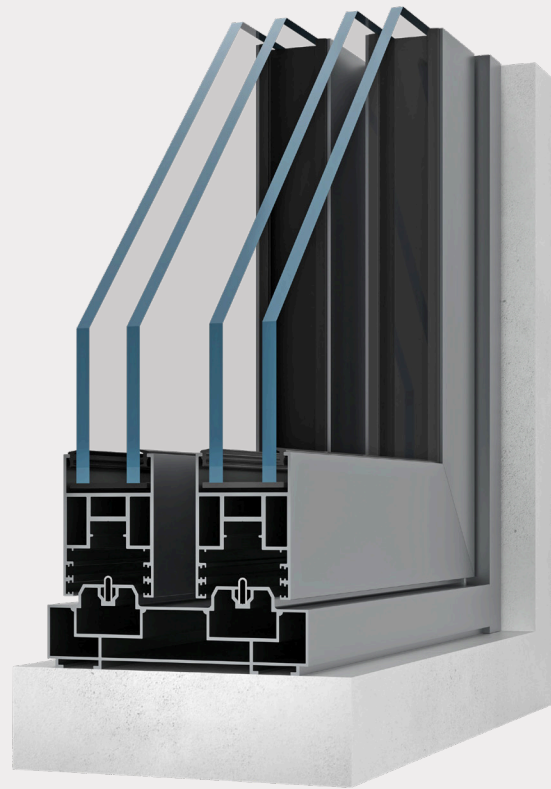

FLEXIBLE CONFIGURATION – 2 TRACK & 3 TRACK OPTIONS

Available in both 2-track and 3-track configurations, the system offers design flexibility to suit different opening requirements:

- 2 Track: Ideal for standard large openings
- 3 Track: Suitable for wider spans and maximum opening flexibility

SUPPORTS UP TO 38 MM GLAZING

The system accommodates glazing thickness up to 38 mm, enabling the use of:

- Double Glazed Units (DGU)
- High-performance acoustic glass
- Energy-efficient glass solutions

This ensures excellent thermal insulation, sound reduction, and structural strength.

PERFORMANCE & EXPERIENCE

The Grefet Slimline LS400 System is designed to deliver a premium user experience:

- Effortless sliding despite large panel sizes
- Superior air and water tightness when locked
- Enhanced security through robust locking mechanisms
- Long-lasting corrosion-resistant hardware

APPLICATION

Perfectly suited for:

- Luxury villas
- Farmhouses
- High-rise premium apartments
- Large patio and garden openings



CONCLUSION

With its combination of minimal sightlines, massive panel capability, and superior engineering, the Grefet Slimline LS400 System stands as the most advanced and dependable sliding solution in its category. It seamlessly blends performance with aesthetics, redefining the way spaces connect with the outdoors.



Signature

casements

ENGINEERED *for* PERFORMANCE

SINGLE DOOR | FRENCH DOOR | PARALLEL



GREFET CS50 is a high-performance aluminium casement system engineered for mid to high-rise applications where structural stability, air-water tightness, and long-term serviceability are critical.

The CS50 section geometry and hardware interface are optimized to achieve a robust sash-to-frame engagement with controlled gasket compression, ensuring reliable sealing performance under design wind pressure.

Good morning, thanks to

PERFECT

sunlight.



CSP50 TECHNICAL

WIND LOAD & STRUCTURAL DESIGN BASIS

The CS50 casement series is designed for 2.5 kPa wind pressure, with analysis and member sizing carried out in accordance with:

- IS 875 (Part 3) – Wind load evaluation and design pressure criteria
- IS 8147 – Structural design guidelines for aluminium members

System deflection control and structural checks are performed to maintain functional operation and durable performance under repeated wind actions.

MATERIAL SPECIFICATION (ALUMINIUM)

CS50 profiles are extruded in Alloy 6063-T6, suitable for architectural applications requiring good mechanical strength and corrosion resistance. Design calculations are based on:

- Density (γ_a): 27.1 kN/m³
- Modulus of Elasticity (Ea): 65,500 MPa
- Permissible stress (Pbc / Pbt): 96 MPa

These properties are used for structural verification of frame/sash members, reinforcement strategy (if applicable), and fastener load transfer.

GLASS ENGINEERING COMPLIANCE

Glazing configuration and glass thickness selection are designed considering wind load, panel size, and support conditions in line with:

- ASTM E1300 – Glass design under uniform loads (strength and probability-based approach)
- AS 1288:2006 – Glass in buildings: selection and installation practices

This ensures safe glass performance, minimized deflection, and compatibility with sealing and drainage design.

PERFORMANCE INTENT

With a design approach anchored in recognized Indian and international standards, GREFET CS50 delivers a balanced solution—sleek casement aesthetics with engineered strength for 2.5 kPa wind load, making it suitable for demanding façade openings requiring dependable operation and long-term durability.

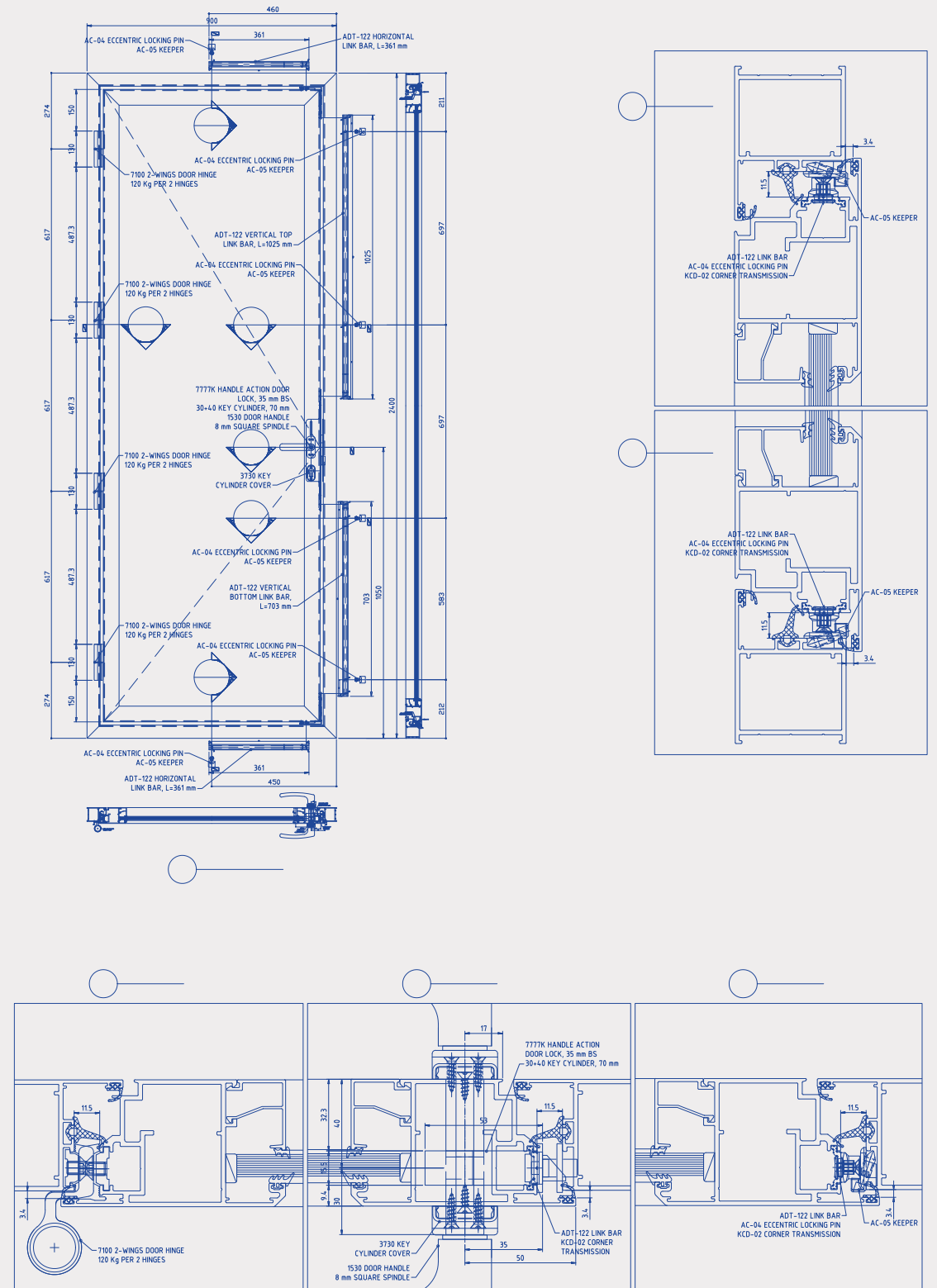

**BUILT FOR FLEXIBILITY,
PERFORMANCE, AND DESIGN INTEGRATION.**

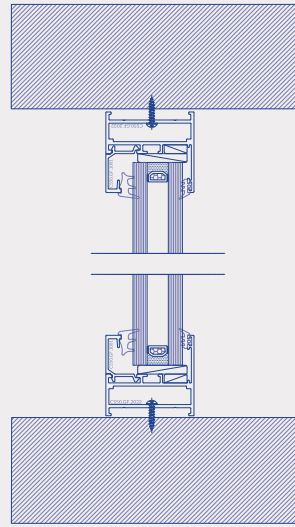

FIX SYSTEM

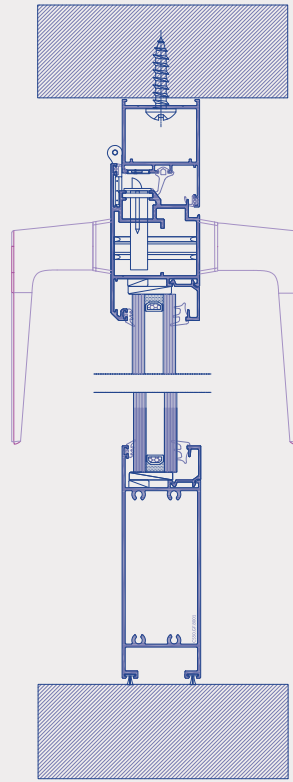

BIG BOTTOM

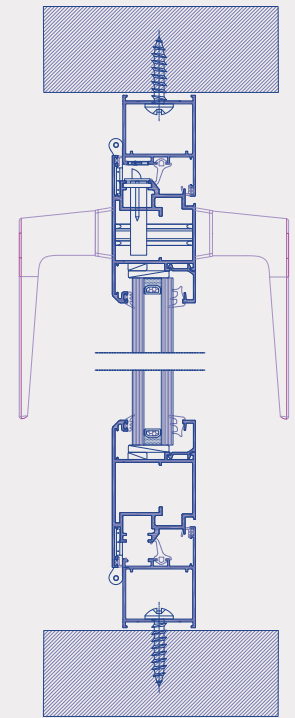

BIG FRAME

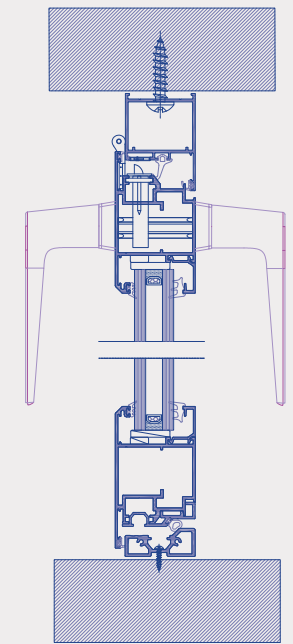

LOW THRESHOLD

technicals

OPENING POSSIBILITIES

SIDE HUNG

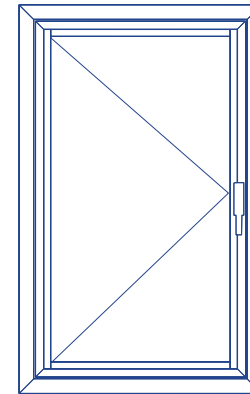

FIXED

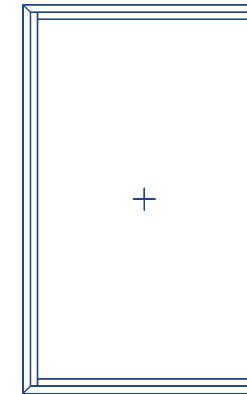

TOP HUNG

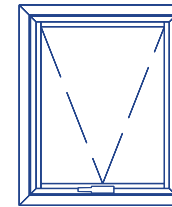

TESTING DETAILS

WIND RESISTANCE

As per BS EN 12210 (Class C5)

AIR PERMEABILITY TEST

BS EN 1026:2016 (Class 4)

WATER TIGHTNESS TEST

BS EN 1027:2016 (Class 9A)

*Test verified by Eminent International Testing Center

MAXIMUM DIMENSIONS PER LEAF | SASH

Width	1000 mm
Height	3000 mm

*Consult maximum weight and dimensions according to typologies

MAXIMUM WEIGHT PER LEAF | SASH

120 Kg

SECTION DETAILS

SIGHTLINES

Frame	50 45 70
Sash	80 101

*Consult interlock options as per design calculations

MAXIMUM ACOUSTIC INSULATION RW

39 dB

GLAZING

Minimum	5
Maximum	32

TRANSMITTANCE

Uw from 2.0 (W/m²K)

*Consult typologies, dimensions, and glass

EXTRUSION ALLOY

6036-T6

FINISHES | COATINGS

RAL powder coating

Anodized

Wooden finish

*Consult fabrication partners for ideal options

PROFILE THICKNESS

Minimum	1.52
Maximum	2.0

*All dimensions are in mm



CS50

SINGLE DOOR

A DOOR WITH CHARACTER

Engineered with flexible threshold options, this flawless blend of aesthetics and utility brings sophisticated charm to your interior while offering advantages of minimized sound transmission and improved thermal performance. Equipped with a comprehensive multi-point security system, available in heights reaching 10 feet, advanced 3D hinge technology enabling seamless operation, customizable window sealing solutions, featuring glazing capacity for 32mm insulated glass units.



Max Weight Up to 120 kg



Glazing up to 32 mm



Acoustic Insulation up to 39 DB



Sash Dimension 1000 X 3000 mm

MAXIMUM DIMENSIONS PER LEAF | SASH

Width 1000 mm

Height 3000 mm

*Consult maximum weight and dimensions according to typologies

MAXIMUM WEIGHT PER LEAF | SASH

120 Kg

SECTION DETAILS

SIGHTLINES

Frame 50 | 45 | 70

Sash 80 | 101

*Consult interlock options as per design calculations

MAXIMUM ACOUSTIC INSULATION RW

39 dB

GLAZING

Minimum 5

Maximum 32

TRANSMITTANCE

Uw from 2.0 (W/m²k)

*Consult typologies, dimensions, and glass

EXTRUSION ALLOY

6036-T6

FINISHES | COATINGS

RAL powder coating

Anodized

Wooden finish

*CONSULT FABRICATION PARTNERS FOR IDEAL OPTIONS

PROFILE THICKNESS

Minimum 1,52

Maximum 2,00

*All dimensions are in mm





cs50

FRENCH DOOR

Breathe life into spaces

Designed with or without a threshold, the perfect combination of style and functionality, adding a touch of elegance to your space while providing the benefits of reduced noise and better energy efficiency. It comes with a multi-locking system key for additional security, up to 10 feet tall, 3D hinges for smooth movement, options for window closure systems, with glazing up to 32mm DGU glass.

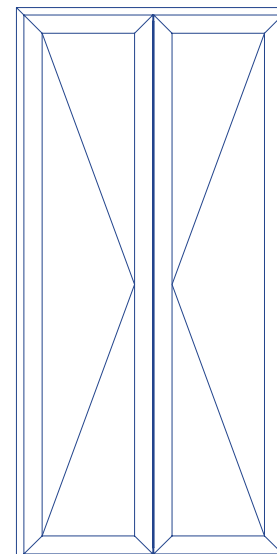

Max Weight Up to 120 kg

Glazing up to 32 mm

Acoustic Insulation up to 39 DB

Sash Dimension 1000 X 3000 mm





cs50

PARALLEL HINGES ON PERFECTION

A concealed parallel hinge system that allows windows to open parallel to the wall, delivering seamless integration with uncompromised functionality. All the while, tested for performance up to 40,000 cycles.

 Max Weight Up to 200 kg

 Max height 3000 mm

 Vent width Up to 1500 mm

 Maximum opening up to 1500

KEY STRENGTHS

Fully concealed parallel hinges for a sleek, uninterrupted aesthetic

Superior durability for long-term performance

Parallel hinges crafted from high-grade authentic stainless steel

Reinforced construction for added strength

Natural ventilation enabled even with minimal openings

Enhanced security through reduced ventilation gaps

Glass thickness up to 32 mm

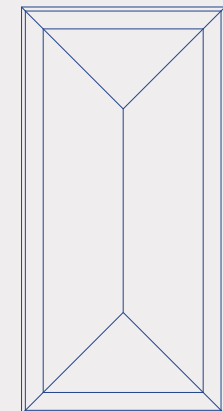

SINGLE DOOR | FRENCH DOOR | DOUBLE SASH

CS40

The GREFET CS40 Casement System is a modern and cost-effective aluminium window and door solution designed for contemporary residential and high-rise projects. Engineered for durability, clean aesthetics, and smooth functionality, CS40 offers versatile design options suitable for both premium and volume-based developments.

With slim aluminium sightlines, multiple opening configurations, and flexible locking options, the system delivers the perfect balance between performance, practicality, and value.



SINGLE DOOR

Designed for Single Point
& Multi Lock Options

The CS40 Single Door System is developed for modern architectural applications requiring sleek appearance and reliable functionality. The system supports both single point locking and multi-point locking configurations based on project requirements and security preferences.

FEATURES

- Elegant slim-profile aluminium design
- Available in single point and multi-point locking options
- Suitable for balconies, utility areas, and internal applications
- Supports glazing options from 5 mm to 24 mm
- Smooth and durable hardware operation
- Ideal for residential and high-rise developments

FRENCH DOOR

The CS40 French Door System combines maximum opening space with modern aesthetics, making it ideal for balconies, villas, terraces, and luxury residential spaces. Designed for larger openings, the system enhances natural light and ventilation while maintaining structural stability.



FEATURES

- Wide opening design for better accessibility
- Slim aluminium profiles for enhanced glass visibility
- Elegant inward and outward opening configurations
- Compatible with multiple hardware and handle options
- Supports large glass panels for modern façade appearance
- Suitable for residential and hospitality projects

DOUBLE SASH

With Integrated Mesh Sash

The CS40 Double Sash System with integrated mesh sash offers the perfect combination of ventilation, protection, and usability. The integrated mesh panel allows natural airflow while protecting interiors from insects and dust, making it ideal for everyday residential use.

FEATURES

- Dual sash configuration with dedicated mesh sash
- Integrated mesh solution for ventilation and comfort
- Smooth independent operation of glass and mesh panels
- Clean and practical design for modern homes
- Enhanced usability for daily ventilation requirements
- Suitable for bedrooms, living spaces, and high-rise apartments

technicals

OPENING POSSIBILITIES

Fixed
Opening
French

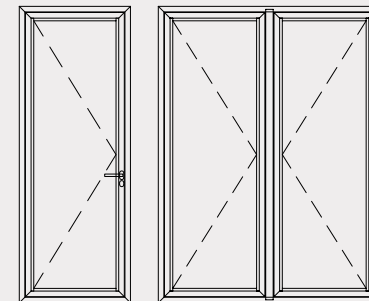
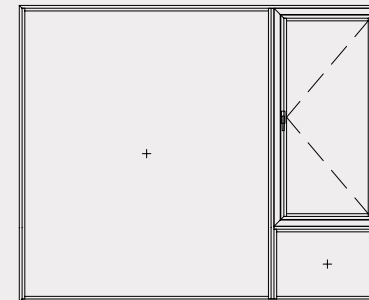
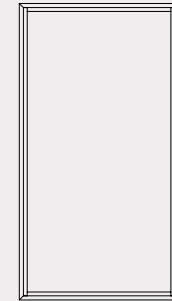

TESTING DETAILS

WIND RESISTANCE

As per BS EN 12210 (Class C5)

AIR PERMEABILITY TEST

Test BS EN 1026:2016 (Class 4)

WATER TIGHTNESS TEST

Test BS EN 1027:2016 (Class 9A)

*Test verified by Eminent International Testing Center

MAXIMUM DIMENSIONS PER LEAF | SASH

Width 900 mm

Height 2400 mm

*Consult maximum weight and dimensions according to typologies

MAXIMUM WEIGHT PER LEAF | SASH

120 Kg

SECTION DETAILS

SIGHTLINES

Single Frame 40 | 50

Double Frame 50 | 112

Sash 66 | 80 | 100

Mesh Shutter 80

*Consult interlock options as per design calculations

MAXIMUM ACOUSTIC INSULATION RW

39 dB

GLAZING

Minimum 5

Maximum 24

TRANSMITTANCE

Uw from 2.0 (W/m²K)

*Consult typologies, dimensions, and glass

EXTRUSION ALLOY

6063-T6

FINISHES | COATINGS

RAL powder coating

Anodized

Wooden finish

*CONSULT FABRICATION PARTNERS FOR IDEAL OPTIONS

PROFILE THICKNESS

Up to 1.5 mm

*All dimensions are in mm



corset37

Smart design for compact spaces.

CORSET37 is a series of versatile casement windows designed for optimal functionality and elegant aesthetics. Featuring a robust hinged system with a sleek 30 mm frame depth, these units are crafted from premium 6063-T6 aluminum alloy for exceptional durability and performance.

The system accommodates both inward and outward openings with side-hung and top-hung configurations, offering design flexibility for various architectural needs.

Compatible with 4-8 mm (only openable) glazing and featuring a 1.52 mm profile thickness, CORSET37 combines practicality and space-efficient design to enhance utility areas and compact spaces, in any architectural project.

 Max Weight Up to 50 kg

 Glazing up to 8 mm

 Single point locking

 Sash Dimension 900 X 1800 mm

KEY STRENGTHS

Acoustic insulation up to 40 DB

Air permeability EN 1026: 2016 Class 4

Water tightness EN 1027: 2016 Class 9A

Wind resistance EN 12210 2.8 kPA

Transmittance $U_w > 2.0$ (W/m² K)

Frame depth - 30-45 mm

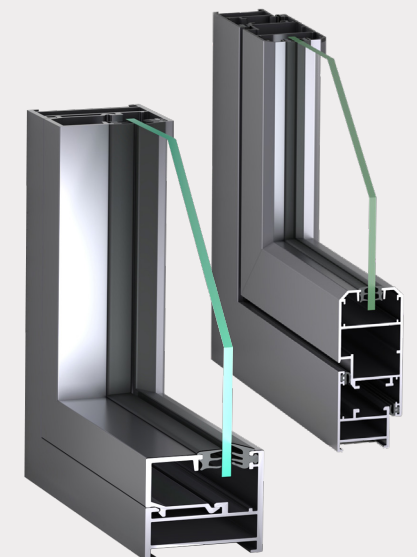

Premium

casements

SINGLE DOOR | TURN N TILT | PIVOT | FAN LIGHT

csp 100



csp100

OPENABLE SINGLE DOOR

Transform the space.
Live the difference.

REFET's premium tall doors are crafted to elevate every entrance with a sense of grandeur and sophistication. Designed with precision engineering and modern aesthetics, their impressive height enhances both proportion and presence. Built to perform and styled to inspire, they bring a bold architectural statement to any space.



Max Weight Up to 200 kg



Max height 12 Feet

THREE-PART CLAMPABLE DOOR HINGE



THE RAPID EXIT LOCK

Locks with hooks in stainless steel:
suitable for RC3 certification

Engineered with advanced security
standards and rigorously tested for
burglar resistance

Tested for durability with over
1 million operating cycles

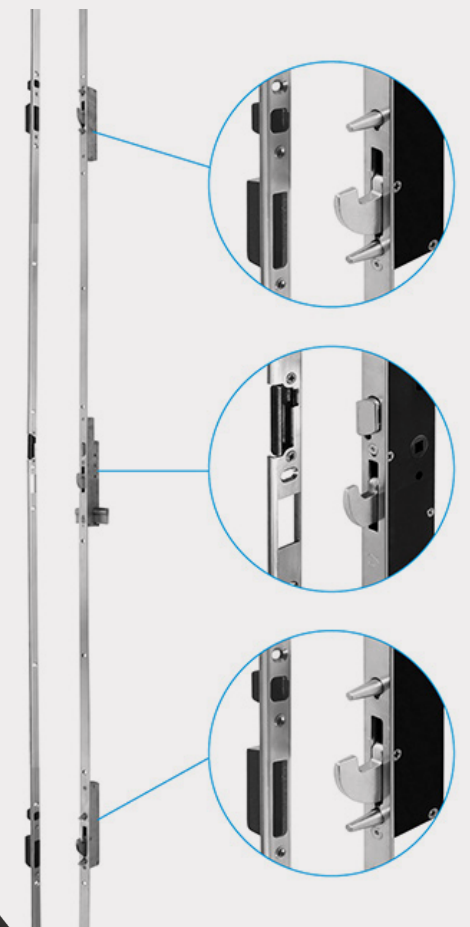



csp100

TURN & TILT

Effortless in both directions

With a simple tilt, these windows provide soft, draft-free ventilation while preventing rain entry, ideal for monsoon conditions. A full turn opens them wide, ensuring maximum airflow and easy cleaning, even in high-rise or hard-to-access areas, with glazing up to 32 mm.

 Max Weight Up to 130 kg

 Max height 2800 mm

 Vent width Up to 1300 mm

 Maximum opening up to 100°

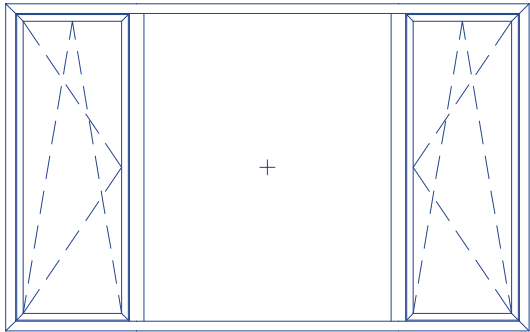



csp100

PIVOT

Rotate with elegance.

A premium surface-mounted hinge system engineered for both aesthetics and performance, featuring custom-designed skirts that deliver a refined, seamless finish.

KEY STRENGTHS

Integrated adjustable friction mechanism for smooth, silent operation

Minimalist design with concealed components for a clean aesthetic

Optional stay with button control for fixed ventilation at 10°, 15°, or 22°

Glazing up to 32 mm

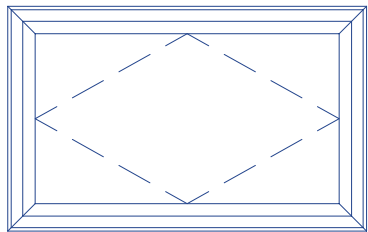

Max Weight up to 180 kg

Max height 2000 mm

Maximum opening up to 180°

Vent width up to 2400 mm



csp100

FAN LIGHT

Smart ventilation, sleek design.

Intelligent ventilation solution for high or hard-to-access windows. Ideally suited for tilt and top-hung windows, particularly those installed at elevated positions.

 Max Weight Up to 80 kg

 Max height 1800 mm

 Vent width Up to 3600 mm

 Maximum opening up to 170 mm

KEY STRENGTHS

Sleek, compact surface-mounted design

Convenient operation via handle or crank

Quick link-arm release for effortless cleaning

Natural ventilation for a healthy, energy-efficient environment

Glazing up to 32 mm

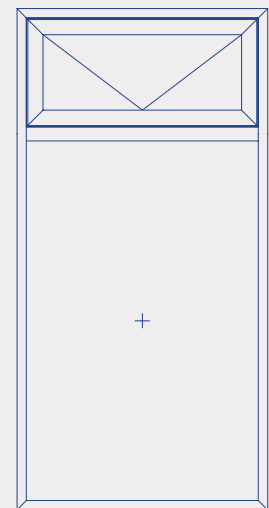

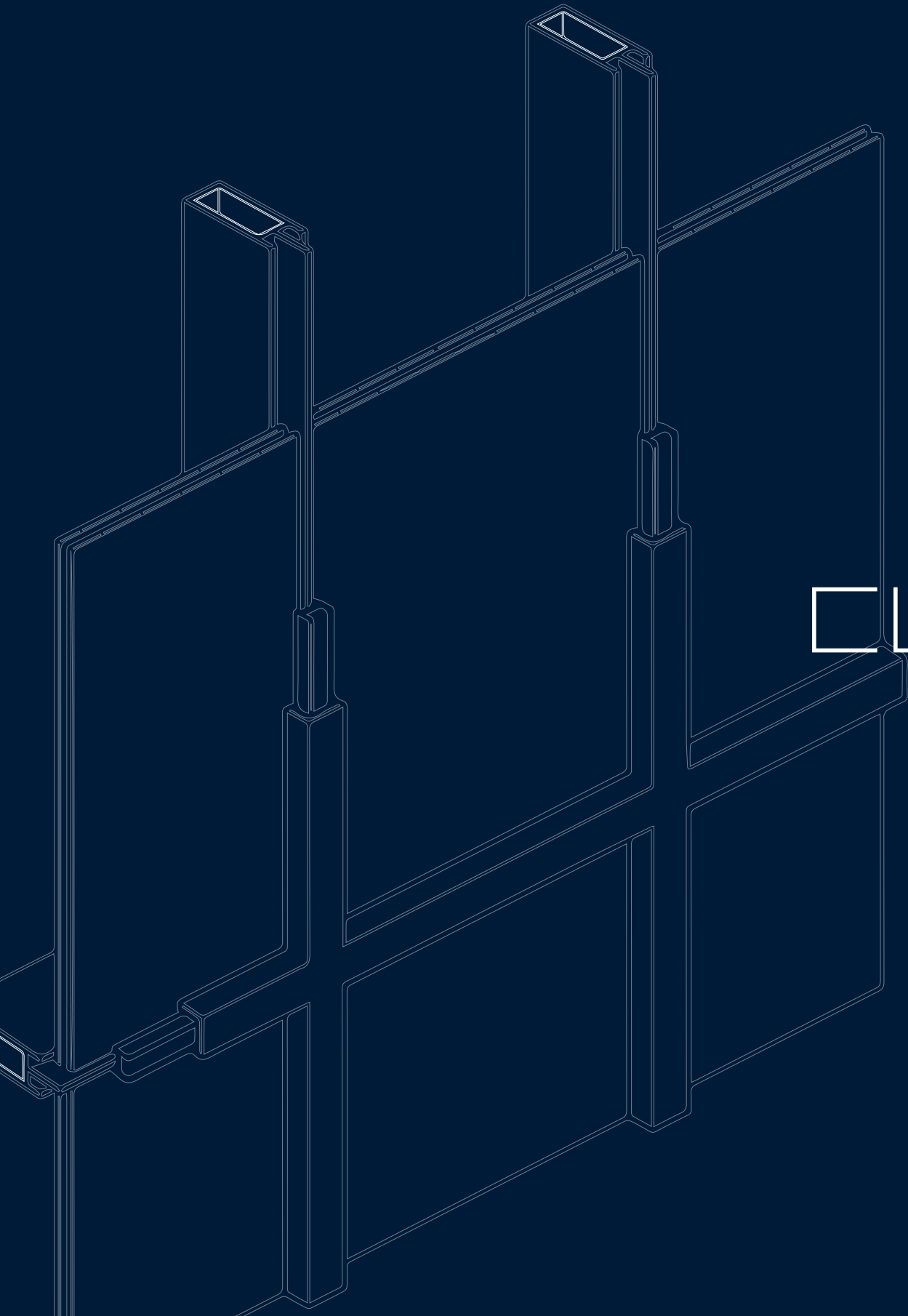

curtain wall

GCW3500 Slim Line

Minimal façade.
Maximum
IMPACT.
—



The GCW3500 from Grefet represents the next generation of façade engineering designed to deliver sleek aesthetics, superior performance, and advanced energy efficiency. With a minimal 35 mm front face, this system creates an ultra-slim visual profile, maximizing glass area and enabling architects to achieve clean, modern elevations without compromising structural integrity.



technicals

TESTING DETAILS

AIR PERMEABILITY TEST

Class A1, EN 12152

WATERTIGHTNESS

class RE 1050, EN 12154

WIND LOAD RESISTANCE

2700Pa, EN 13116

IMPACT RESISTANCE

class 15/E5, EN 13049

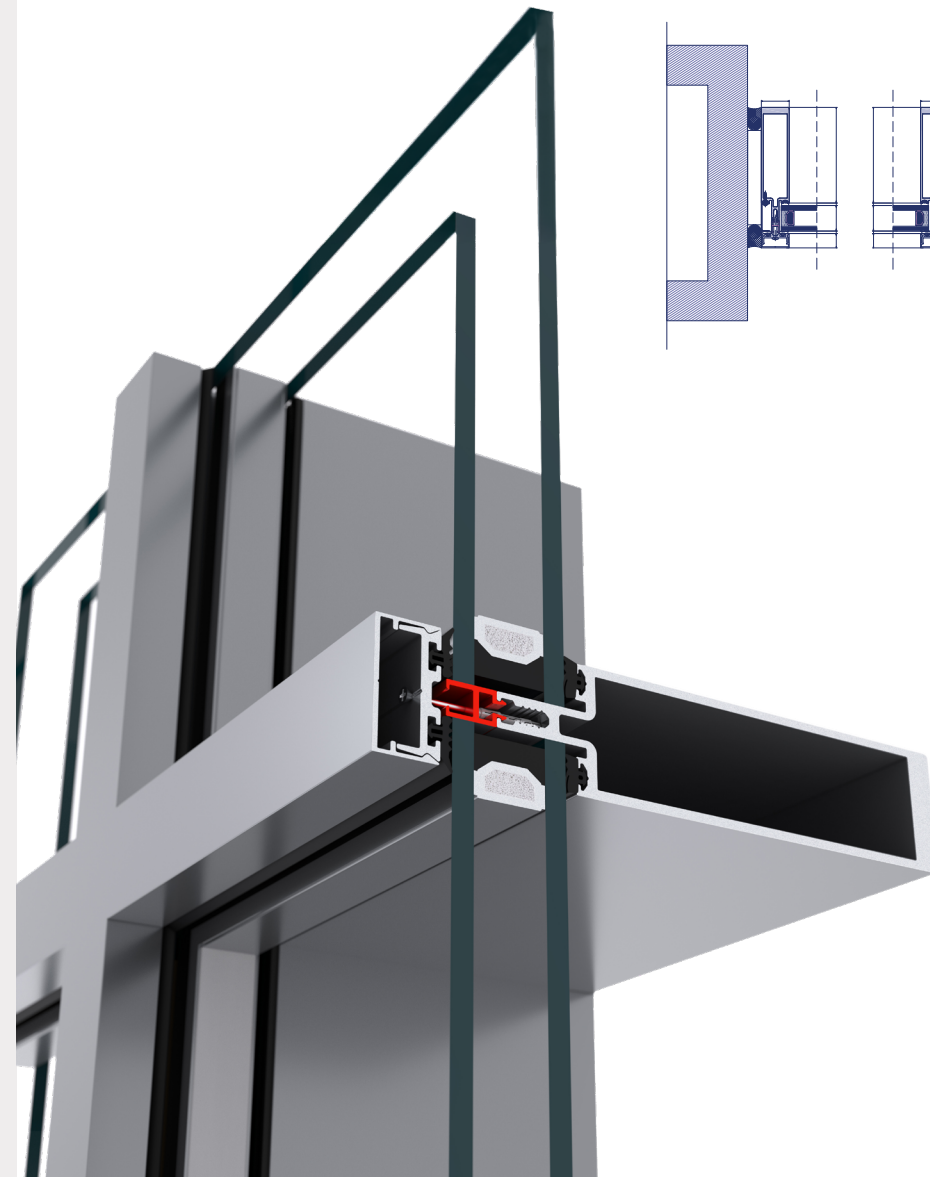
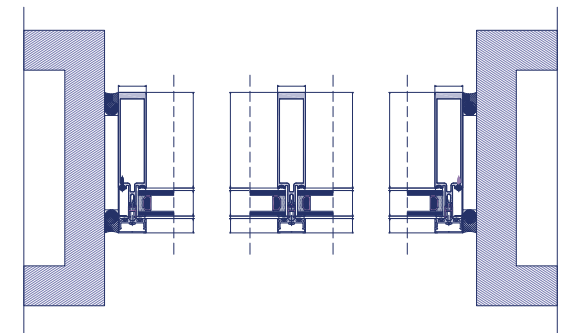



ULTRA-SLIM AESTHETIC WITH STRUCTURAL STRENGTH

At the core of GCW3500 lies its 35 mm visible face width, one of the slimmest in its class. This ensures:

- Maximum daylight penetration
- Enhanced transparency and uninterrupted views
- A refined, contemporary façade appearance

Despite its minimal sightline, the system is engineered to maintain high structural stability, making it suitable for both mid-rise and high-rise applications.

FLEXIBLE DEPTH CONFIGURATIONS

The system offers two mullion depth options to suit varying structural and design requirements:

- 80 mm Depth – Ideal for standard applications and moderate wind load conditions
- 120 mm Depth – Designed for high-rise projects and higher structural performance needs

This flexibility allows architects and consultants to optimize façade design based on wind load, building height, and span requirements.

ENERGY-EFFICIENT DESIGN

GCW3500 is engineered with a strong focus on energy performance, helping reduce building energy consumption while enhancing occupant comfort.

Key features include:

- Optimized glazing pockets for double-glazed units (DGU)
- Advanced gasket systems ensuring air and water tightness
- Reduced thermal transfer for improved indoor climate control





HIGH PERFORMANCE & RELIABILITY

The system is designed to meet demanding façade performance standards:

- Excellent wind load resistance
- Superior water drainage and pressure equalization system
- High-quality EPDM gaskets and sealing components
- Durable aluminium profiles ensuring long service life

UTTING-EDGE ENGINEERING

GCW 3500 integrates modern façade technology with precision engineering:

- Pressure plate and cover cap system for secure glazing
- Efficient drainage and weep chamber design
- Compatibility with large glass panels for expansive façades
- Clean and modular installation for faster project execution

THERMAL & NON-THERMAL OPTIONS

To cater to diverse project requirements, GCW3500 is available in:

- Thermal break system Incorporates high-performance polyamide barriers to significantly reduce heat transfer, making it ideal for:
 - Premium residential projects
 - Commercial buildings targeting energy certification

NON-THERMAL SYSTEM

A cost-effective solution suitable for:

- Moderate climate zones
- Projects where thermal insulation is not critical

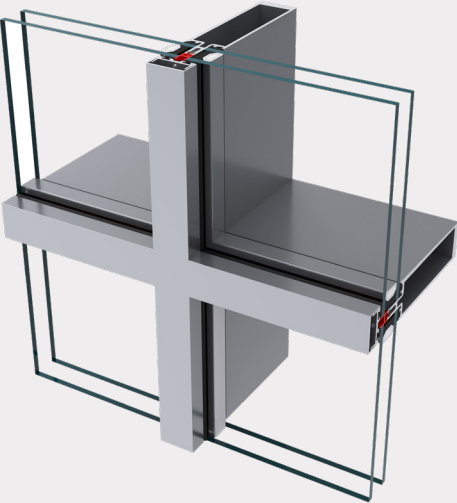

The
CORE
of every skyline.

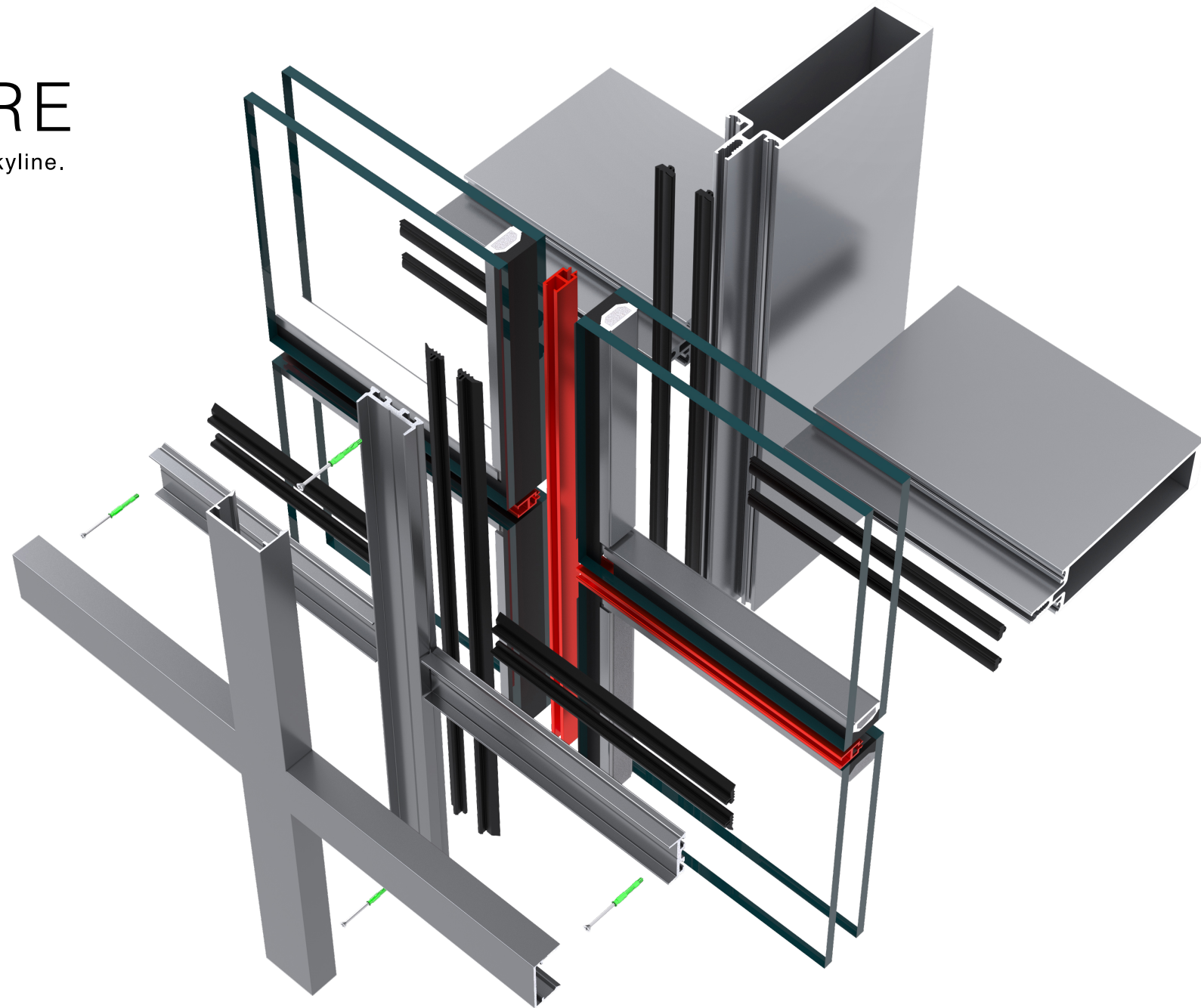

 GCW 3500

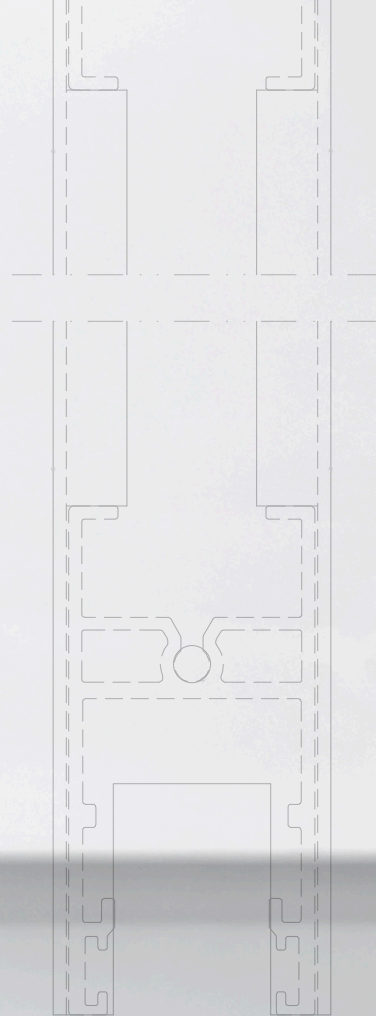

PRECISION

Precision perfected in every profile.

Purpose-built parts aligned to the millimetre.

Performance driven by engineered accuracy.

Perfection that shows in every slide and seal.

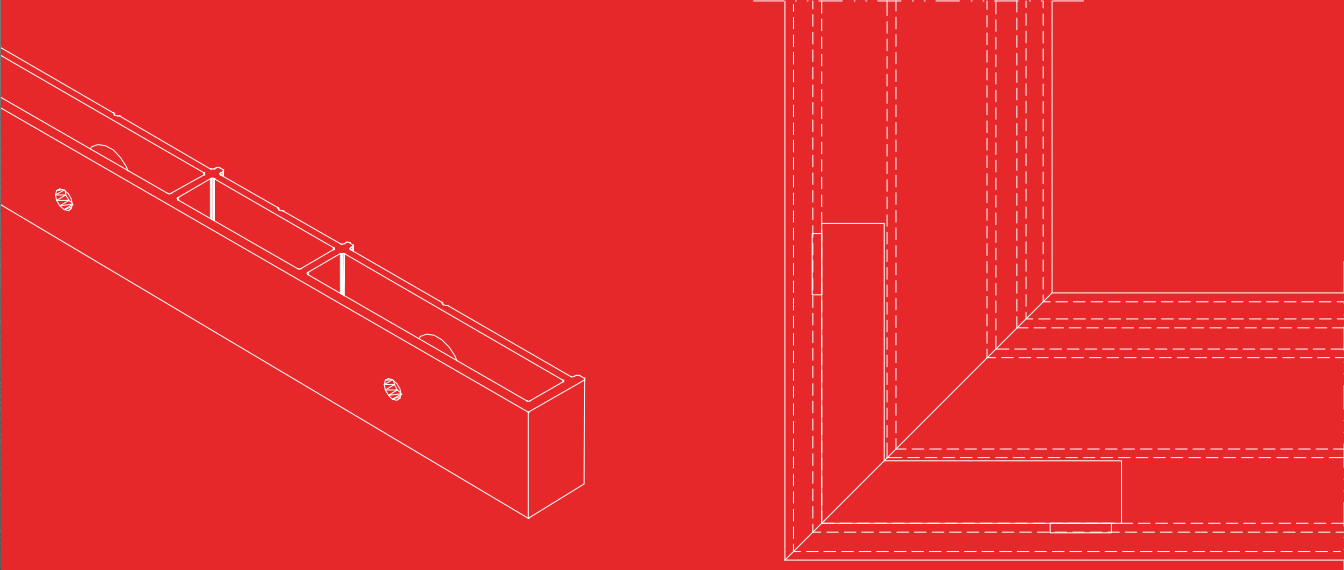
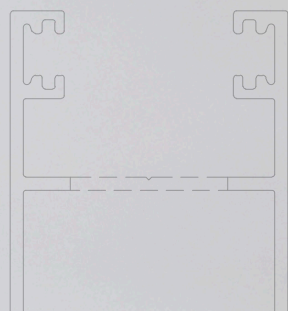

STRENGTH

Strength that stands firm through time.

Structures built to support, secure, and sustain.

Solid engineering that resists pressure and weather.

Stability you can feel in every frame.

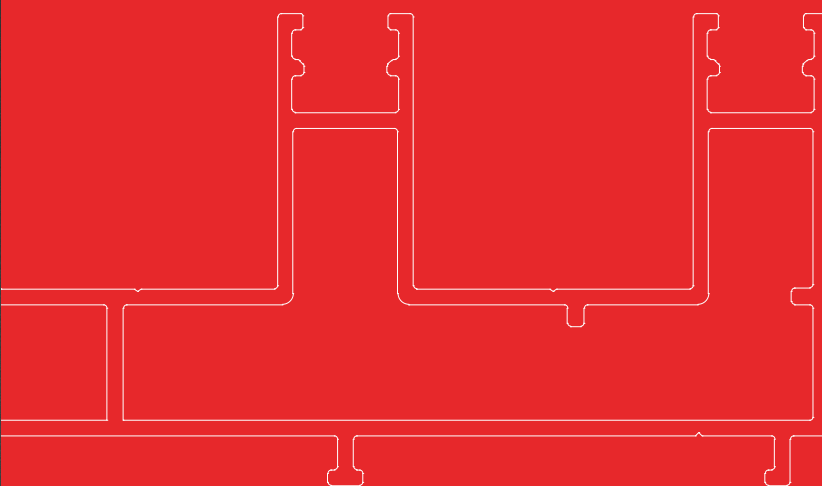

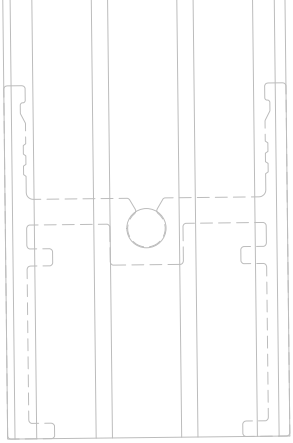

DESIGN

Design that defines modern living.

Details crafted for elegance and ease.

Distinct lines that elevate every space.

Design where beauty meets function.

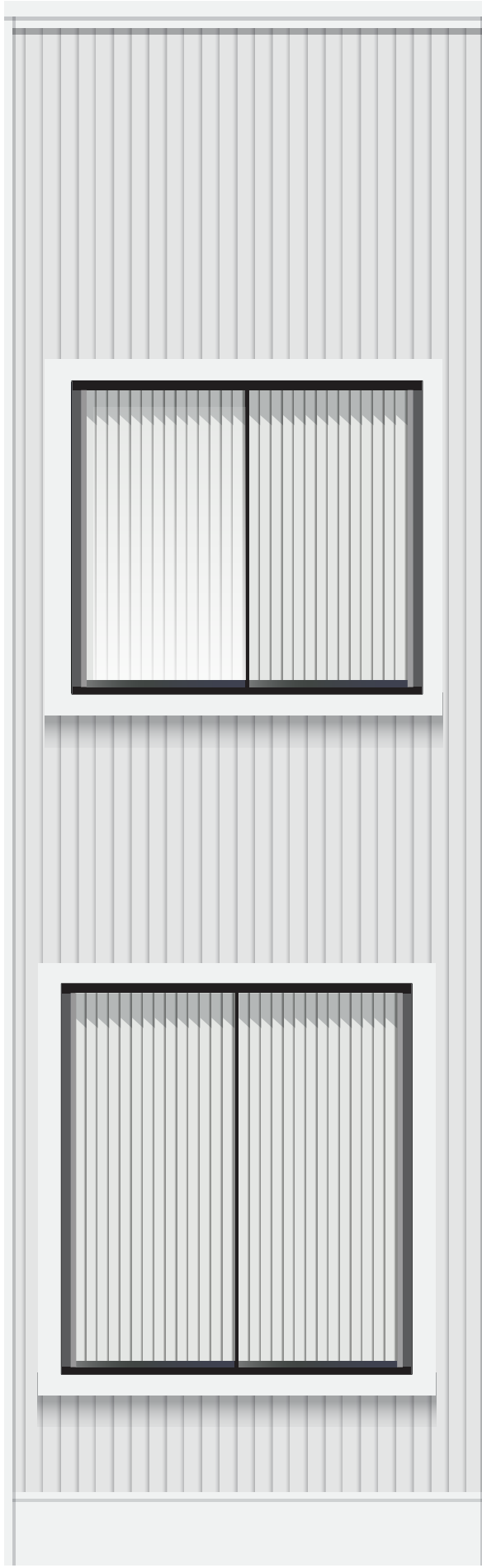
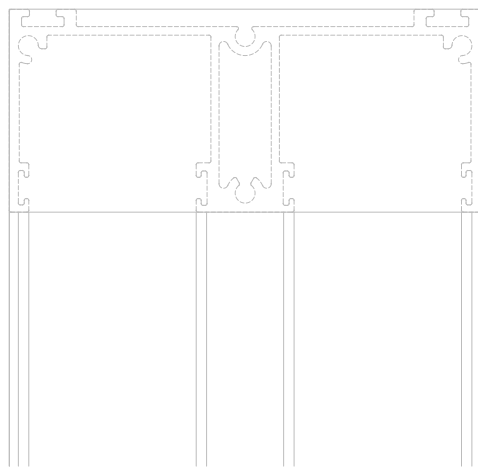

GRAFET = Precision+Strength+Design.

 **GREFET**

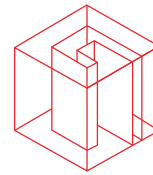

THE SCIENCE
OF SYSTEM
WINDOWS

www.grefet.com