

GREFET

Registered Office:
Archimedesstraat 58, 8400 Oostende, Belgium.

Manufacturing Ubit:
912/46, Poisar Venus CHS LTD, Kandivali East, Mumbai-400001

Email:
Email: info@grefet.com

Contact:
+91 880061 6009

Gurgaon | Panipat | Lucknow | Dehradun | Chandigarh

Disclaimer: Grefet Systems Private Limited (ASPL) reserves the right to change without notice, Specifications, Design, Shape, Size and any other criteria related to the systems mentioned in the catalogue and also to discontinue Systems and/or replace any part or accessory of any System. ASPL also reserves the right to source and indent Profiles, Hardware and Accessories from any company it seems fit.

GREFET

Look at the world
with a **WIDE ANGLE**
perspective

SLIMLINE SLIDING SYSTEM

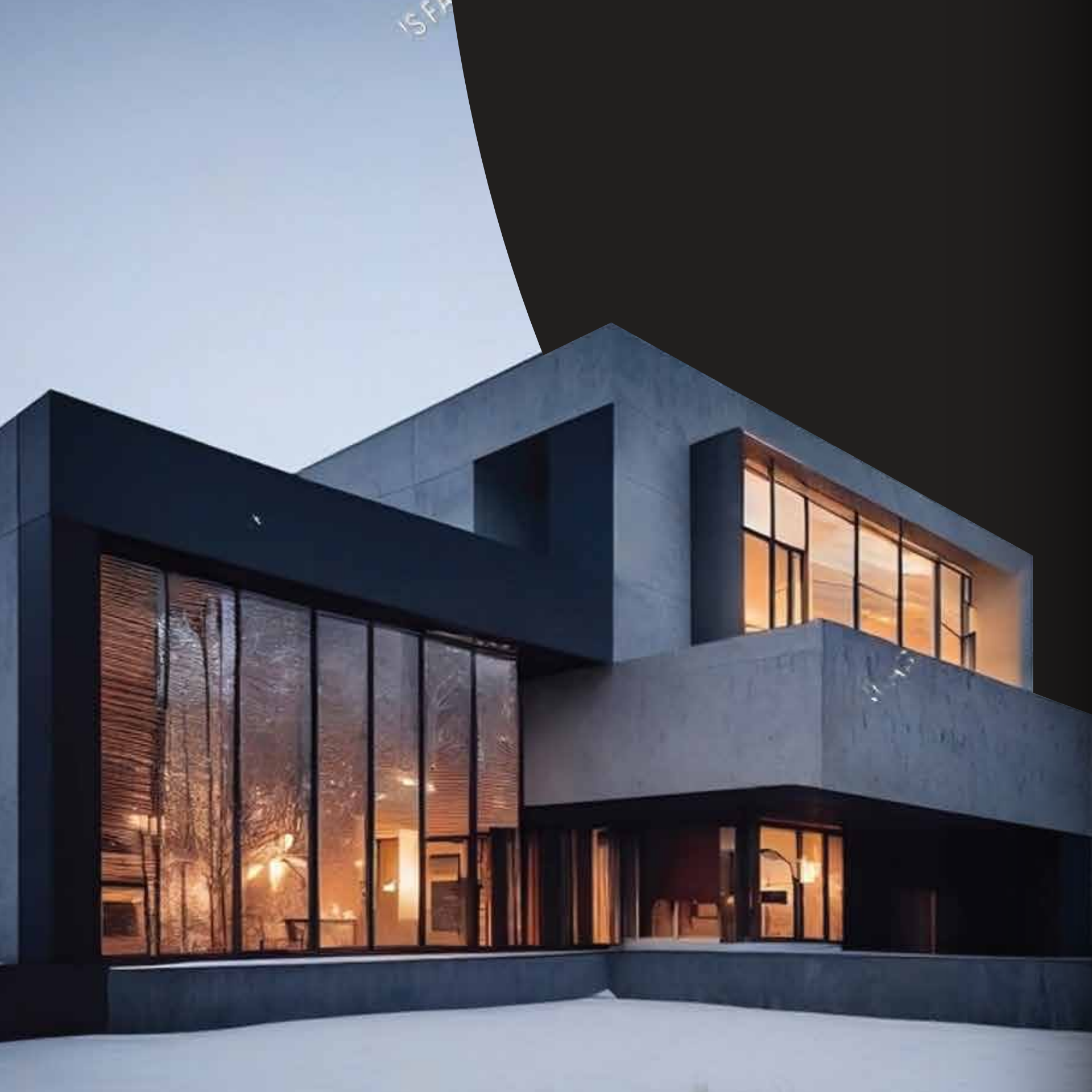

mission

To make Perfect Windows as the First Choice of all our Clients by Effective Services. To be Customer-centric forever capable of supplying Superior Quality Designer for Aluminum Windows and Doors at an incredible price. To target your needs precisely based on the specifications and utility. To get established as a Premier Hub in the Domain of System Windows.

vision

Our Vision is to relentlessly dedicate our services in the fabrications world revolutionizing the concept of Timeless Pieces that never go out of style. Also, we envisage to grow by making our services the first and most preferred choice of our clients to reconfigure and elevate their lifestyle.

core values



Satisfaction

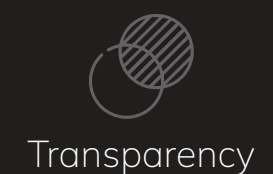

Transparency



Integrity



Excellence



Diversity



Innovation

GRAFET

TRULY AWESOME to behold

We would like to introduce GREFET as a unity between your dream home, its living and working environment, European system supplier brand for Aluminum doors and windows. We're dedicated to provide you the very best of our services, with a focus on reliability and trust. Our commitment to innovation, aesthetics, and functionality has led us to craft aluminum systems that redefine the way you perceive spaces.



Design beyond
imagination



Comfort without
compromise



Premium quality
Guaranteed

450+

Shades and
Finishes

RAL

Colour
Selection

system ALUMINIUM

As an essential part of building, windows should open up the view and bring as much light Air and View to your home. GREFET® system aluminium windows open up the multi designs options from Gladik Plus Sliding to Tilt & Turn Options. GREFET® Windows comes in morden profile and sleek interlock options suitable for superior insulating capabilities create perfect designs. Beautiful windows with modern technology from GREFET® always enhance the inner and outer appearance to your house.



Sliding
Doors



Sliding
Windows

WHY aluminium?

The most important reasons to consider aluminium for your next project



Lifetime



Colours



Versatility



Safety



Investment



Insulation



Design



Sustainability

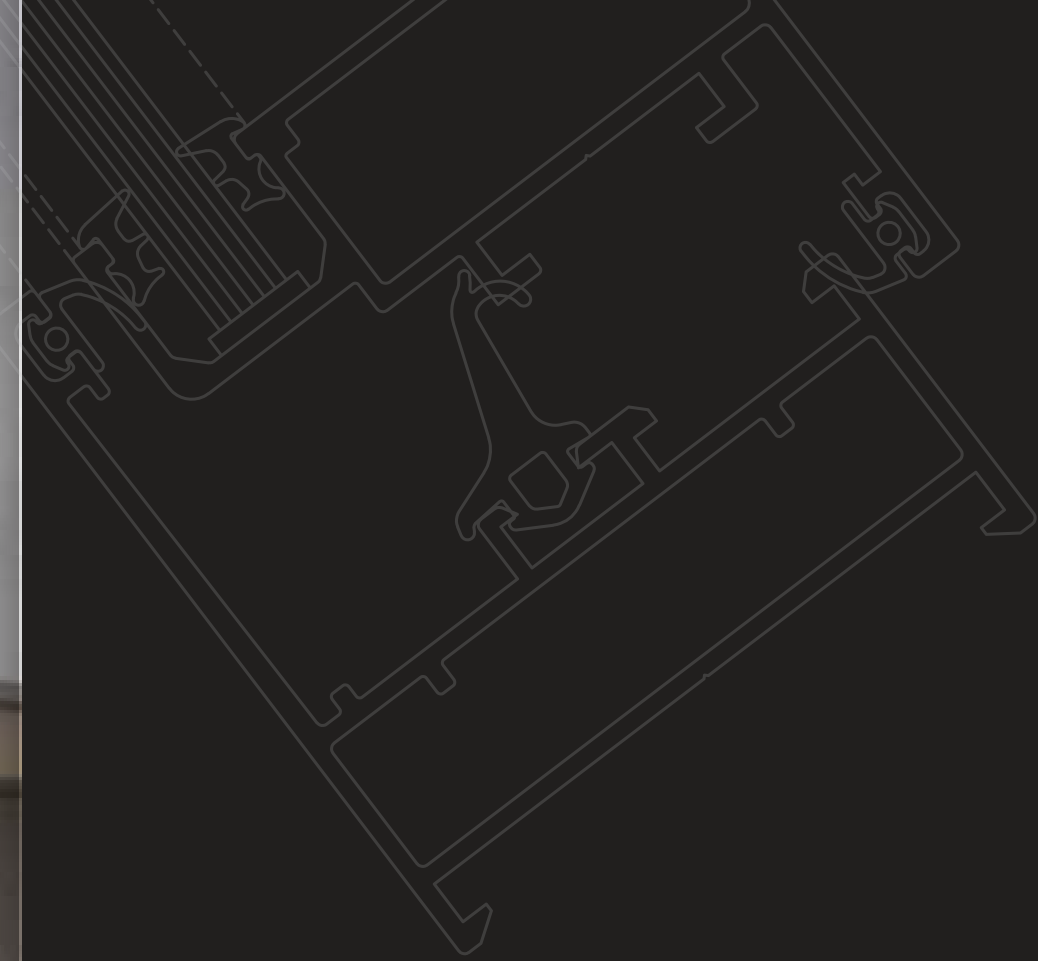

EPIC-19

SLIM SERIES

REFET

EPIC-19

SLIM SERIES

EPIC 19 is a groundbreaking exterior opening system with unmatched thermal and acoustic performance (up to Minergie-P and Passivhaus), ideal for very cold climates.

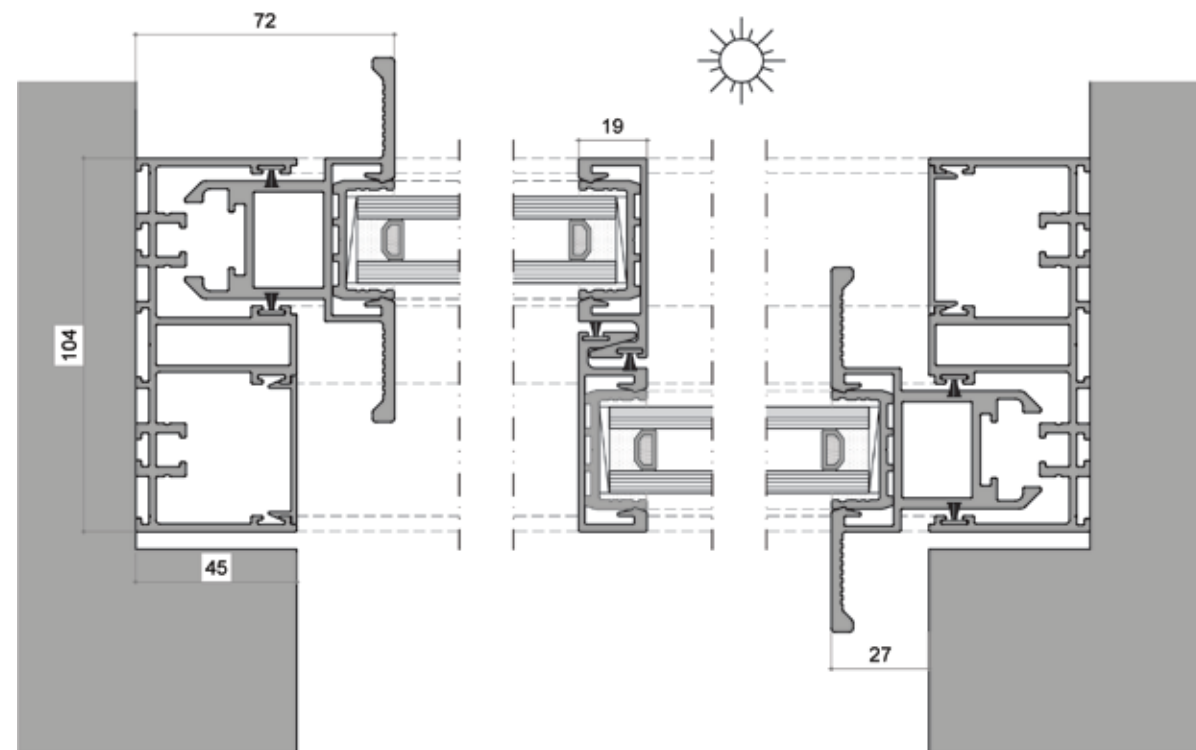
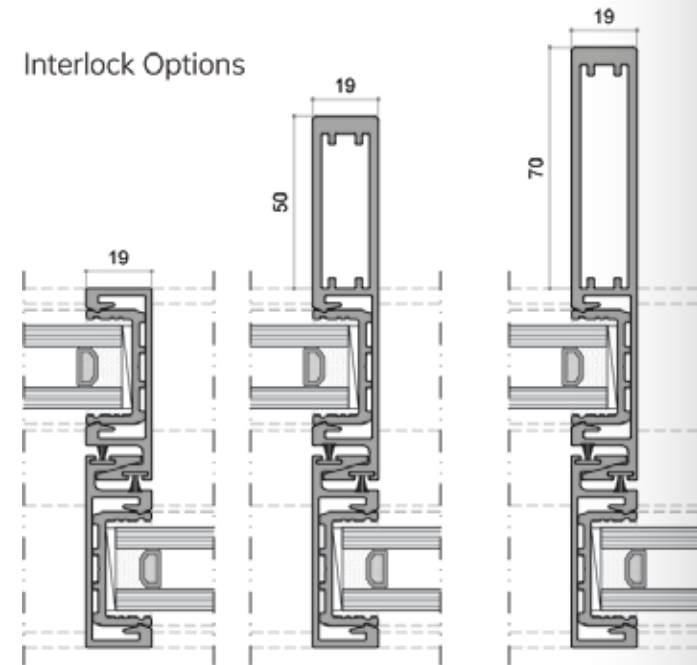

LIMITATIONS

Glass
Min 12mm Max 24mm

Track Options
2 Track | 3 Track

Sash Size ← x :
3600 X 1800mm

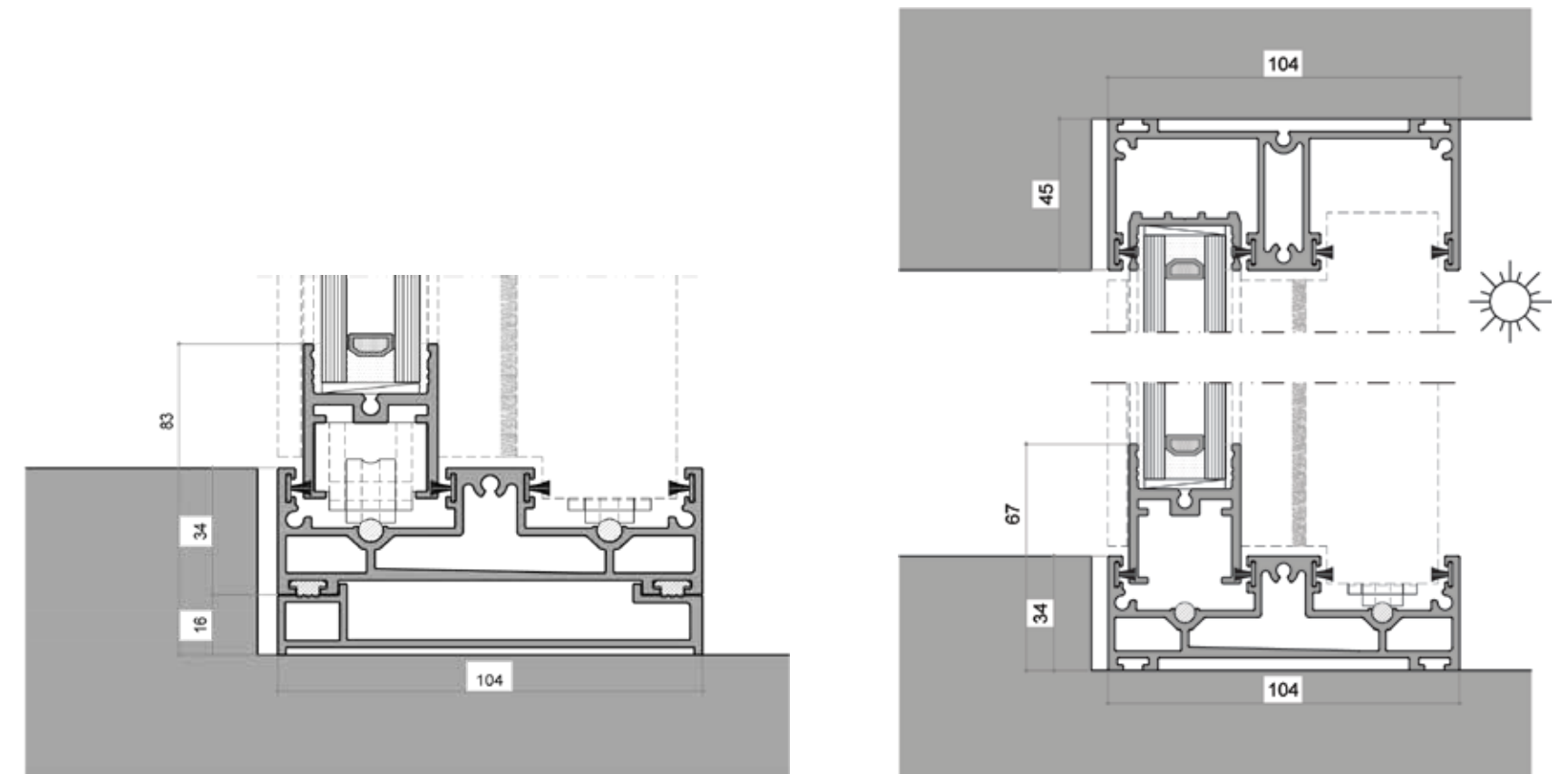
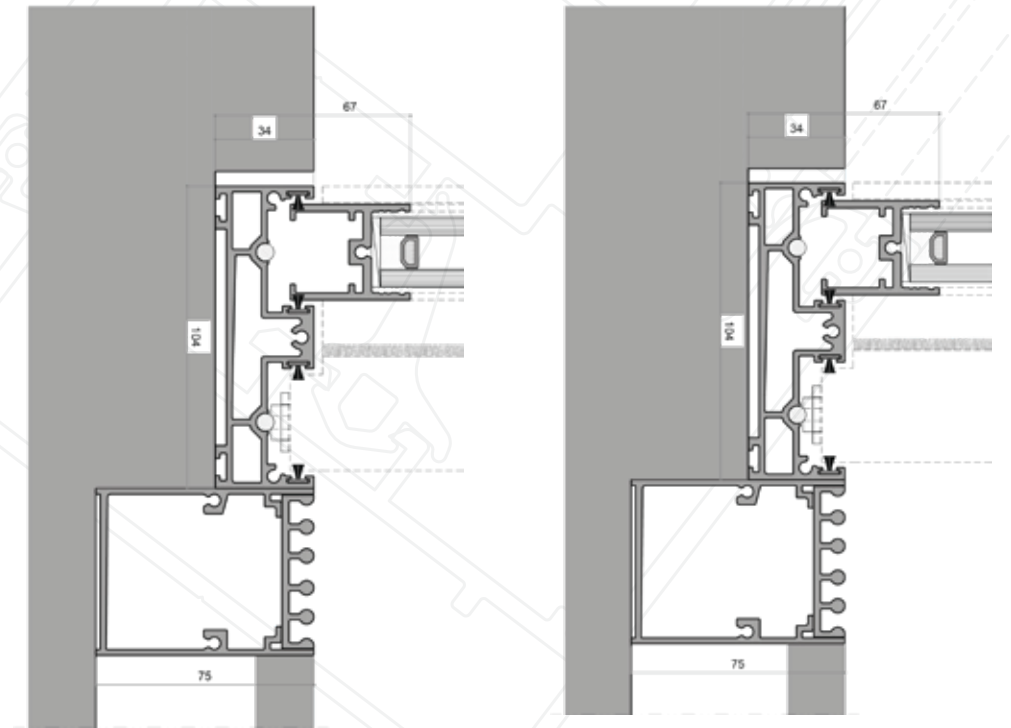



PERFORMANCE



Wind load resistance
Class 3/m2k



Sound Reduction
30DB Class 2



Water Tightness
Class 9A



Thermal Insulation
Up to 2.80 W /m2k

PRODUCT OVERVIEW



Minimal interlock
19mm



Frame concealed
/ Zero threshold



Corner opening
solution



Can be
automated



Multipoint locking
with key option



Additional drainage
chamber





TECHNICAL CHARACTERISTIC

Frame Depth

Mechanism 34mm

Sash Weight

300 kg.

Central Interlock

19 mm

Glazing

12MM - 24MM

Mechanism

Multi Locking Mechanism



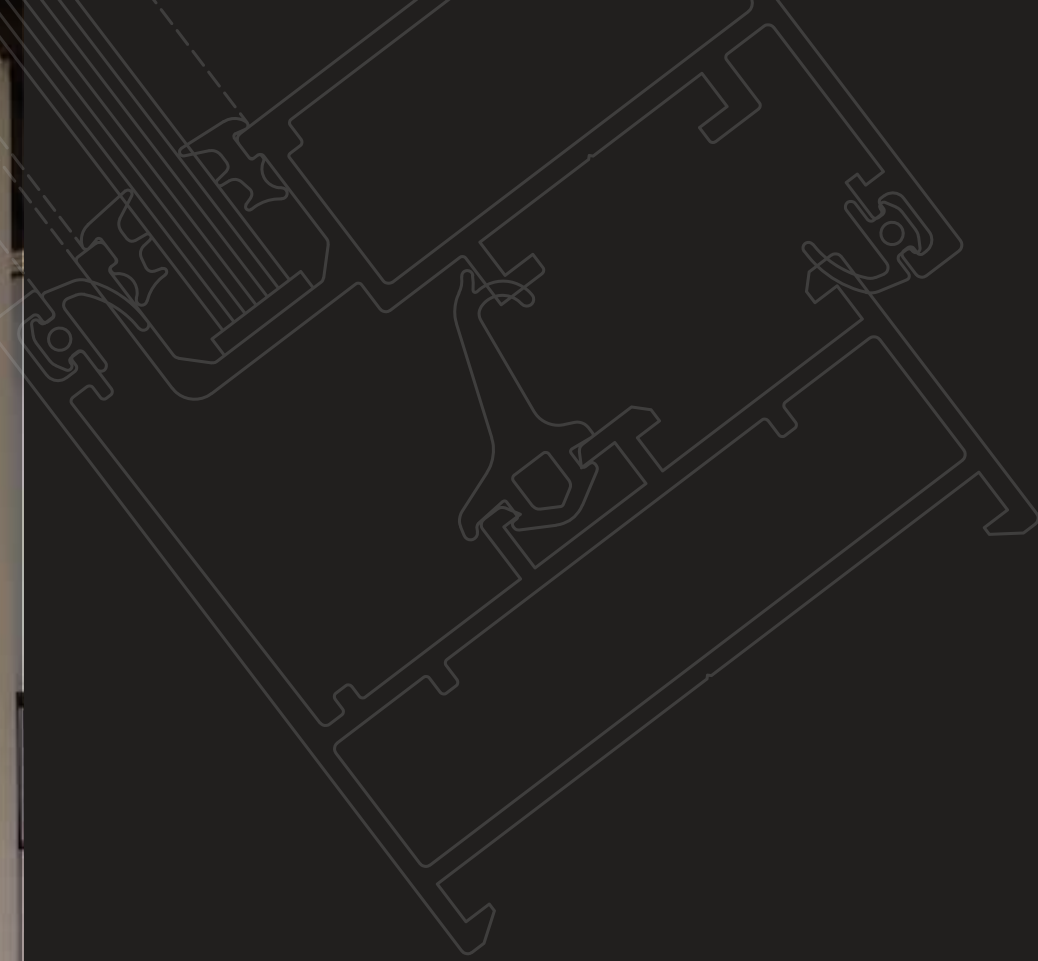

MERIDIAN-32

SLIDING SERIES

REFET

MERIDIAN-32

SLIDING SERIES

MERIDIAN 32 is a groundbreaking exterior opening system with unmatched thermal and acoustic performance (up to Minergie-P and Passivhaus), ideal for very cold climates.

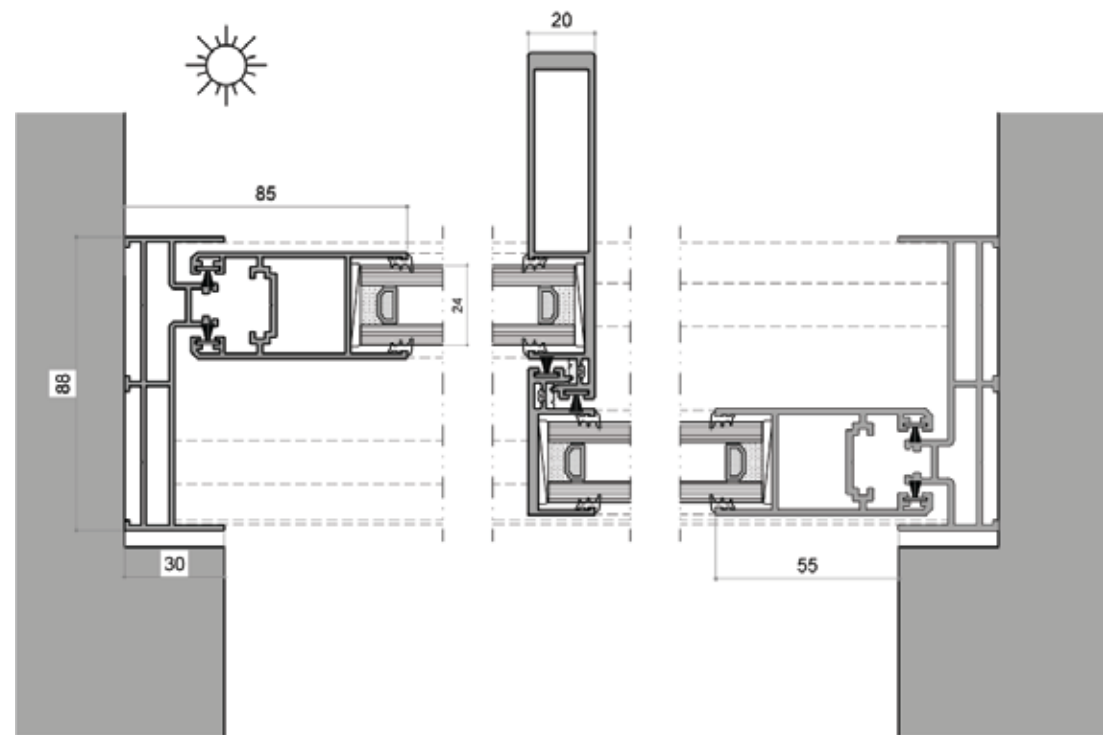

LIMITATIONS

Glass
Min 6mm Max 24mm

Track Options
2 Track | 3 Track

Sash Size ← x :
1200 X 2500mm

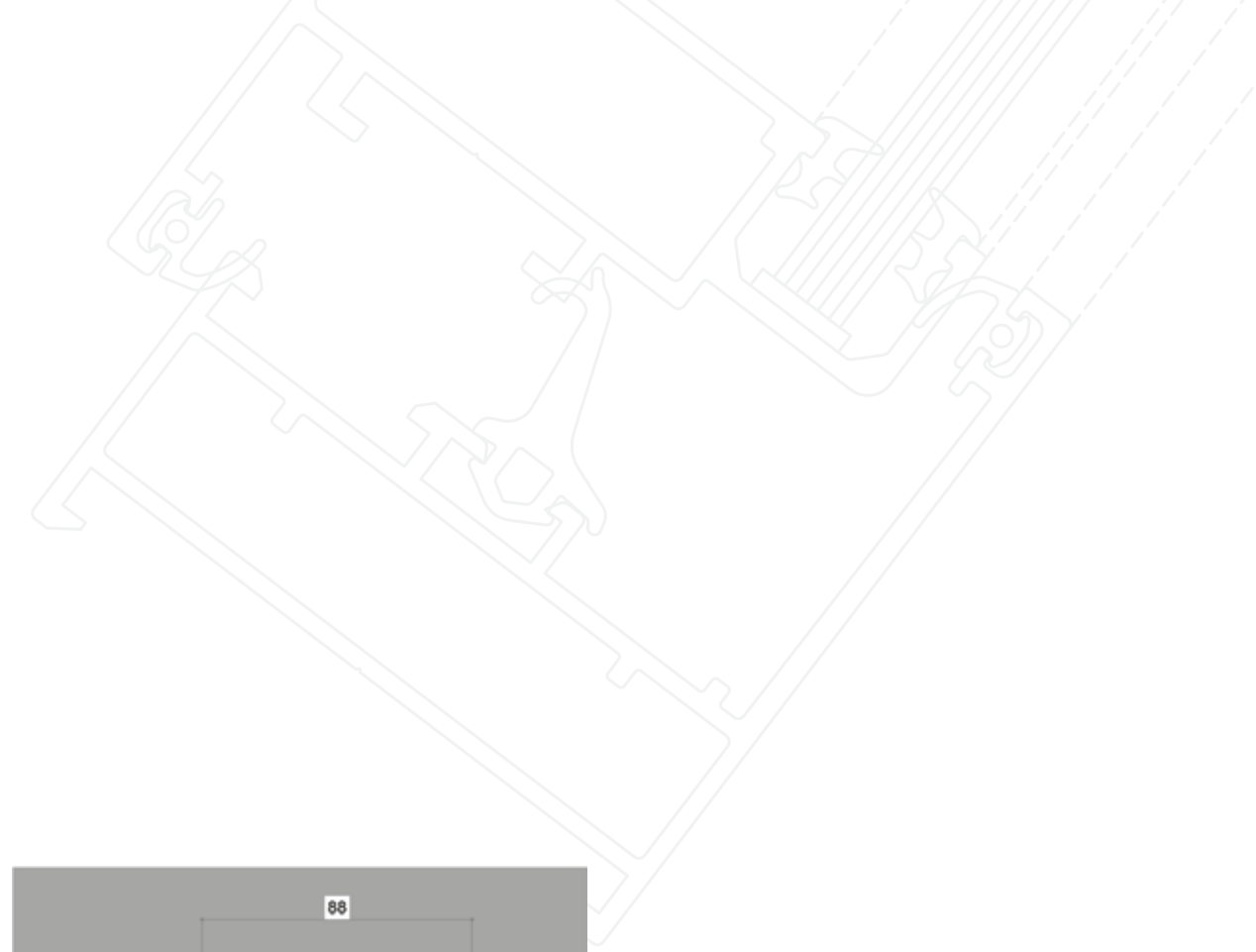
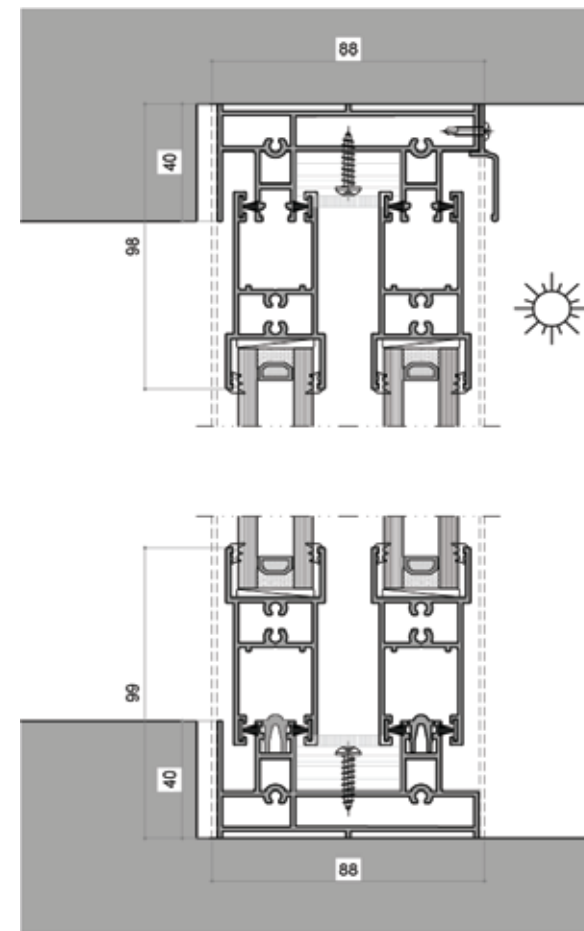

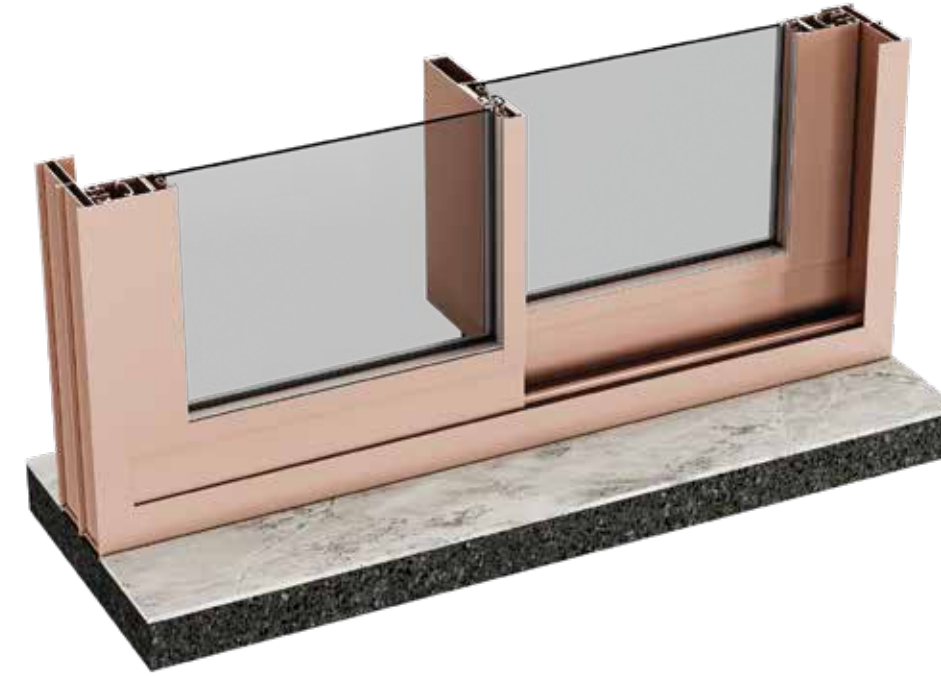

PERFORMANCE



Wind load resistance
Class 5



Sound Reduction
30DB Class 2



Water Tightness
Class E900

PRODUCT OVERVIEW



Regular series with 20mm interlock



Single or Multi point locking



Non insulated system



Up to 8ft height



Sliding mesh option





TECHNICAL CHARACTERISTIC

Frame Depth
30/40 mm

Sash Weight
160 kg.

Central Interlock
20 mm

Glazing
Upto 24mm

Mechanism
Multi Locking Mechanism

Sealing Method
Primetrical fin brushes and EPDM



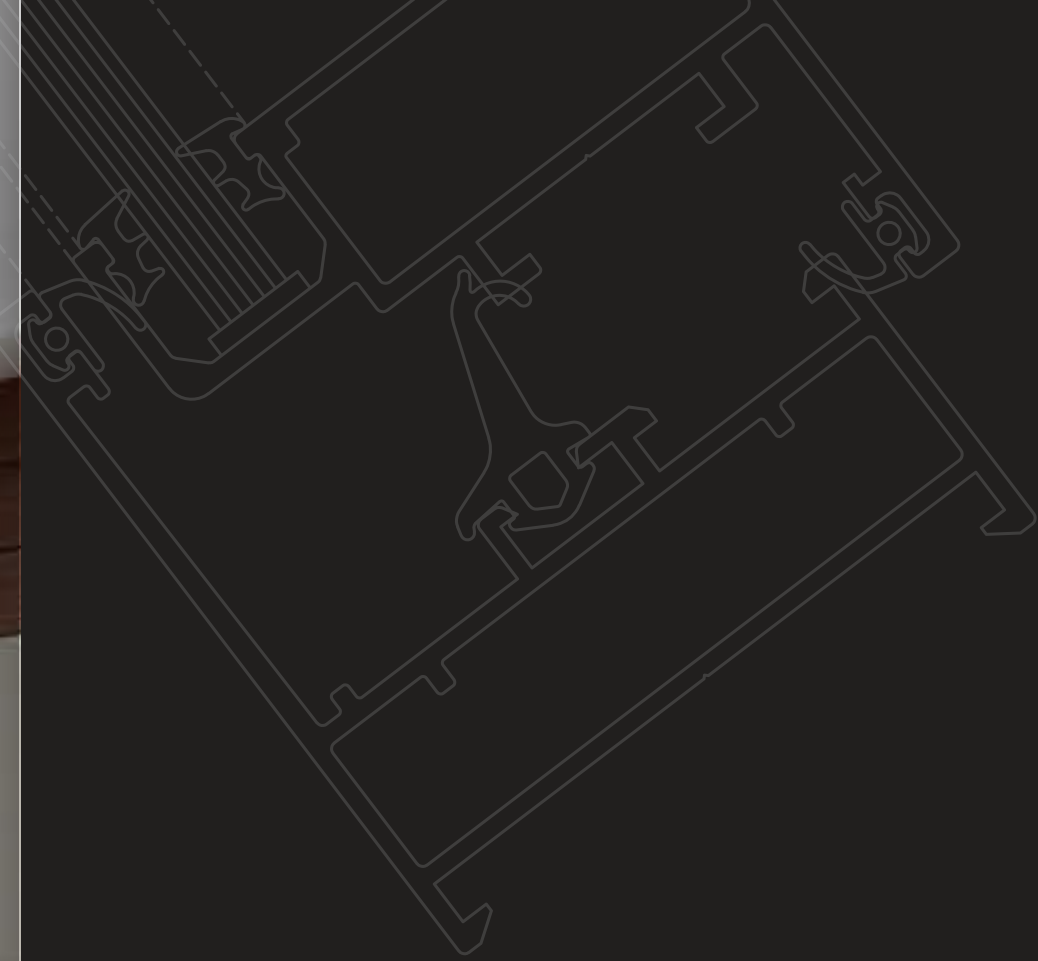

MERIDIAN-36

SLIDING SERIES

REFET

MERIDIAN-36

SLIDING SERIES

MERIDIAN 36 is a groundbreaking exterior opening system with unmatched thermal and acoustic performance (up to Minergie-P and Passivhaus), ideal for very cold climates.

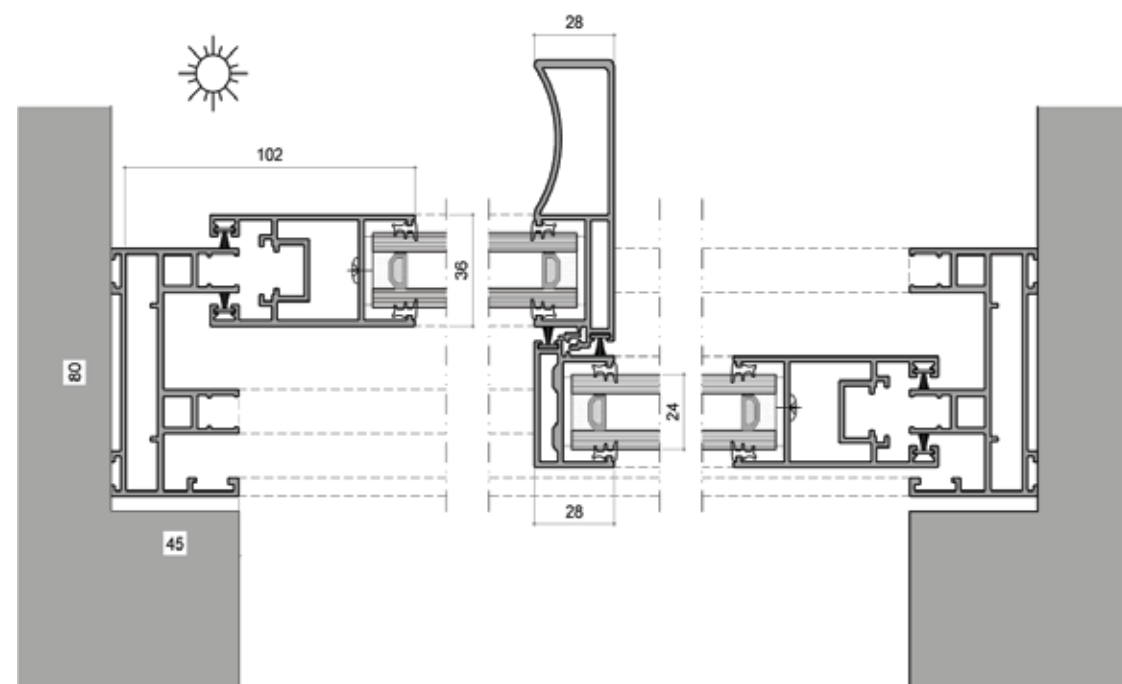

LIMITATIONS

Glass

Min 6mm Max 27mm

Track Options

2 Track | 3 Track

Sash Size ← x :

3200 X 1600mm

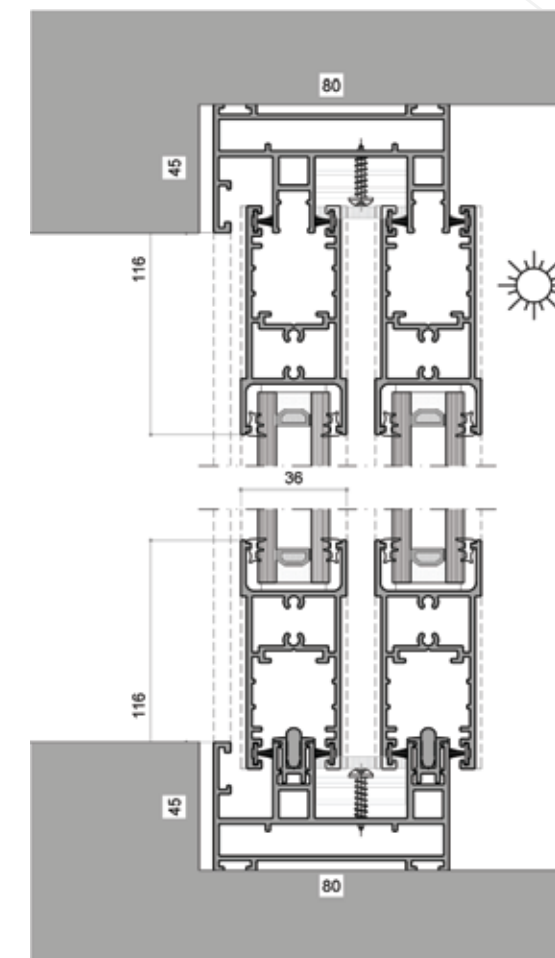

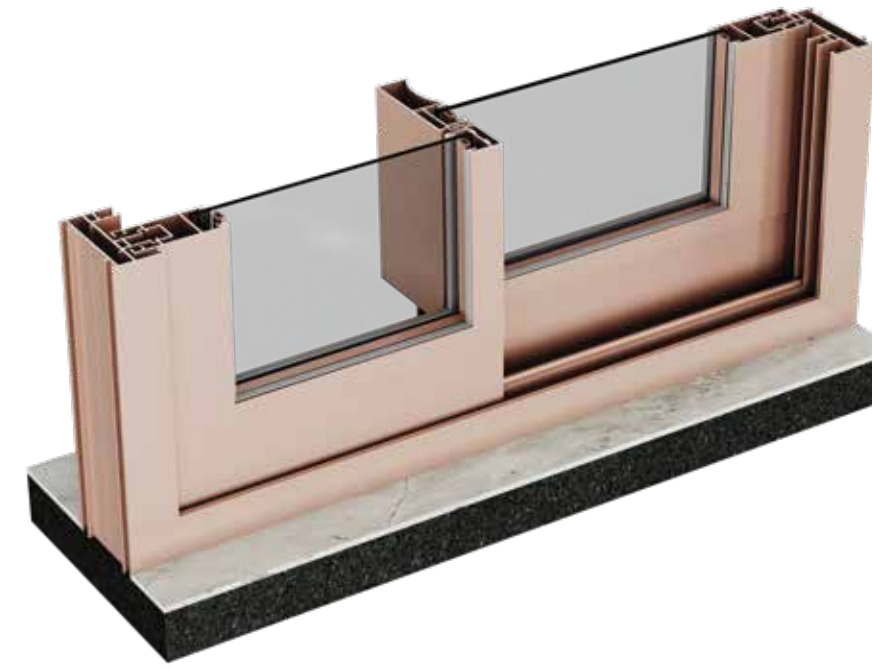

PERFORMANCE



Wind load resistance
Class 3



Sound Reduction
30DB Class 2



Water Tightness
Class 9A



Thermal Insulation
Up to 2.80 W /m²k

PRODUCT OVERVIEW



Premium series with
28mm interlock



Multi point
locking



Non insulated
system



Up to 10 ft
height



Sliding mesh
option





TECHNICAL CHARACTERISTIC

Frame Depth

Mechanism 45mm

Sash Weight

200 kg.

Central Interlock

28mm

Glazing

6MM - 27MM

Mechanism

Multi Locking Mechanism

Sealing Method

Primetrical fin brushes and EPDM



The images shown are for illustration and visualization purposes only and may not be an exact representation of the product.

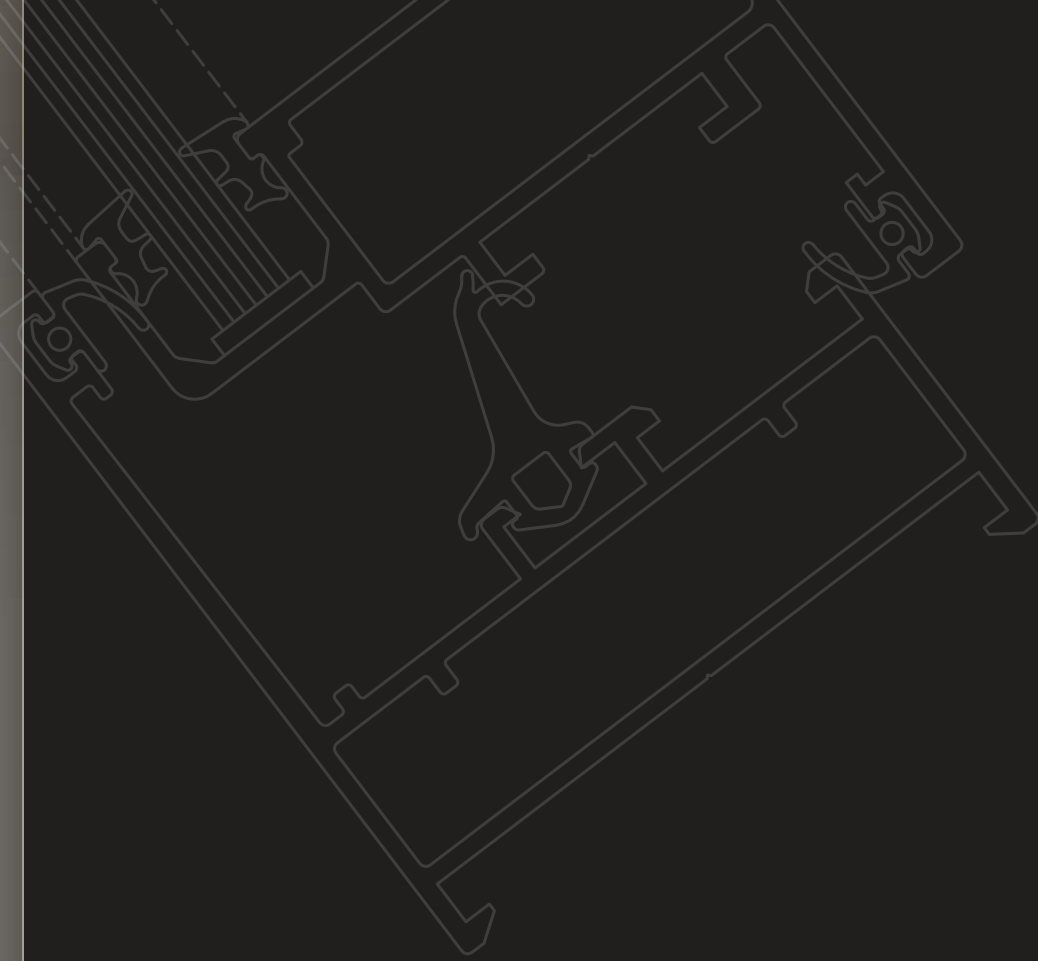

CROSET-50

SLIDING SERIES

GREFET

CROSET-50



SLIDING SERIES

CROSET 50 is a groundbreaking exterior opening system with unmatched thermal and acoustic performance (up to Minergie-P and Passivhaus), ideal for very cold climates.

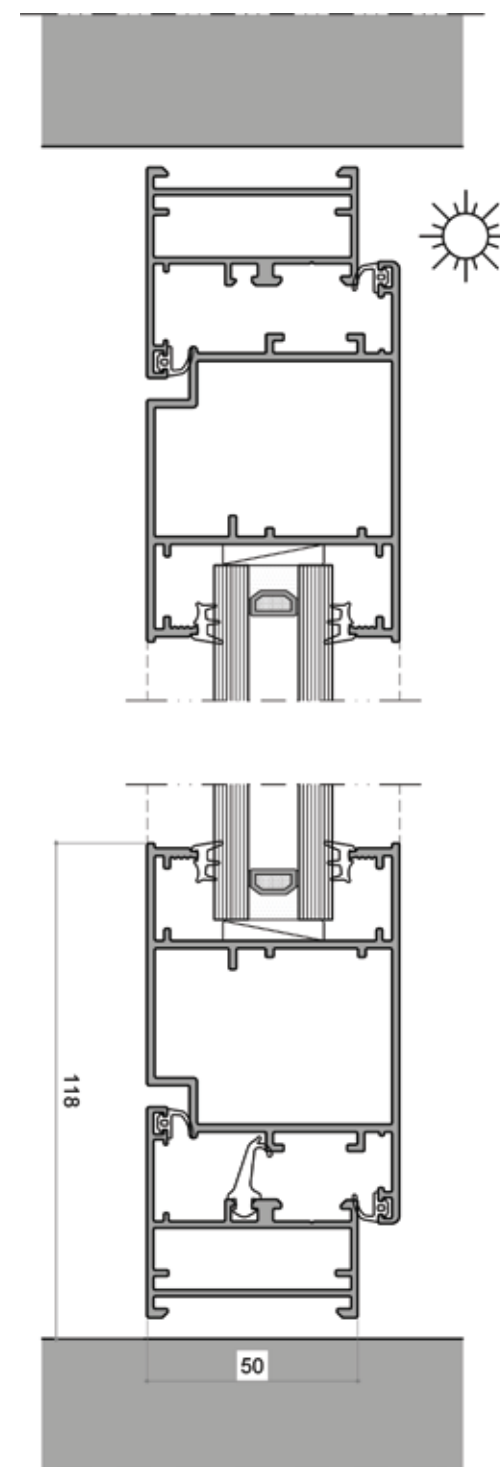
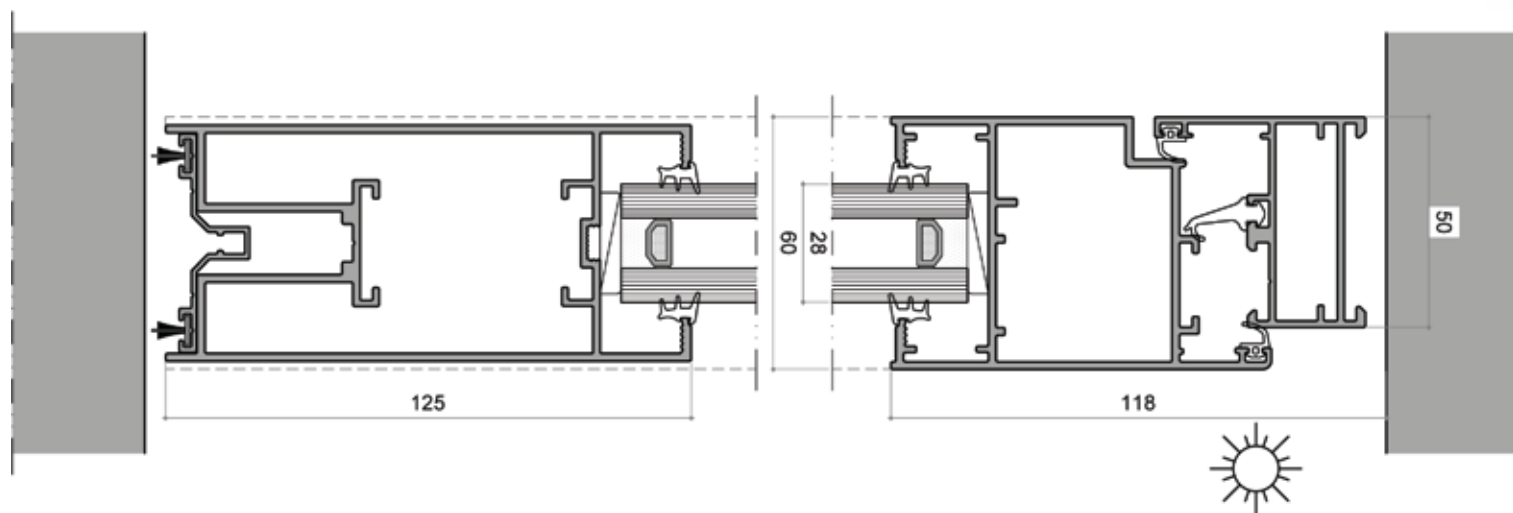

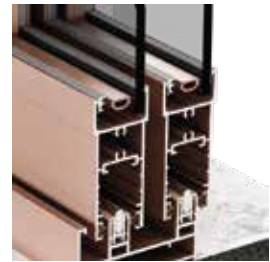
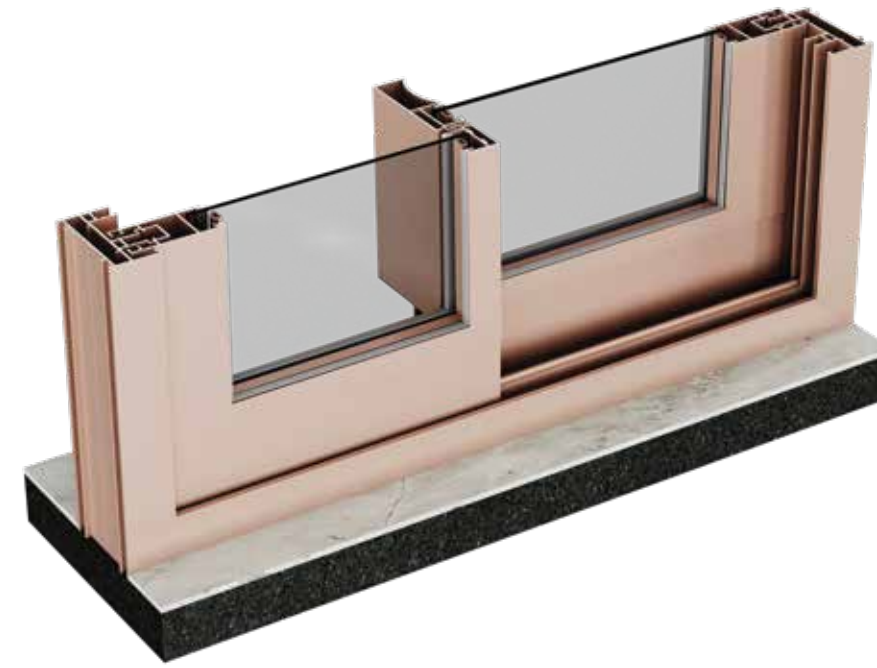

PERFORMANCE



Air Permeability
class 4



Wind load resistance
Class C5



Water Tightness
Class 9A



TECHNICAL CHARACTERISTIC

Frame Depth
50mm

Sash Weight
200 kg.

Sash Size
125mm

Glazing
UPTO 30MM

Insulation
39 db

Sash Size ↔ x ↓
4 feet X 12 feet



The images shown are for illustration and visualization purposes only and may not be an exact representation of the product.

TRACK POSSIBILITIES

→ Left to Right ← Right to Left + Fixed

2 TRACK

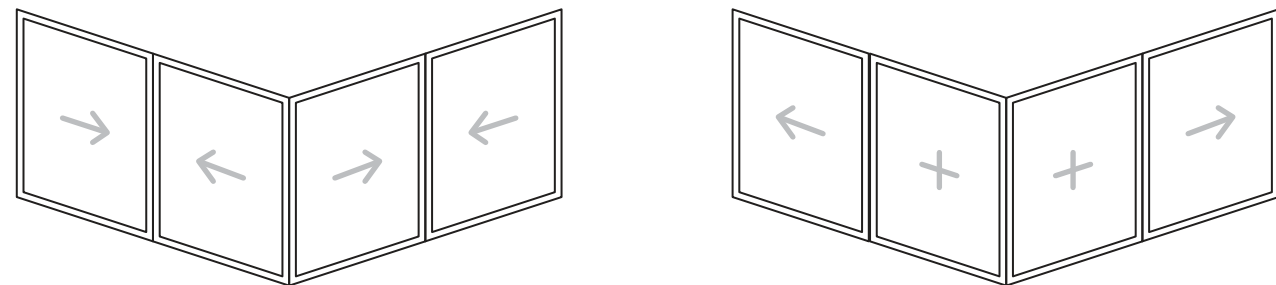
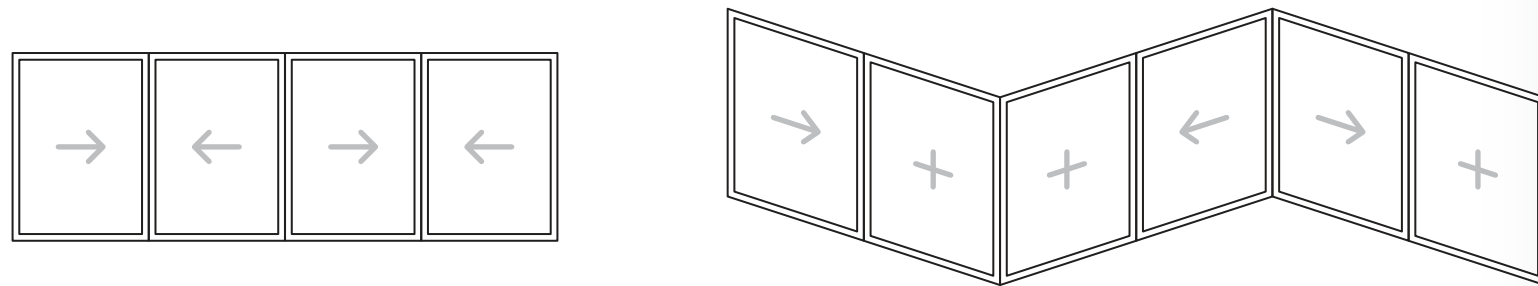
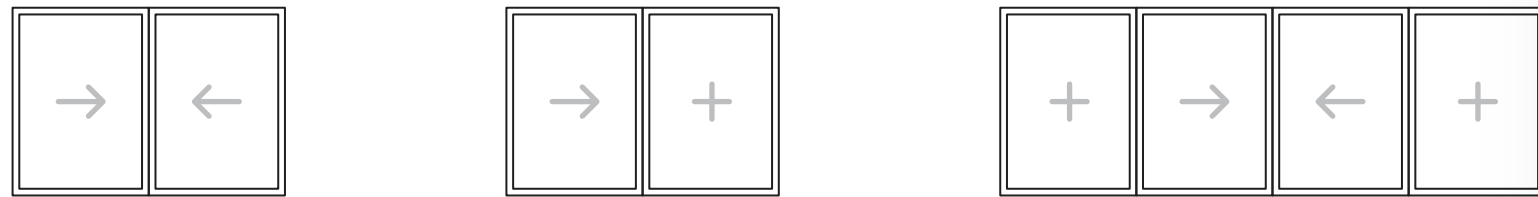

3 TRACK

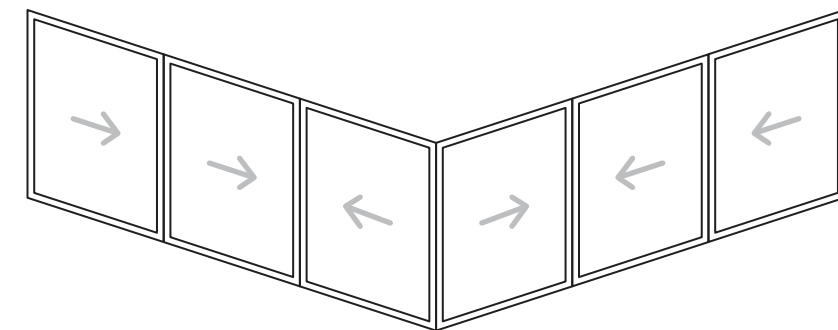
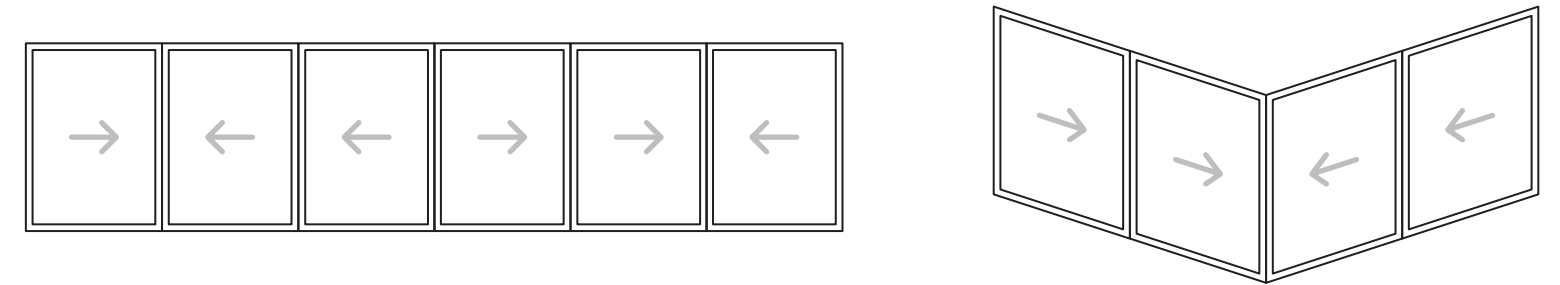
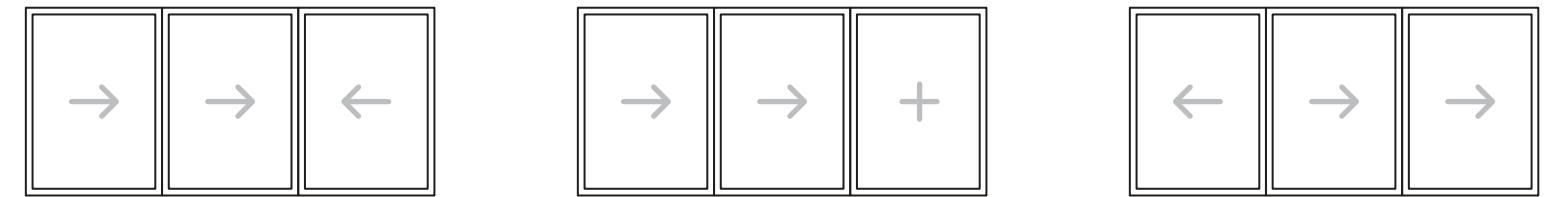

GREFET

LUXURIOUS SYSTEMS,
crafted for
SEAMLESS LIVING

